

LIFT MACHINE ROOM ROOF PLAN
SCALE- 1:100

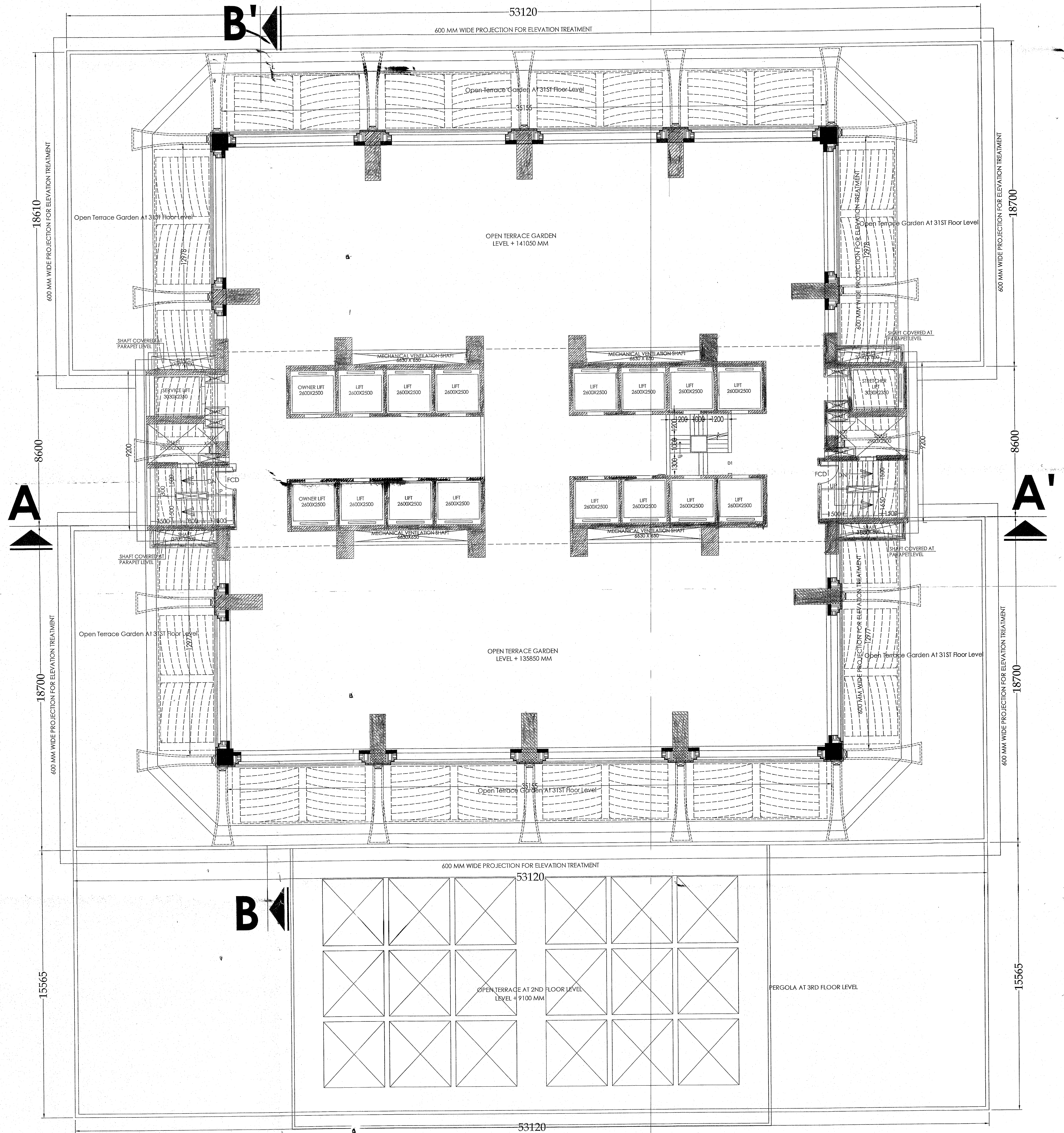

ROOF PLAN
SCALE- 1:100

I HAVE CHECKED THE STRUCTURAL CALCULATIONS MADE BY SRI CHANDI PROSAD KHANRA, E.S.E. 1/2. THE CALCULATION IS FOUND CORRECT AND STRUCTURE IS SAFE AND STABLE IN ALL RESPECT.

Mita Saha
MITA SAHA
M.I.E., M.E. (Struct), C.E.
Structural Engineers 22/23 (KMC)
AG-89, Sec-II, Salt Lake,
Mob-9831888112

DECLARATION OF REVIEWER:

I HAVE CHECKED THE EXISTING FOUNDATION AND SUPERSTRUCTURE OF THE BUILDING AND CERTIFIED THAT THE BUILDING IS SAFE AND STABLE IN ALL RESPECT AND CAPABLE OF TAKING ADDITIONAL LOAD FOR THE PROPOSED CONSTRUCTION.

Dr. R. S. JANGID
Professor
Department of Civil Engineering
I.I.T. Bombay, Powai, Mumbai-76

DR. R.S. JANGID
PROFESSOR
DEPARTMENT OF CIVIL ENGINEERING
I.I.T. BOMBAY, POWAI, MUMBAI-76

Arif Ahmed Khan
Arif Ahmed Khan
Pervaz Ahmed Khan
Sh. Yasmeen Hussain
Javed Ahmed Khan
Sh. Shabir Ahmad
Sh. Shamsul Akhtar
S. K. Sanyal
Chartered Accountant
Constituted Attorney

SIG. OF OWNER

THE STRUCTURAL DESIGNS DRAWINGS OF BOTH FOUNDATION AND SUPERSTRUCTURE HAS BEEN MADE, CONSIDERING ALL POSSIBLE LOADS INCLUDING THE SEISMIC LOAD AS PER THE NATIONAL BUILDING CODE OF INDIA AND CERTIFIED THAT IT IS SAFE AND STABLE IN ALL RESPECTS. THE ABOVE CALCULATION HAVE BEEN MADE BASED ON SOIL TEST REPORT.

Dr. Sujit Kumar Bose
DR. SUJIT KUMAR BOSE
M.D., M.C.E. (SOL), B.C.E. (H.M.E.)
MIS. MTR
Registered Geotechnical
Engineer (I) under KMF
Licence No: GT-12

Chandi Prosad Khanra
CHANDI PROSAD KHANRA
BE (CIVIL), ME (STRUCT), ESE-12

SIGNATURE OF GEO. TECH. ENGR.:

SIG. OF STRUCTURAL ENGR.

CERTIFIED THAT THE BUILDING PLAN HAS BEEN DRAWN UP AS PER PROVISION OF K.M.C. BUILDING RULES 2009 AS AMENDED FROM TIME TO TIME AND THAT THE SITE CONDITIONS INCLUDING THE WIDTH OF THE ABUTTING ROAD BEING 67.5 MTS. CONFORM WITH PLAN AND THAT IT IS A BUILDING SITE AND NOT A TANK OR FILLED UP TANK.

Harsh Sanon
HARSH SANON
COUNCIL OF ARCHITECTURE
REGISTRATION NO. CA/90/13556
Signature of Architect:

PROJECT: PLAN FOR PROPOSED ADDITIONAL 4 FLOORS OVER SANCTIONED G+27 STORED COMMERCIAL BUILDING AND PARTIAL EXTENSION OF 5TH FLOOR OF 8 STORED MLP BLOCK UNDER RULE 26 (2) & (3) READ WITH RULE 99A (1-C) OF KMC BUILDING RULE 2009. PREVIOUSLY BUILDING PLAN WAS SANCTIONED VIDE B.P. NO. -2011070209, DATED-12.12.2011, AND SUBSEQUENTLY REVALIDATE FOR FIVE YEARS W.E.F. 13.12.2018 AND REGULARIZED PLAN UNDER RULE 26 (2) & (3) OF KMC BUILDING RULES 2009. VIDE M.B.C MEETING NO-594, ITEM NO: 12319-20, DATED: 07.11.2019, AT PREMISES NO 10, EAST TOPSIA ROAD, WARD NO-66, BOROUGH NO-VII, KOLKATA - 700 046. UNDER KOLKATA MUNICIPAL CORPORATION.

JOB NO: 670	TITLE: ROOF PLAN AND LIFT MACHINE ROOM ROOF PLAN WITH SOLAR PANEL
DRG. NO: CA/KMC-07	

REVISION NO: 0	SCALE: As Mentioned	DEALT BY: Moumita	CHECKED BY: Suvadip	DATE: 03.09.2020
-------------------	------------------------	----------------------	------------------------	---------------------

S&S SANON SEN & ASSOCIATES (P) LTD.
ARCHITECTS, ENGINEERS & INTERIOR DESIGNERS
5, RUSSEL STREET, KOLKATA-700 071
PHONE:91-33-22264579,22172505,22294402
FAX:2226 6917 E-MAIL:sanonsen@snl.com

KMC