

LOCATION DETAILS OF THE PROJECT :-

SITE PLAN OF G+IV STOREYED RESIDENTIAL BUILDING PLAN OF PHARMA INDIA PVT.LTD.

13A ST. GEORGE TERRACE IN DAG NO.- 1822,1752,1753, 1754,1824. KHAITAN NO.- 631,46,101,650,57,46. J.L. NO.-92 MOUZA- RASPUNJA, TOUZI NO.- 351, WITHIN RASPUNJA GRAMPANCHAYET, P.S.- BISHNUPUR, UNDER SOUTH 24 PGS, ZILLA PARISHAD.

LAND AREA OF PHASE (I) :- 4693.690 SQ.M.

LAND AREA OF PHASE (II) :- 2399.240 SQ.M.



CO-ORDINATES OF BOUNDARY LINE OF PHASE (I) :-

	LATITUDE	LONGITUDE
1.	22° 26' 23.9" N	88° 16' 45.9" E
2.	22° 26' 25.9" N	88° 16' 47.8" E
3.	22° 26' 23" N	88° 16' 48.2" E
4.	22° 26' 25.2" N	88° 16' 49.4" E

CO-ORDINATES OF BOUNDARY LINE OF PHASE (II):-

	LATITUDE	LONGITUDE
1.	22° 26' 24" N	88° 16' 48.8" E
2.	22° 26' 25.2" N	88° 16' 49.4" E
3.	22° 26' 23" N	88° 16' 50.8" E
4.	22° 26' 24.4" N	88° 16' 51.4" E

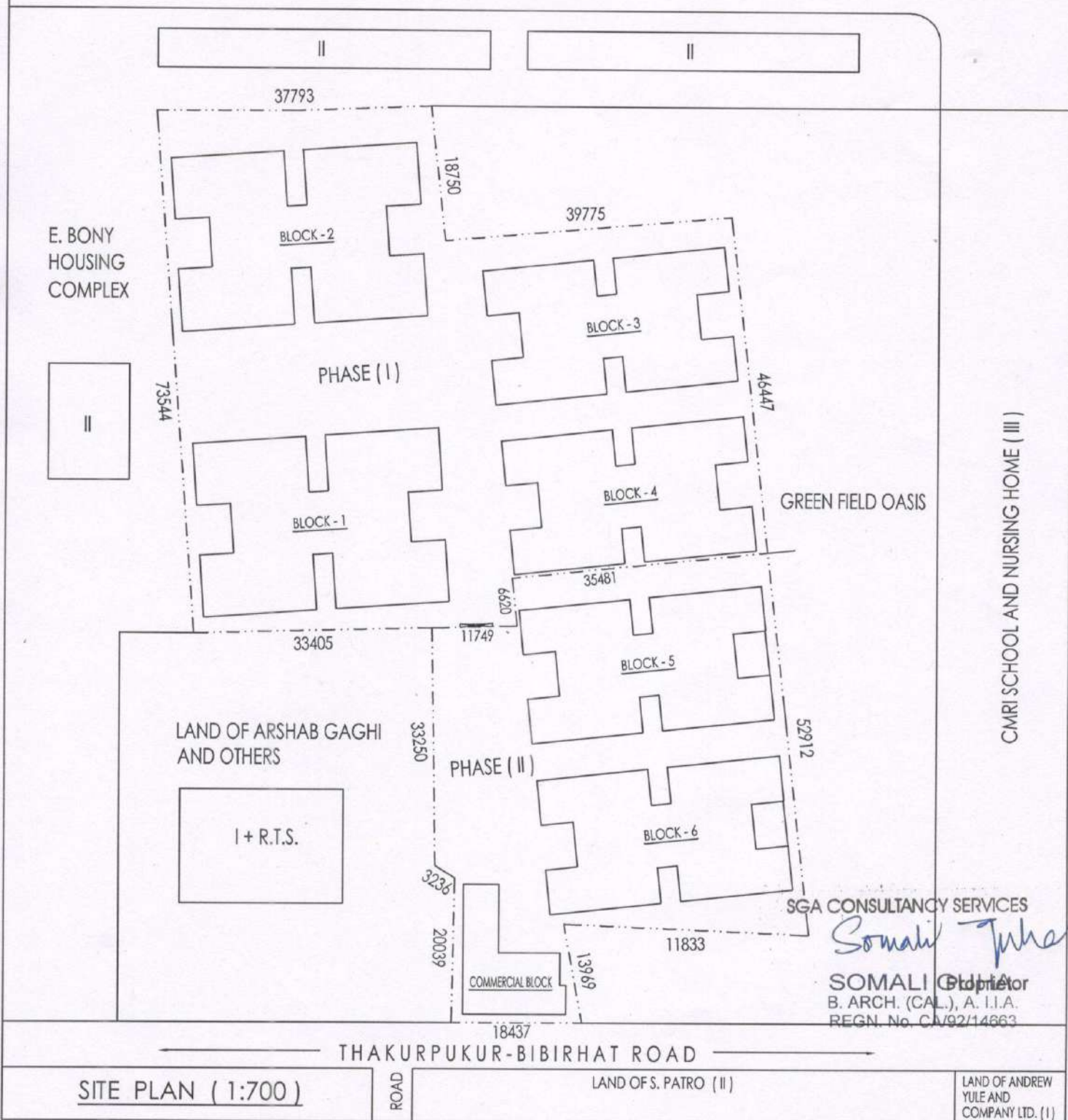

SGA CONSULTANCY SERVICES
Somali Taha
SOMALI Taha
 B. ARCH. (CAL.), A. I.I.A.
 REGN. No. CA/92/14663

THAKURPUKUR-BIBIRHAT ROAD

SITE PLAN (1:700)

ROAD

LAND OF S. PATRO (II)

LAND OF ANDREW YULE AND COMPANY LTD. (I)