

DETAILS OF UNDERGROUND RESERVOIR
CAPACITY: 4800 LITRS
SCALE: 1:100

DETAILS OF UNDERGROUND RESERVOIR
CAPACITY: 7150 LITRS
SCALE: 1:100

DETAILS OF UNDERGROUND RESERVOIR
CAPACITY: 7150 LITRS
SCALE: 1:100

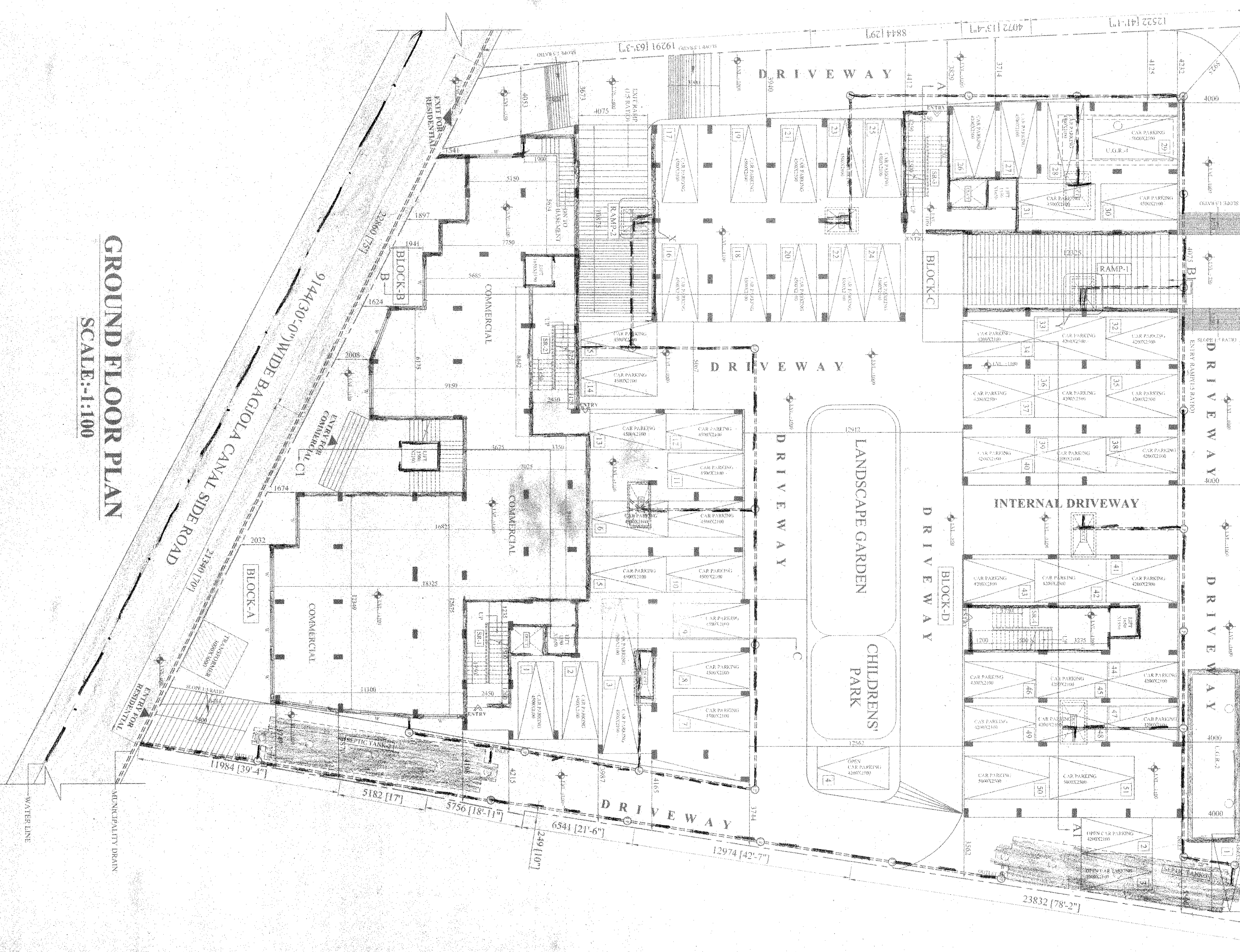

GROUND FLOOR PLAN
SCALE: 1:100

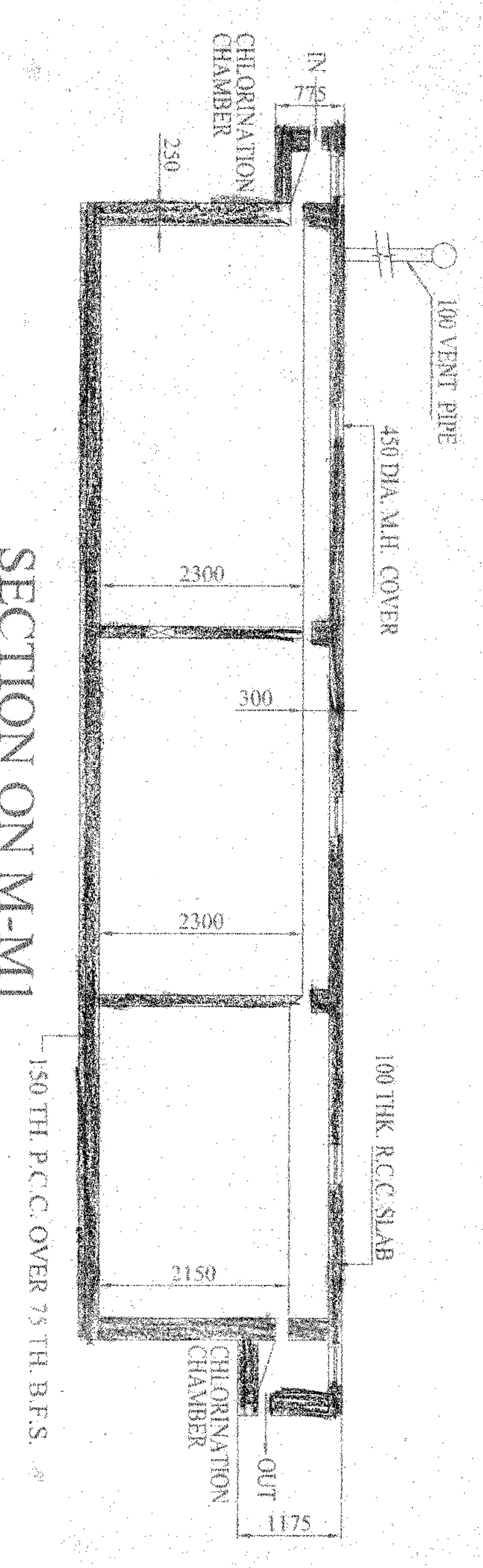

SECTION ON M-M1
SCALE: 1:150

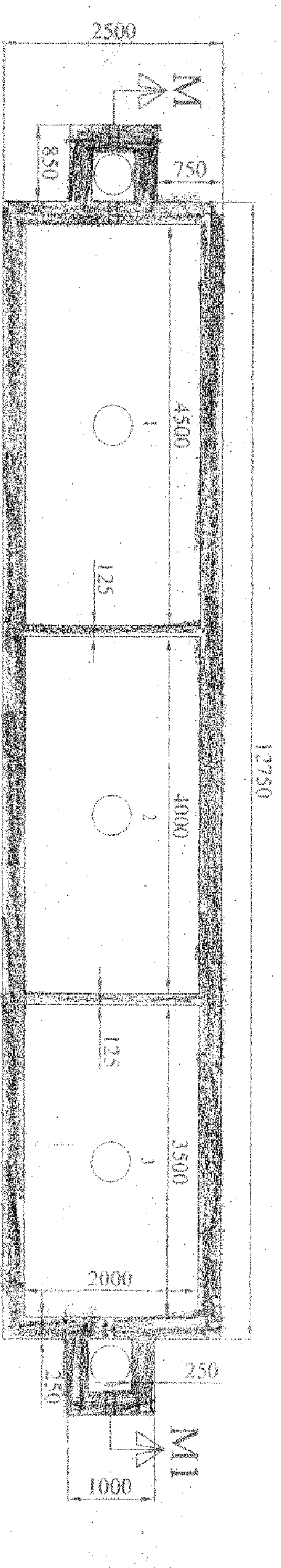

DETAILS OF SEPTIC TANK-1 & 2 (300 USERS)
SCALE: 1:150

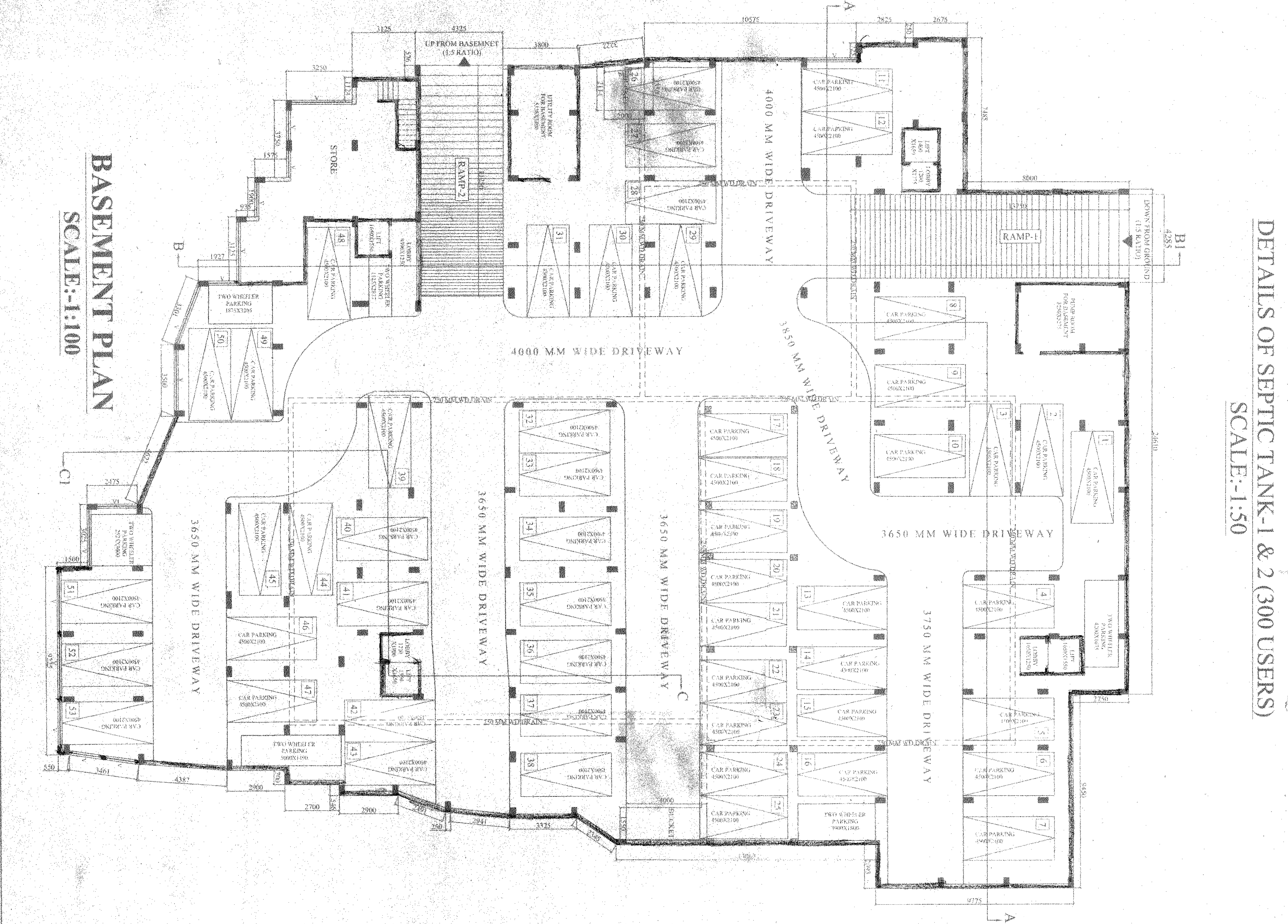

BASEMENT PLAN
SCALE: 1:100

PROJECT:
PROPOSED B-G-VI STORED RESIDENTIAL BUILDING PLAN AT
MORZA CHANDRABABA, JL. NO-15, R.S. NO.-176, TOLAJAN-1072,
R.S. & L.R. DAG NO.-258, C.D. NO.-27427, R.S. KHATIAN NO.-
40, C.S. KHATIAN NO.-61, L.R. KHATIAN NO.-1002, 1003, 1004, NEW
L.R. KHATIAN NO.-1007 & 1008, ROAD NO.-30, DIST.-24 HOSAIN,
P.S.-NEW TOWN UNDER ROADWATER GOVT. MUNICIPALITY

NAME OF OWNER:-
1) MR. BABLU HALDER
2) MRS. JAYANTI HALDER

AREA STATEMENT

TOTAL AREA OF LAND	= 2608.76 SQ.M.
TOTAL AREA OF BASEMENT	= 171.51 SQ.M.
TOTAL AREA OF GROUND FLOOR	= 311.09 SQ.M.
TOTAL AREA OF 1ST FLOOR	= 1672.50 SQ.M.
TOTAL AREA OF 2ND FLOOR	= 1434.50 SQ.M.
TOTAL AREA OF 3RD FLOOR	= 1434.50 SQ.M.
TOTAL AREA OF 4TH FLOOR	= 1434.50 SQ.M.
TOTAL AREA OF 5TH FLOOR	= 1434.50 SQ.M.
TOTAL AREA OF 6TH FLOOR	= 1434.50 SQ.M.
TOTAL AREA OF 7TH FLOOR	= 1434.50 SQ.M.
TOTAL AREA OF 8TH FLOOR	= 1434.50 SQ.M.
TOTAL AREA OF 9TH FLOOR	= 1434.50 SQ.M.
TOTAL AREA OF 10TH FLOOR	= 1434.50 SQ.M.
TOTAL AREA OF 11TH FLOOR	= 1434.50 SQ.M.
TOTAL AREA OF 12TH FLOOR	= 1434.50 SQ.M.
TOTAL AREA OF 13TH FLOOR	= 1434.50 SQ.M.
TOTAL AREA OF 14TH FLOOR	= 1434.50 SQ.M.
TOTAL AREA OF 15TH FLOOR	= 1434.50 SQ.M.
TOTAL AREA OF 16TH FLOOR	= 1434.50 SQ.M.
TOTAL AREA OF 17TH FLOOR	= 1434.50 SQ.M.
TOTAL AREA OF 18TH FLOOR	= 1434.50 SQ.M.
TOTAL AREA OF 19TH FLOOR	= 1434.50 SQ.M.
TOTAL AREA OF 20TH FLOOR	= 1434.50 SQ.M.

CERTIFICATE OF OWNER:-
I hereby certify that the above mentioned plan and drawings are true and correct and conform to the requirements of the relevant laws and regulations and I have no objection to the execution of the same.

CERTIFICATE OF ENGINEER:-
I hereby certify that the above mentioned plan and drawings are true and correct and conform to the requirements of the relevant laws and regulations and I have no objection to the execution of the same.

SCHEDULE OF DOORS & WINDOWS			
NO.	DOORS	WINDOWS	REMARKS
1	1050	1825	W1
2	1050	1825	W2
3	1050	1825	W3
4	1050	1825	W4
5	1050	1825	W5
6	1050	1825	W6
7	1050	1825	W7
8	1050	1825	W8
9	1050	1825	W9
10	1050	1825	W10
11	1050	1825	W11
12	1050	1825	W12
13	1050	1825	W13
14	1050	1825	W14
15	1050	1825	W15
16	1050	1825	W16
17	1050	1825	W17
18	1050	1825	W18
19	1050	1825	W19
20	1050	1825	W20
21	1050	1825	W21
22	1050	1825	W22
23	1050	1825	W23
24	1050	1825	W24
25	1050	1825	W25
26	1050	1825	W26
27	1050	1825	W27
28	1050	1825	W28
29	1050	1825	W29
30	1050	1825	W30
31	1050	1825	W31
32	1050	1825	W32
33	1050	1825	W33
34	1050	1825	W34
35	1050	1825	W35
36	1050	1825	W36
37	1050	1825	W37
38	1050	1825	W38
39	1050	1825	W39
40	1050	1825	W40
41	1050	1825	W41
42	1050	1825	W42
43	1050	1825	W43
44	1050	1825	W44
45	1050	1825	W45
46	1050	1825	W46
47	1050	1825	W47
48	1050	1825	W48
49	1050	1825	W49
50	1050	1825	W50
51	1050	1825	W51
52	1050	1825	W52
53	1050	1825	W53
54	1050	1825	W54
55	1050	1825	W55
56	1050	1825	W56
57	1050	1825	W57
58	1050	1825	W58
59	1050	1825	W59
60	1050	1825	W60
61	1050	1825	W61
62	1050	1825	W62
63	1050	1825	W63
64	1050	1825	W64
65	1050	1825	W65
66	1050	1825	W66
67	1050	1825	W67
68	1050	1825	W68
69	1050	1825	W69
70	1050	1825	W70
71	1050	1825	W71
72	1050	1825	W72
73	1050	1825	W73
74	1050	1825	W74
75	1050	1825	W75
76	1050	1825	W76
77	1050	1825	W77
78	1050	1825	W78
79	1050	1825	W79
80	1050	1825	W80
81	1050	1825	W81
82	1050	1825	W82
83	1050	1825	W83
84	1050	1825	W84
85	1050	1825	W85
86	1050	1825	W86
87	1050	1825	W87
88	1050	1825	W88
89	1050	1825	W89
90	1050	1825	W90
91	1050	1825	W91
92	1050	1825	W92
93	1050	1825	W93
94	1050	1825	W94
95	1050	1825	W95
96	1050	1825	W96
97	1050	1825	W97
98	1050	1825	W98
99	1050	1825	W99
100	1050	1825	W100

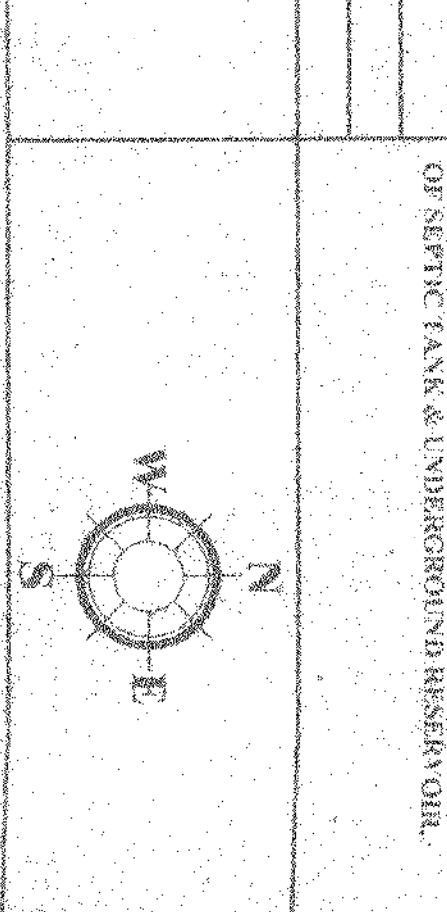

ARCHITECT:
SUCHANDRANA RAY
CHARTERED ARCHITECT

SCALE: 1:100

TITLE:
GROUND FLOOR PLAN, BASEMENT PLAN AND
DETAILS OF SEPTIC TANK & UNDERGROUND RESERVOIR

NOTES:
1. ALL DIMENSIONS ARE IN METERS.
2. ALL EXTERNAL WORKS ARE TO BE DONE AS PER THE REQUIREMENTS OF THE LOCAL AUTHORITY.
3. EXTERNAL MANHOLE IS TO BE PROVIDED AT THE CORNER OF THE BUILDING.
4. EXTERNAL MANHOLE IS TO BE PROVIDED AT THE CORNER OF THE BUILDING.
5. EXTERNAL MANHOLE IS TO BE PROVIDED AT THE CORNER OF THE BUILDING.
6. EXTERNAL MANHOLE IS TO BE PROVIDED AT THE CORNER OF THE BUILDING.
7. EXTERNAL MANHOLE IS TO BE PROVIDED AT THE CORNER OF THE BUILDING.
8. EXTERNAL MANHOLE IS TO BE PROVIDED AT THE CORNER OF THE BUILDING.
9. EXTERNAL MANHOLE IS TO BE PROVIDED AT THE CORNER OF THE BUILDING.
10. EXTERNAL MANHOLE IS TO BE PROVIDED AT THE CORNER OF THE BUILDING.