

LOCATION/KEY PLAN OF PREMISES NO.-19/1, BIPLABI BARIN GHOSH SARANI,
 P.S.- MANIKTALA, KOLKATA - 700067, UNDER THE K.M.C. WARD NO - 32,
 ASSESSE NO. -11-032-05-0001-1, BOROUGH-III, AND DISTRICT OF SOUTH 24-PARGANAS

LAND AREA - 28 CATTAH-06CHITTAK-43 SQ.FT. MORE OR LESS
 (SHOWN THE "RED" COLOUR LINE)

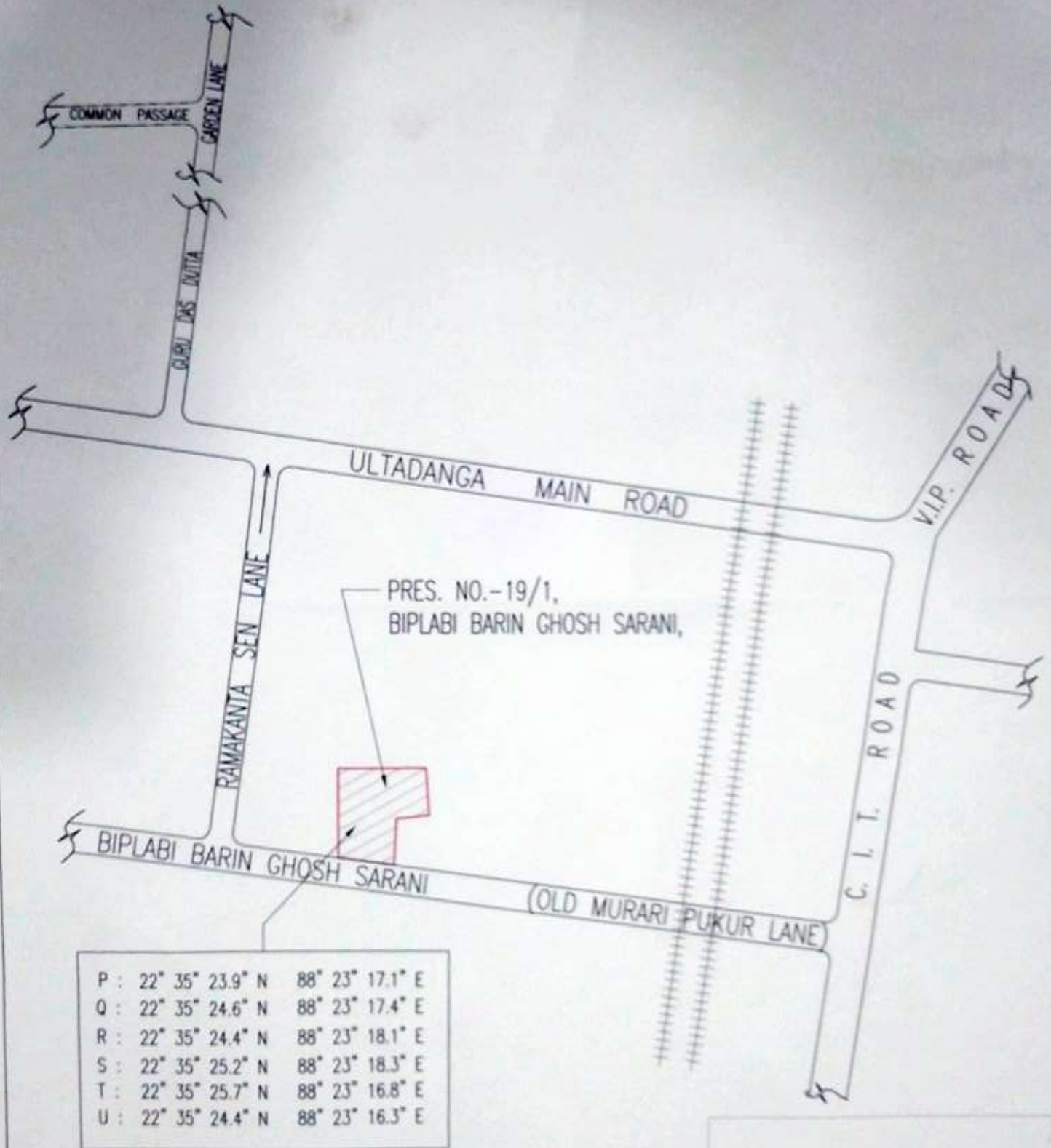

LOCATION/KEY PLAN
 SCALE-1:2000



Raj Kumar Agarwal
 Rajkumar Agarwal
 Architect
 Member of Council of
 Architecture CA / 94 / 1790

SIGNATURE OF ARCHITECT