

SECTION-SS
SCALE- 1:100

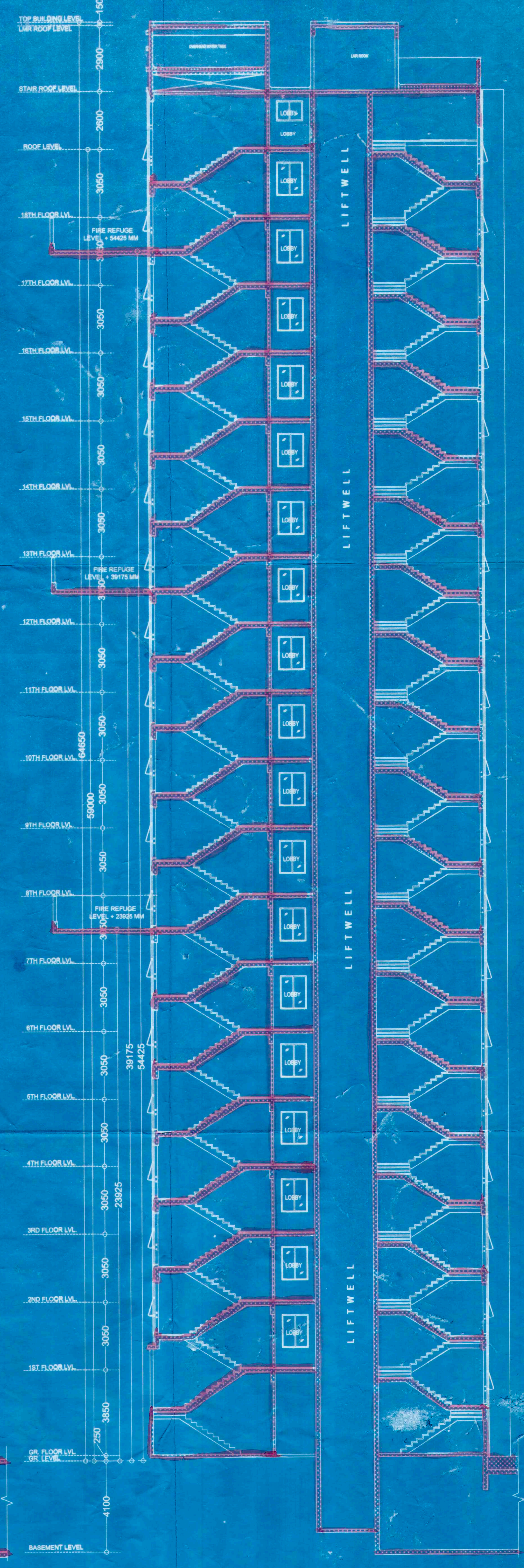

SECTION-TT
SCALE- 1:100

DECLARATION OF REVIEWER:

I HAVE CHECKED THE STRUCTURAL CALCULATIONS MADE BY SRI CHANDI PROSAD KHANRA, E.S.E. I/2. THE CALCULATION IS FOUND CORRECT AND STRUCTURE IS SAFE AND STABLE IN ALL RESPECT.

M. Mita

MS. MITA SAHA
M.I.E., M.E. (Struct), C.E.
ESE-52(1)
AC-23, Sec-11, Salt Lake
M.No.-3531950112

DECLARATION OF OWNER :

1. I SHALL ENGAGE ARCHITECT & ESE DURING CONSTRUCTION
2. I SHALL APPLY ALL GUIDE LINES DIRECTED BY W.B.E.F.S., AND W.B. POLLUTION CENTRAL BOARD AND OBSERVATION OF DG (PMU) OF KMC.
3. NO CONSTRUCTION WILL BE MADE IN THE WATER BODY
4. THE DOCUMENTS, SUBMITTED ARE TRUE TO THE BEST OF MY KNOWLEDGE. IF ANY DOCUMENT IN FOUND FAKE, KMC AUTHORITY WILL REMOVE THE SANCTION PLAN.

For CALCUTTA INFRASTRUCTURE INFOTECH PROJECTS LIMITED
S. K. Ghosh
S. K. Ghosh
Construction Planning

DECLARATION OF STRUCTURAL ENGINEER :

THE STRUCTURAL DESIGN DRAWINGS OF BOTH FOUNDATION AND SUPERSTRUCTURE HAS BEEN MADE BY ME CONSIDERING ALL POSSIBLE LOADS INCLUDING THE SEISMIC LOAD AS PER THE NATIONAL BUILDING CODE OF INDIA AND CERTIFIED THAT IT IS SAFE AND STABLE IN ALL RESPECTS. THE ABOVE CALCULATION HAS BEEN MADE BASED ON SOIL TEST REPORT DONE BY Dr. MADHUSUDAN NAYAK, C.E. TESTING COMPANY PVT. LTD. 124A N.S.C. BOSE ROAD, KOLKATA-700 092.

C. Khanna
CHANDI PROSAD KHANRA
B.E. (CIVIL), M.E. (Struct), M.AE (India)
E.S.E. 52

DECLARATION OF ARCHITECT :

CERTIFYING WITH FULL RESPONSIBILITY THAT THE BUILDING PLAN HAS BEEN DRAWN UP AS PER PROVISION OF KMC BUILDING RULE - 2009 AS AMENDED FROM TIME TO TIME AND THAT THE SITE CONDITION INCLUDING THE WIDTH OF ABUTTING BITUMINUS ROAD OF WIDTH 12.5 M HAS BEEN MEASURED AND VERIFIED BY ME. IT IS A SOLID LAND OVER WHICH THE PROPOSAL HAS BEEN MADE. THE POND/WATER BODY OF AREA 5823.75 SQUARE METRE SEPARATELY DEMARCATED. THE ENTIRE PREMISES IS BOUNDED BY BOUNDARY WALL.

Harsh Sanon
HARSH SANON
COUNCIL OF ARCHITECTURE
REGISTRATION NO. CA/90/13556

HARSH SANON
COUNCIL OF ARCHITECTURE
REGISTRATION NO. CA/90/13556

PROJECT :

REVISED PLAN PROPOSAL FOR SANCTIONED UNDER R26 (2A & 2B) FOR 2 NOS OF B+G+14 (WING-1 & 8), 2 NOS OF B+G+16 (WING- 2 & 7), 1 NO OF B+G+18 (WING-10) & 5 NOS OF B+G+18 (WING- 3, 4, 5, 6 & 9) STORIED RESIDENTIAL BUILDINGS WITH B+G+1 STORIED CLUB BUILDING, B,S PERMIT NO: 2014130224, DATED: 03.09.2014, AT PREMISES NO.- 591A MOTILAL GUPTA ROAD, KOLKATA-700 008, W- 122, B-XIII, UNDER KOLKATA MUNICIPAL CORPORATION.

JOB NO:

TITLE : WING- 10

DRG NO:

CA/ 32

SECTION- SS & SECTION- TT

REVISION NO:

SCALE: As mentioned

DEALT BY: Moumita

CHECKED: Suvadip

DATE: 19.09.2015



SANON SEN & ASSOCIATES (P) LTD.

5, RUSSEL STREET, KOLKATA-700 071
PHONE: 91-33-22264579, 22278068, 22172509
FAX: 2226 6917 www.sanonsen.com

2nd Part (Sept 2015)