



TO
THE CHAIRMEN
SOUTH DUM DUM MUNICIPALITY
74, DUM DUM ROAD
KOLKATA - 7000 74

Date :- _____

Sub: Phase II Sanction of 4--- storied building of sanction plan no. 345 Dated 25/4/2019 against of Holding no. 82, Dum Dum Park Kolkata- 700 055 Under ward no.

Respected Sir,

This is for your information that I have owner of the plot of land & building, the casting of Ground floor Roof has been done on date 25/04/19 of the building at holding no. 82, Dum Dum Park, Kolkata- 700 055

You may inspect and complete the necessary formalities and give us the phase - II sanction as early as possible and oblige.

Dibyendu Bhattacharya

Thanking you

Sarbananda Bhattacharya

Yours truly,

PARK PROPERTIES
Utpal Maity
Proprietor

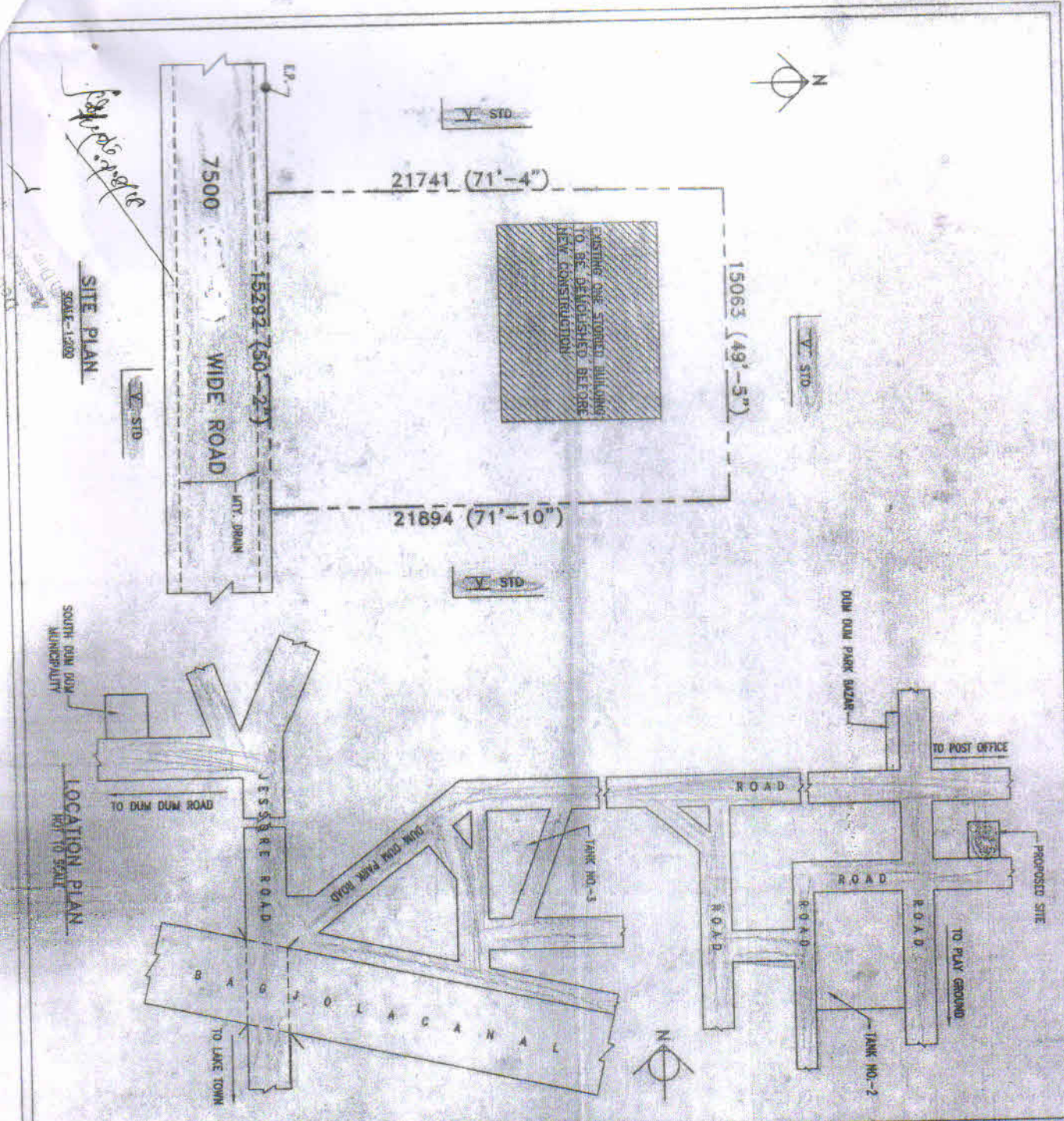

Handwritten signature
 SITE PLAN
 SCALE-1:200

LOCATION PLAN
 Scale 1:5000

SITE PLAN OF A PIECE OF LAND OF SRI DIBYENDU BHATTACHARJEE, & SRI SARBENDU BHATTACHARJEE, IN RESPECT OF MUNICIPAL HOLDING NO.-82, DUM DUM PARK, AT MOUTA- SHYAMNAGAR, I.L. NO.-17, COMPRISED IN C.S. DAG NO.-2373, PLOT NO.-47, DIST 24 PARGANAS (N) P.S.-LAKE TOWN, WARD NO.-28, UNDER SOUTH DUM DUM MUNICIPALITY

SITE PLAN FOR PROPOSED BUILDING AS PER RULE

NATURE OF LAND -	AREA STATEMENT
TOTAL AREA OF LAND - 5 KH. 0 CH. 00 SFT. - 1a-354.45 Sqm.	(AS PER DEED)
TOTAL AREA OF LAND - 4 KH. 13 CH. 09 SFT. - 1a-351.13 Sqm.	(AS PER MEASURED)
PERMISSIBLE COVERED AREA - (38.44%) - 1a-193.51 Sqm.	

CERTIFICATE OF OWNER

I/WE ALSO UNDERTAKE TO REPORT THAT THERE IS NO COURT CASE OR ANY COMPLAINT FROM MY ANY CORNER OF MY PROPERTY AS PER SITE.

I/WE ALSO UNDERTAKE THAT I/WE HAVE NOT SOLD OR TRANSFER ANY PORTION OF MY/OUR PROPERTY TO ANY BODY UPON NOW SOUTH DUM DUM MUNICIPALITY WILL NOT BE LIABLE IF ANY TYPE OF DISPUTE ARISING IN FUTURE CERTIFIED THAT THE TIME OF CONSTRUCTION OF MY/OUR BUILDING I/WE REPAIR OR CONSTRUCTED THE PORTION OF EXISTING DRAIN AND ROAD IN FRONT OF MY/OUR PREMISES OF ANY DAMAGE OCCURS

Dibyendu Bhattacharjee
 SIG. OF OWNER

Sarbendu Bhattacharjee
 SIG. OF OWNER

Anil Mondal
 ANAL MONDAL
 Licenced Building Surveyor
 S.D.D.M
 Class-II
 Licence No-S.D.D.M/28 2016-2017

SIG. OF PLAN MAKER