

SITE PLAN OF R.S. DAG NO. 1095, 1096, 1097, 1098, 1094/1624
 1097/1626, KHATIAN NO. - 462 & 465 J.L. NO. - 49, MOUZA -
 KAMDAHARI, 24 Pcs. P.G. - REGENT PARK WARD NO -111
 UNDER KOLKATA MUNICIPAL CORPORATION
 AREA OF LAND - 85443 Sqm.
 N: ALL - 1:100

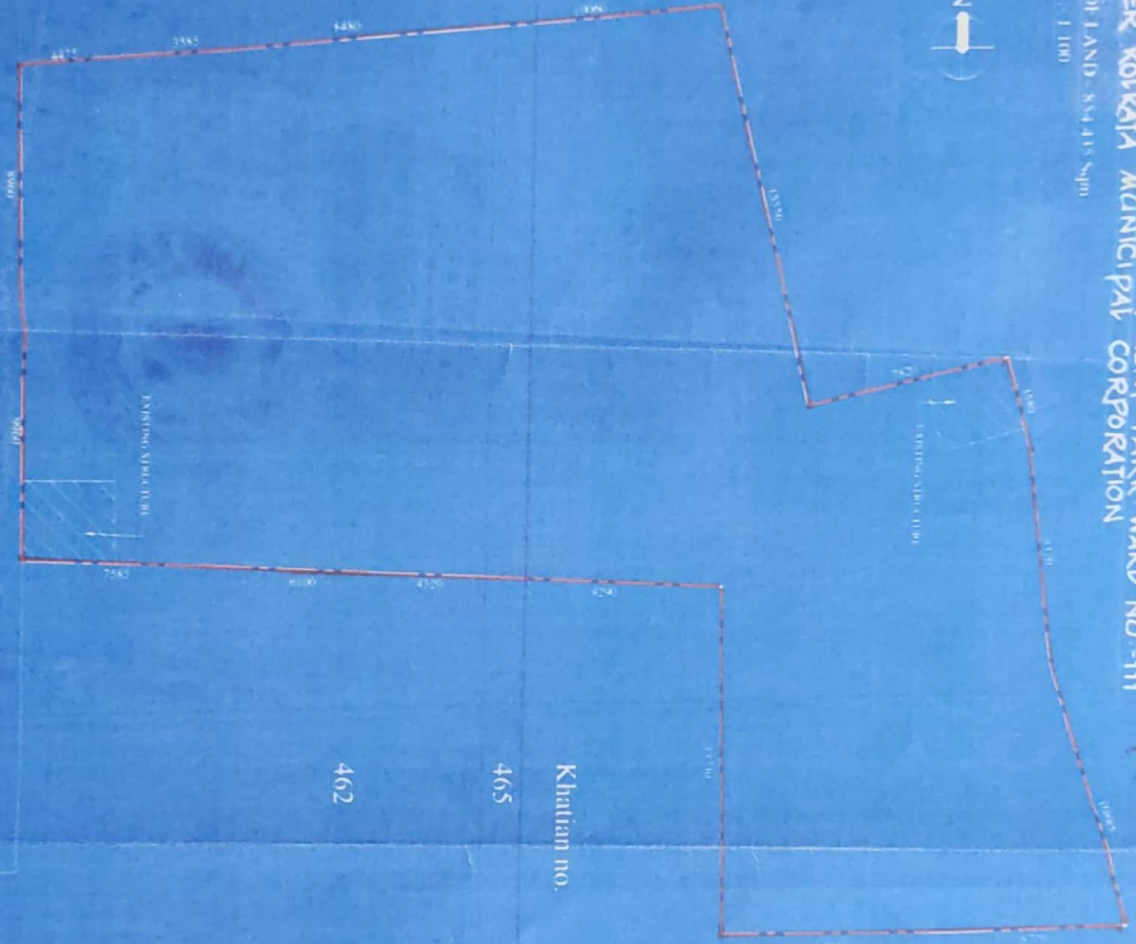

7325 M. W I D E R O A D
 (C.M.C. ROAD)

Khatian no.

465

462

Dag no.

1095
1096
1097
1098

1094
1624
1097
1626

K

4
2
2
2

0
0
1
0

Ch

0
2
12
8

8
-
0
-

Sft.

0
0
0
0

0
0
0
0

12 - 14 - 0

Power Transformer
Make Rain Drain

[Handwritten signature]

143



Pranveer
Sach No. 145
Folio No. 142
Page No. 21859
of the year 2006

addl. Sd/- Sub-Registrar
Alipore South M. Pargana
11/5/06