

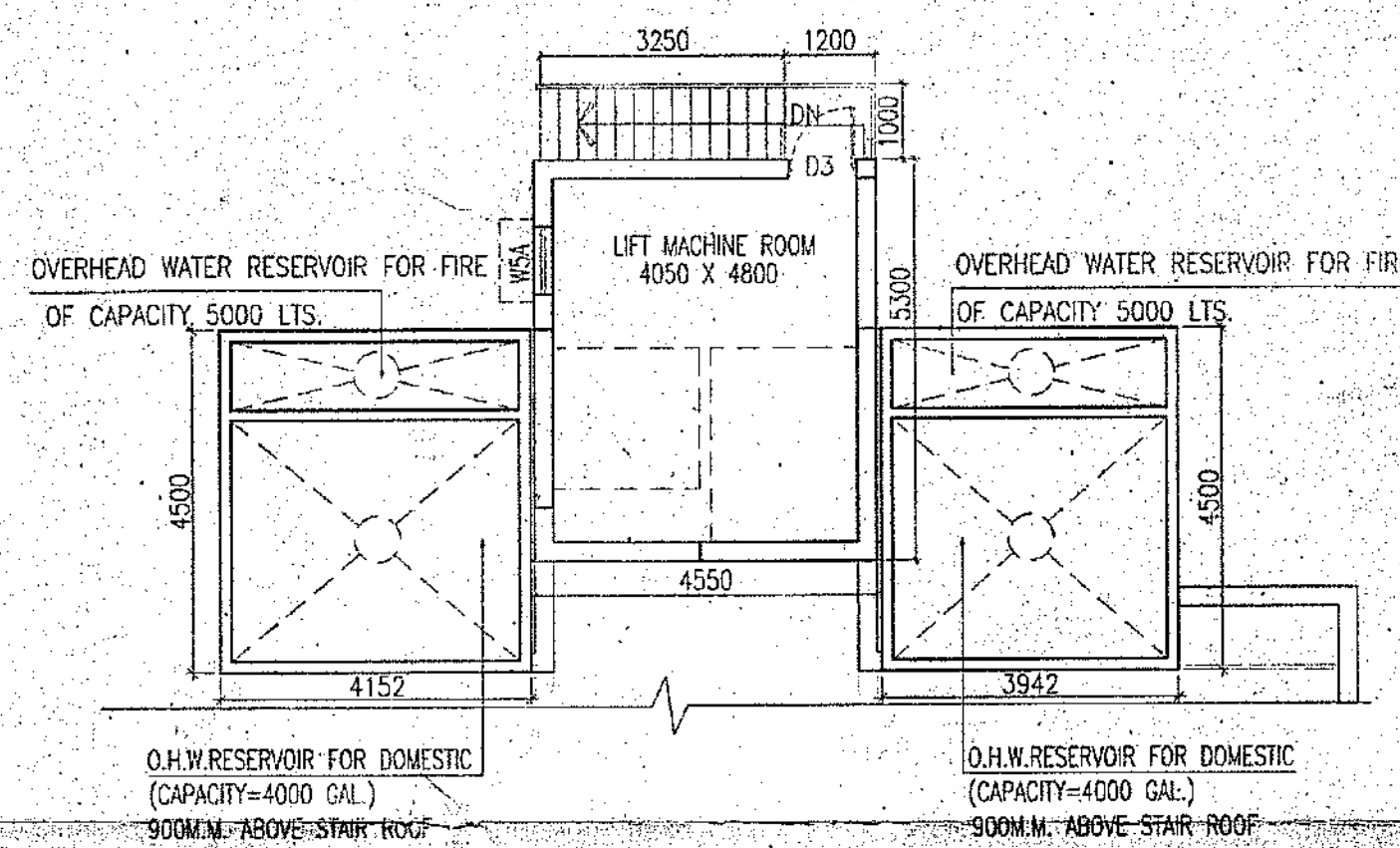

FRONT ELEVATION  
BLOCK -2A & 2B

FRONT ELEVATION  
BLOCK-2C



PART PLAN OF L.M.R. & O.H.T. FOR DOMESTIC & FIRE  
BLOCK -2A

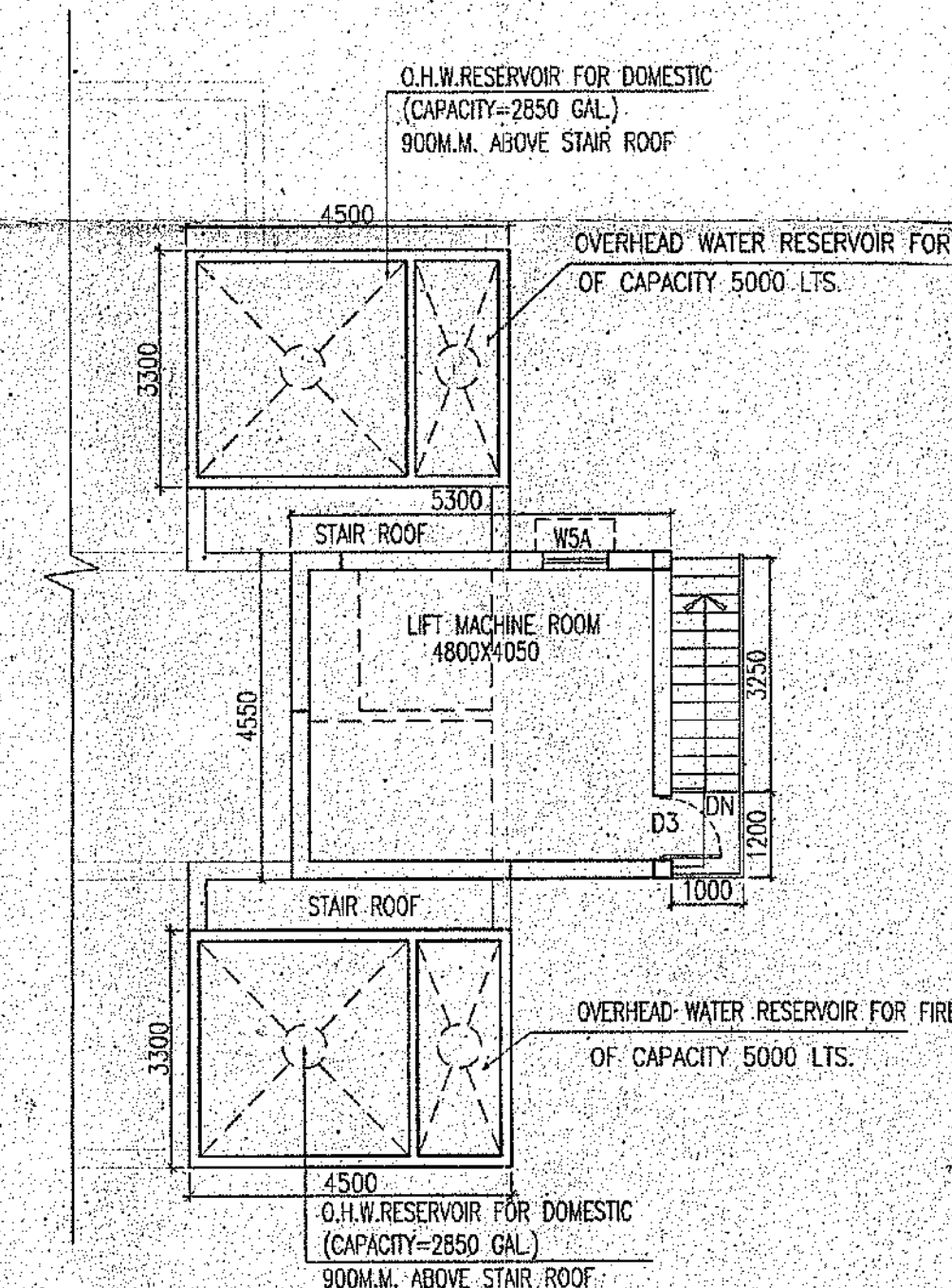

PART PLAN OF L.M.R. & O.H.T. FOR DOMESTIC & FIRE  
BLOCK -2B

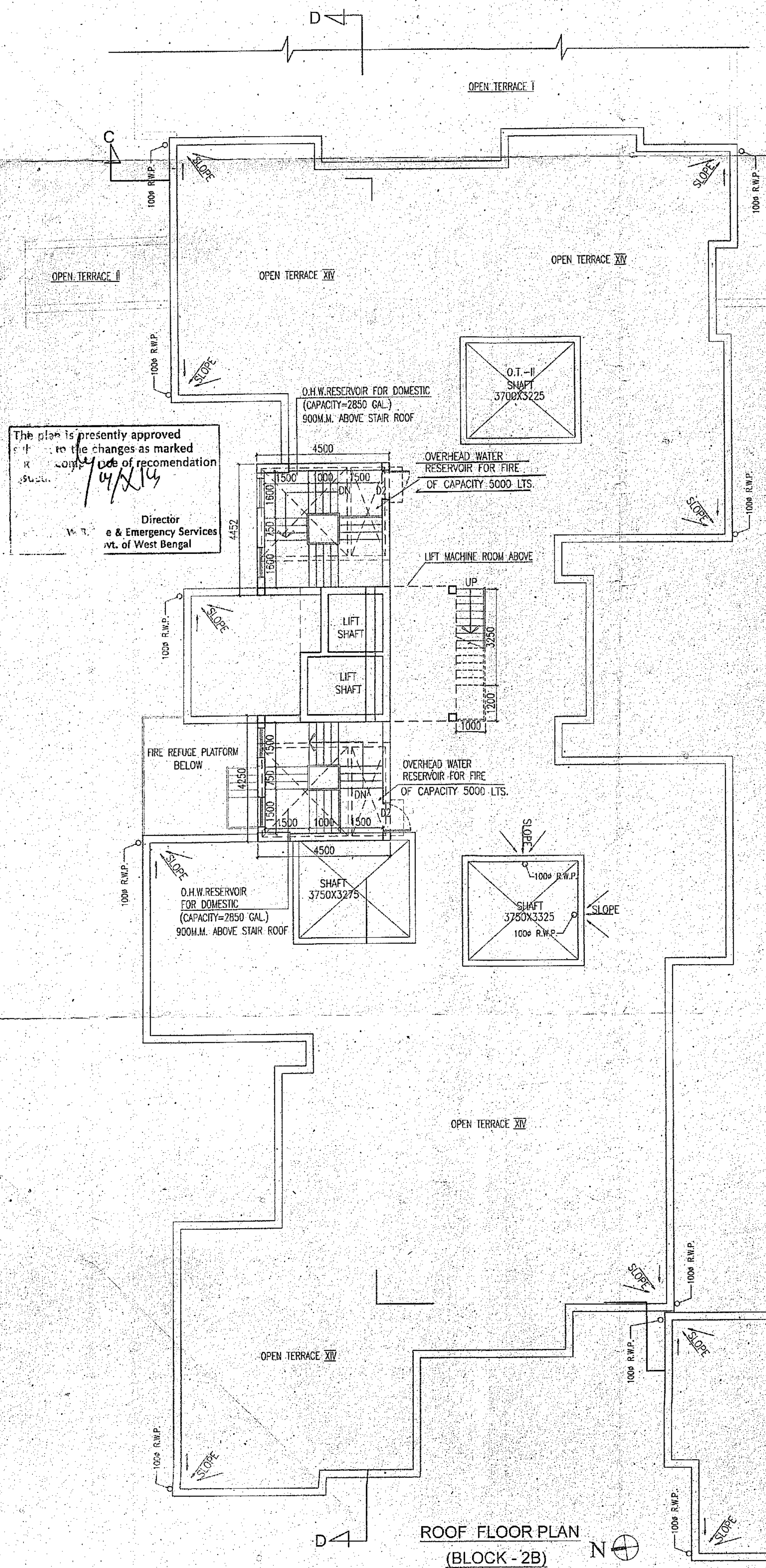

ROOF FLOOR PLAN  
(BLOCK - 2B)

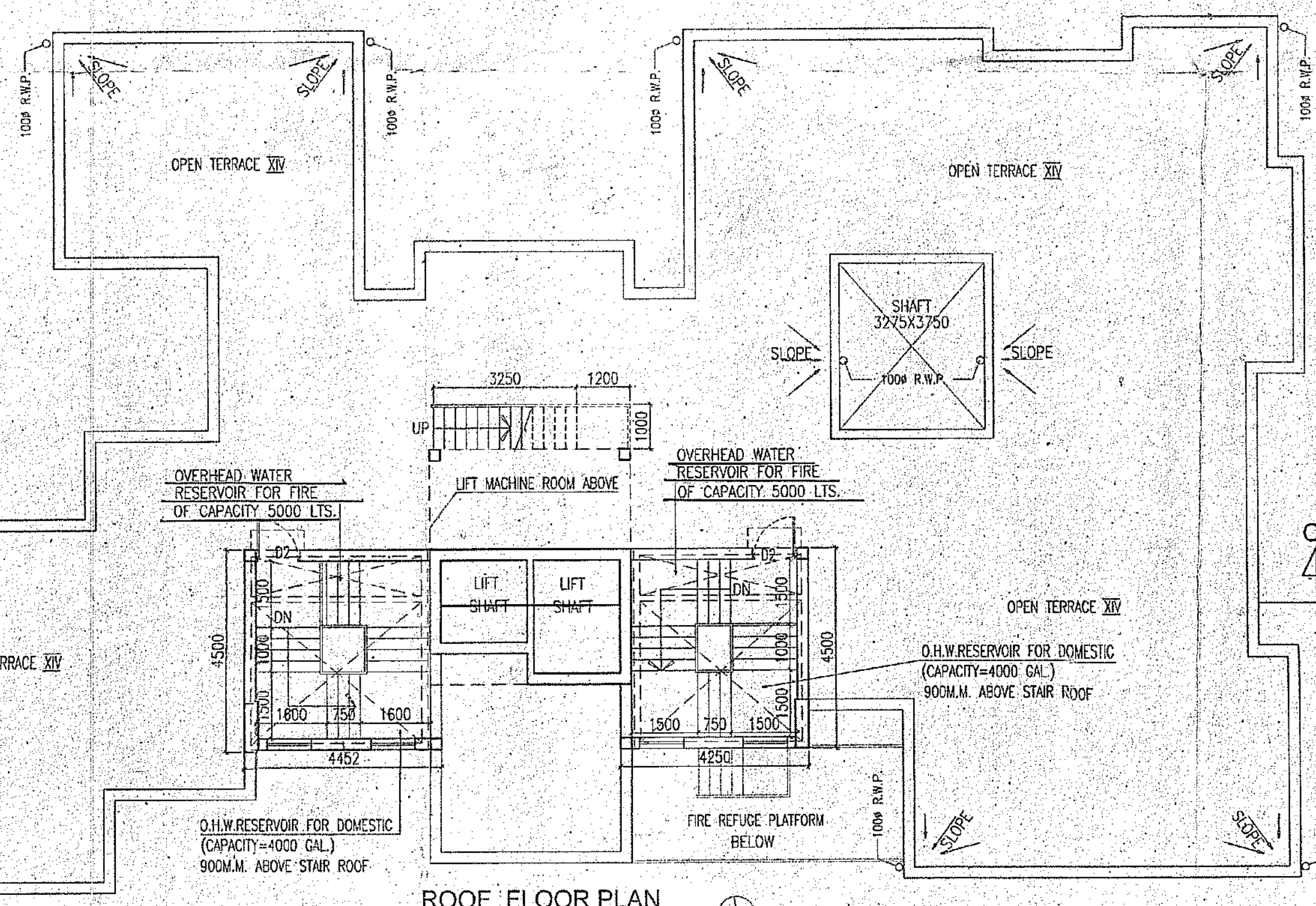

ROOF FLOOR PLAN  
(BLOCK - 2A)

OWNER'S  
EVERLINK BUILDERS PVT. LTD. & OTHERS

CERTIFICATE OF OWNER  
CERTIFIED THAT I HAVE GONE THROUGH THE BUILDING RULES FOR RAJPUR-SONARPUR MUNICIPALITY AND ALSO UNDER TAKE TO ABIDE BY THESE RULES DURING AND AFTER CONSTRUCTION OF THE BUILDINGS.

EVERLINK BUILDERS PVT. LTD. & OTHERS  
*Rajman*  
Consultant Attorney  
SIGNATURE OF OWNER

CERTIFICATE OF STRUCTURAL STABILITY  
WE HEREBY CERTIFIED THAT THE FOUNDATION AND THE SUPER STRUCTURE OF THE BUILDING PROPOSED FOR CONSTRUCTION ON R.S. DAG NO. - 1326, 1327, 1328, 1329, 1331, 1332, 1333, 1351, 1364, 1365, 1366, 1367, 1368, 1369, 1370, 1371, 1372, 1385, 1385/1712, 1386, 1425/1718, AT MOUZA - BADE HOOGHLY, J.L. NO. - 80, HAVE BEEN SO DESIGNED BY US WILL MAKE SUCH FOUNDATION & SUPER STRUCTURE SAFE IN ALL RESPECTS INCLUDING THE CONSIDERATION OF BEARING CAPACITY OF SOIL E.T.C.

SIGNATURE OF GEO-TECHNICAL ENGINEER

JAY PRAKASH AGRAWAL  
16/1 RAJPUR/SONARPUR/EDA/03-04  
SIGN. OF ARCHITECT SIGN. OF STRUCTURAL ENGG

TITLE :-  
FRONT ELEVATION OF BLOCK 2A, 2B, 2C, ROOF PLAN, PART PLAN OF L.M.R. & O.M.R. DOMESTIC & FIRE

PROJECT :-  
PROPOSED (G+XI), (B+G+XII), (G+XIV) STORED RESIDENTIAL COMPLEX AT MOUZA - BADE HOOGHLY, R.S. DAG. NO. - 1326, 1327, 1328, 1329, 1331, 1332, 1333, 1351, 1364, 1365, 1366, 1367, 1368, 1369, 1370, 1371, 1372, 1385, 1385/1712, 1386, 1425/1718, J.L. NO. - 80, P.S. - SONARPUR, DIST - 24 PARGANAS (S) UNDER RAJPUR, SONARPUR MUNICIPALITY.

ARCHITECTS	
AGRAWAL & AGRAWAL	
BARODA KOLKATA	
SCALE	CHECKED
1:100	SUPRIYA

SCHEDULE OF DOORS & WINDOWS			
NO.	SILL	LINTEL	SIZE
D	2150		1500X2150
D1	2150		1200X2150
D2	2150		900X2150
D3	2150		600X2150
D4	2150		750X2150
PCD	2150		1000X2150
DW	2150		2400X2150
DW1	2150		2100X2150
DW2	2150		2000X2150
DIA	2150		900X2150
W1	350	2150	1800X1800
W1A	2150		1500X1800
W2	350	2150	1200X1800
W3	350	2150	900X1800
W4	1050	2150	800X1100
W5	1250	2150	800X900
W5A	750	2150	900X1400

FOR OFFICE USE