

LOCATION MAP
SCALE = 1:4000

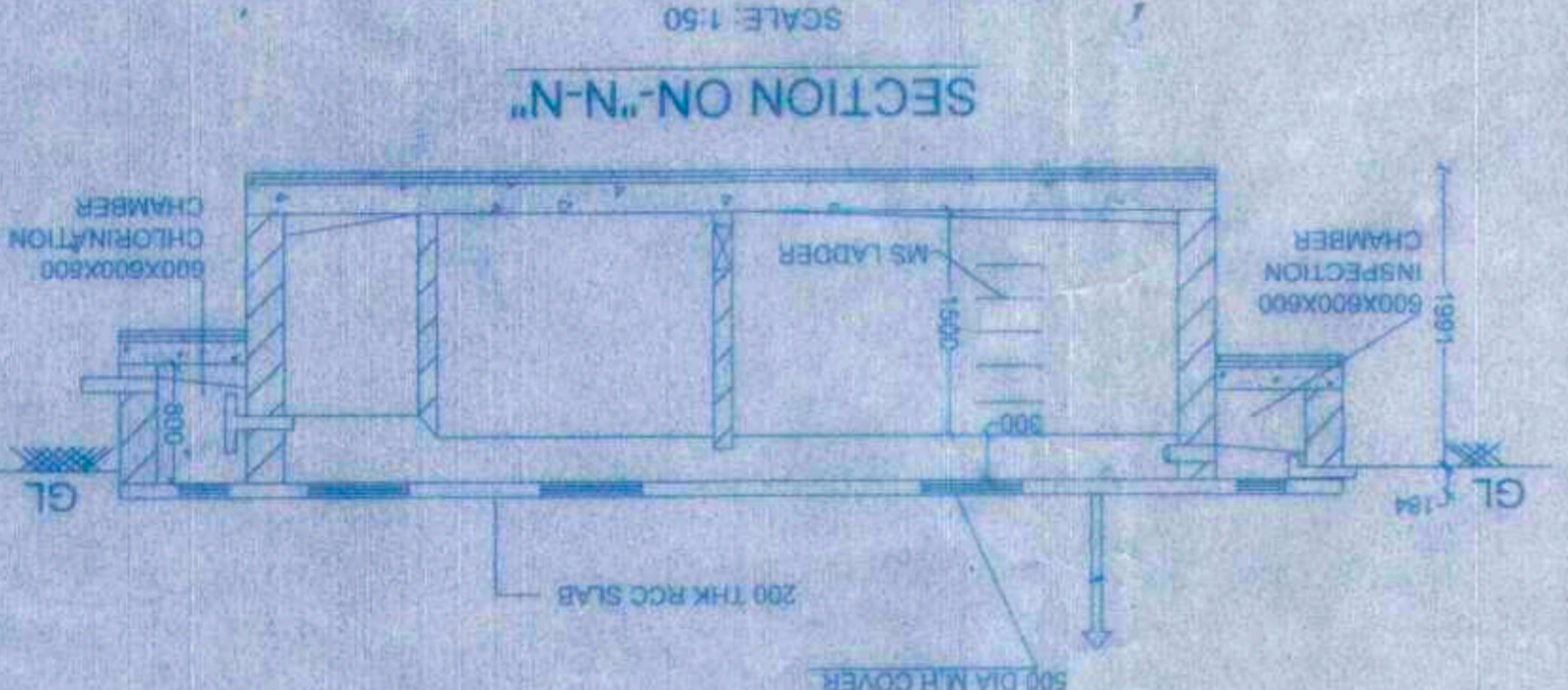

GROUND FLOOR PLAN
SCALE = 1:100

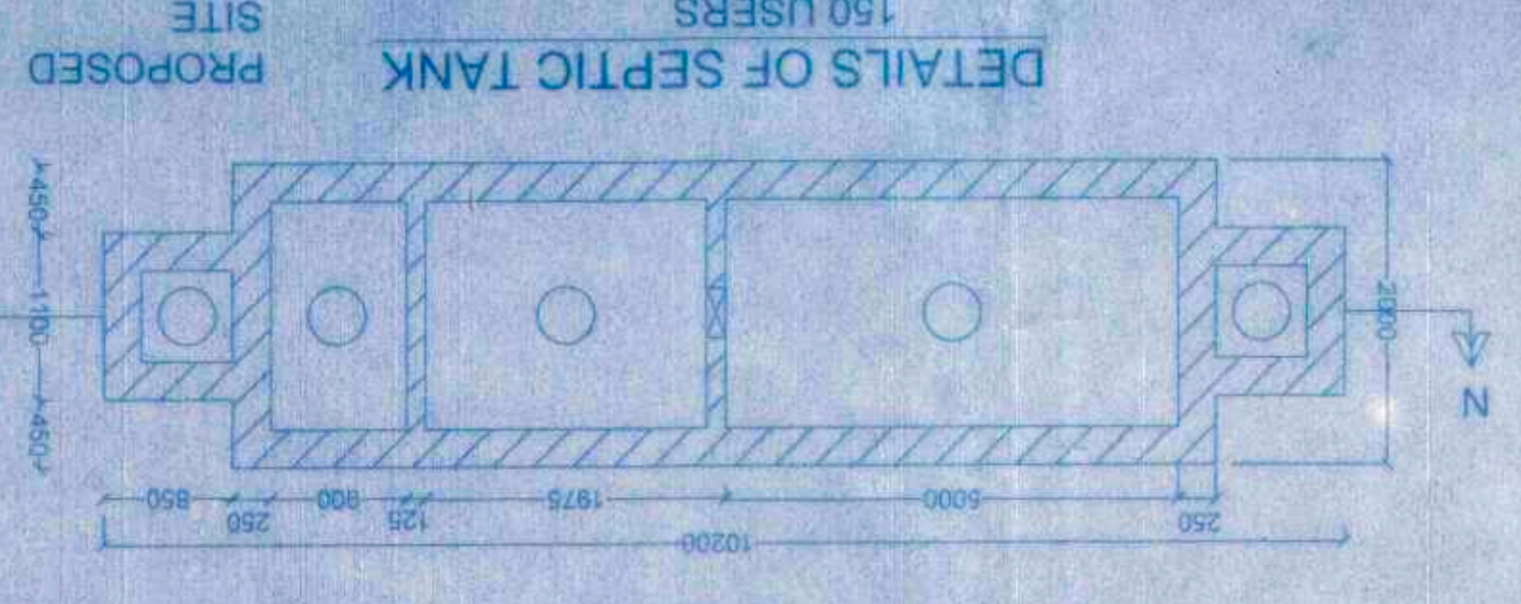
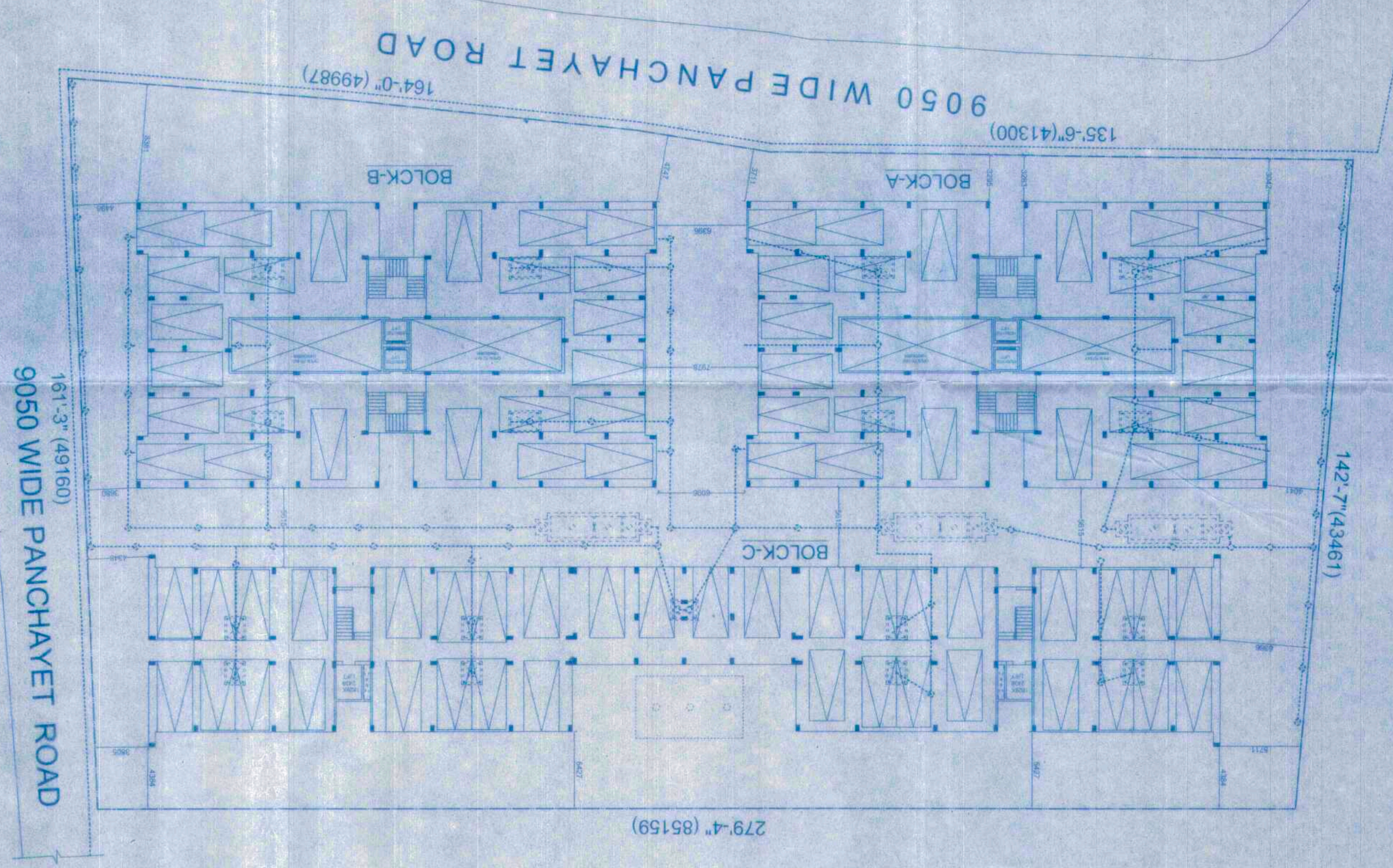

ROOF PLAN BLOCK-C
SCALE = 1:100

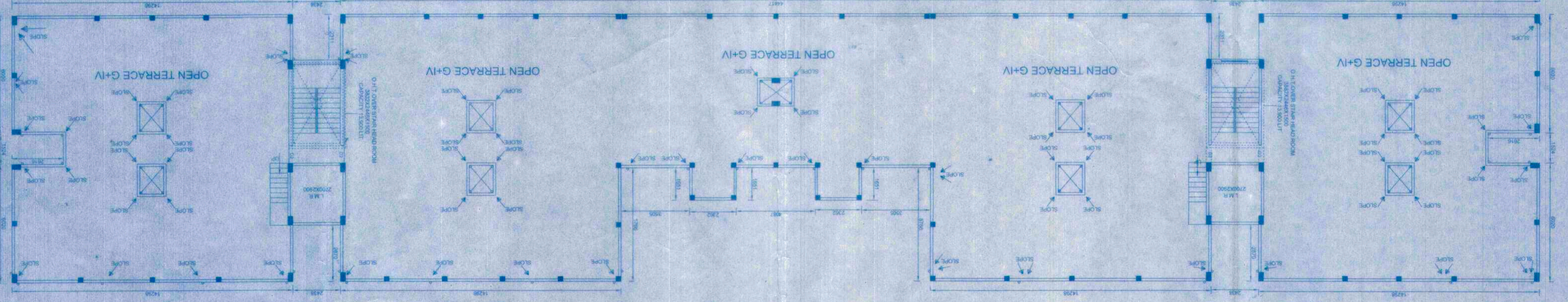

ROOF PLAN BLOCK-A&B
SCALE = 1:100

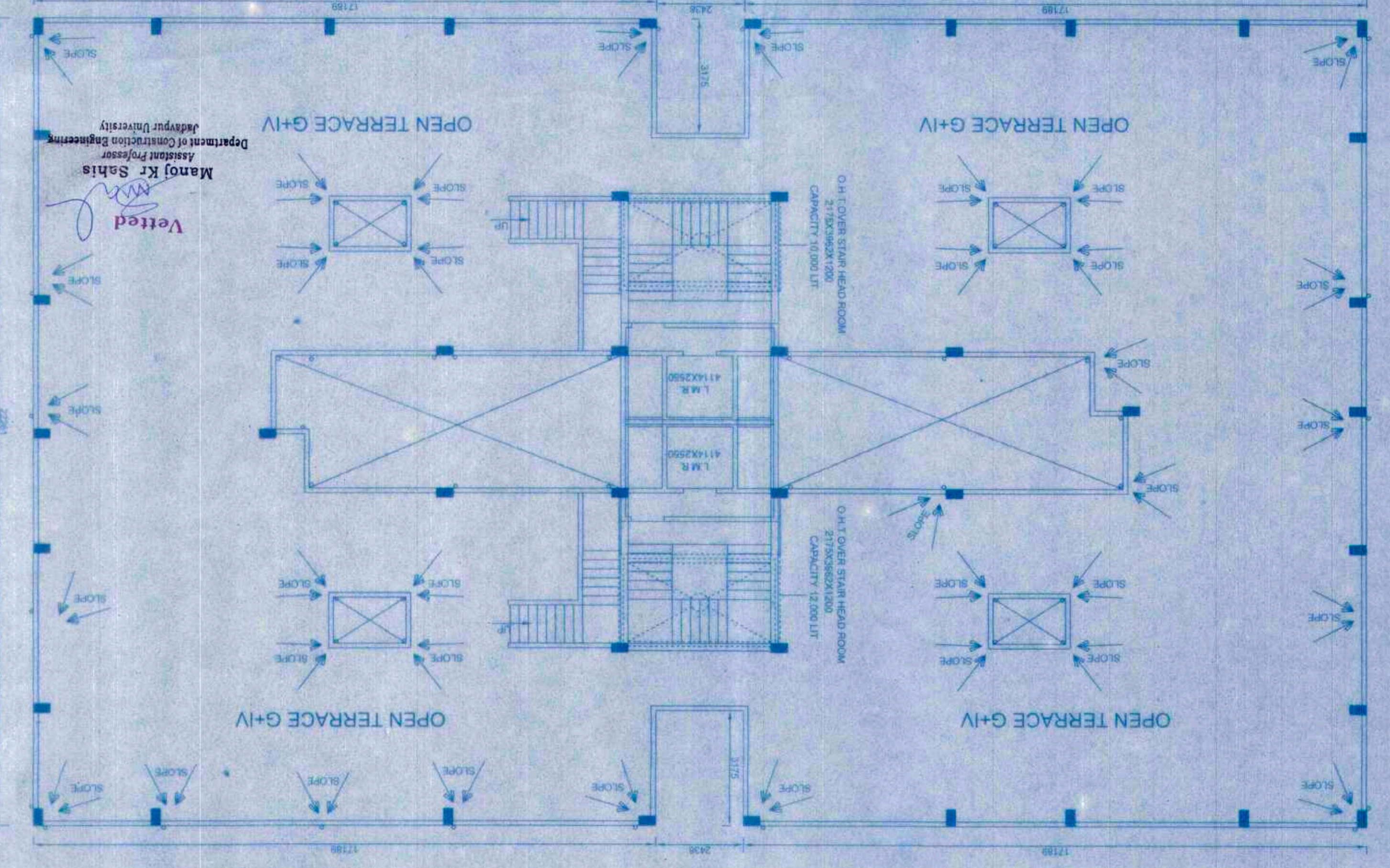

RESIDENTIAL BUILDING PLAN OF KANTA RAM SARDER @ KANTA SARDER, ANNAPURNA SARDER, SITUATED AT RS/LR, DAG NOS: 686, 687, 688, & 689, L.R. KHATIAN NOS. 128, 1141, MOUZA: KALIKAPUR, JL NO. 40, POLICE STATION-RAJARHAT, DIST- NORTH 24 PARGANAS, UNDER PATHARGHATA GRAMPANCHAYET.

PROPOSED G+IV STORED

AREA STATEMENT:
 PERMISSIBLE F.A.R = 2.25 (1752.299 SQM)
 AREA OF LAND = 89K-12CH-14 SFT (397.50 SQM)
 PROPOSED F.A.R = 2.23 (696.99 SQM)
 (1) COVERED AREA OF GROUND FLOOR: 1983.45 SQM (49.86%)
 (BLOCK-A=615.446 SQM+ BLOCK-B=615.446 SQM+ BLOCK-C=752.555 SQM)
 (2) COVERED AREA OF TYPICAL FLOOR= 2392.17 SQM
 (BLOCK-A=716.005 SQM+ BLOCK-B=716.005 SQM+ BLOCK-C=960.165 SQM)
 (3) LEFT OPEN AREA: 2004.55 SQM
 (4) PROPOSED CAR PARKING: 84 NOS

CERTIFICATE OF STRUCTURAL ENGINEER
 I hereby certify that the structural drawing and design of both the foundation and superstructure of the building has been made considering the Soil Test Report, as per the rules and regulations made under the Act and also considering all possible loads, stresses, and strains and the provisions of the CODE OF PRACTICE AND ALSO ACCORDING TO THE NATIONAL BUILDING THROUGH THE NATIONAL BUILDING CERTIFICATE THAT I HAVE GONE THROUGH THE NATIONAL BUILDING CERTIFICATE OF OWNER.

CERTIFICATE OF ARCHITECT
 I hereby certify that the architectural drawing and design of the building has been made in accordance with the provisions of the National Building Code of India, 1970, and also considering all possible loads, stresses, and strains and the provisions of the CODE OF PRACTICE AND ALSO ACCORDING TO THE NATIONAL BUILDING CERTIFICATE OF OWNER.

CERTIFICATE OF GEO-TECHNICAL ENGINEER
 I hereby certify that the soil test has been made in accordance with the provisions of the National Building Code of India, 1970, and also considering all possible loads, stresses, and strains and the provisions of the CODE OF PRACTICE AND ALSO ACCORDING TO THE NATIONAL BUILDING CERTIFICATE OF OWNER.

NOTE:
 (1) ALL OUTER WALLS ARE 300 MM THICK.
 (2) ALL FLAT PARTITION WALLS ARE 125 MM THICK.
 (3) ALL INNER PARTITION WALLS ARE 90 MM THICK.
 (4) GRADE OF CONCRETE: M30
 (5) GRADE OF STEEL: FE-415 & FE-250
 (6) SCALE: 1:100 (UNLESS MENTIONED)

W/D	W	H
W4	1200	1500
W3	600	600
W2	900	1200
W1	1500	1200

WINDOWS:
 DM3 1050 2100
 DM2 1800 2100
 DM1 2000 2100
 D3 750 2100
 D2 900 2100
 D1 1050 2100

DOORS:
 MKD WIDTH HEIGHT
 DOOR WINDOW SCHEDULE

SIGNATURE OF OWNER:
 SHANU CONSTRUCTION
 SHANU

SIGNATURE OF ARCHITECT:
 BUAY KUMAR JANA
 Regd No. - CA982280A
 Council of Architecture

SIGNATURE OF GEO-TECHNICAL ENGINEER:
 S. S. SARDAR
 Regd No. - CA982280A
 Council of Architecture

SIGNATURE OF STRUCTURAL ENGINEER:
 Dipak Kumar
 Regd No. - CA982280A
 Council of Architecture

APPROVED & SANCTIONED BY:
 District Engineer
 North 24 Parganas District
 (Date: 18/02/2024)