

ROOF PLAN BOLCK-F

SCALE= 1:100

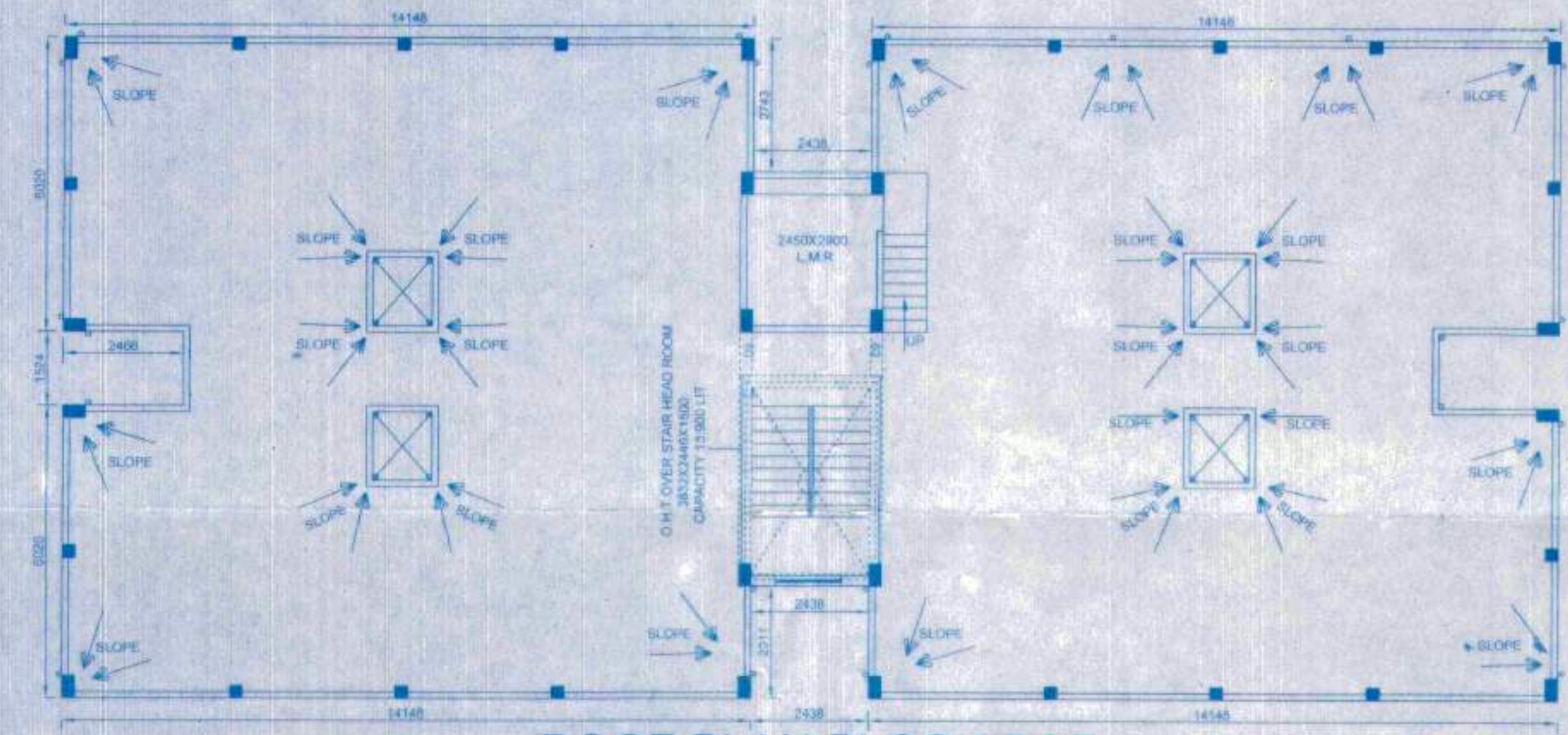

ROOF PLAN BLOCK-D&E

SCALE= 1:100

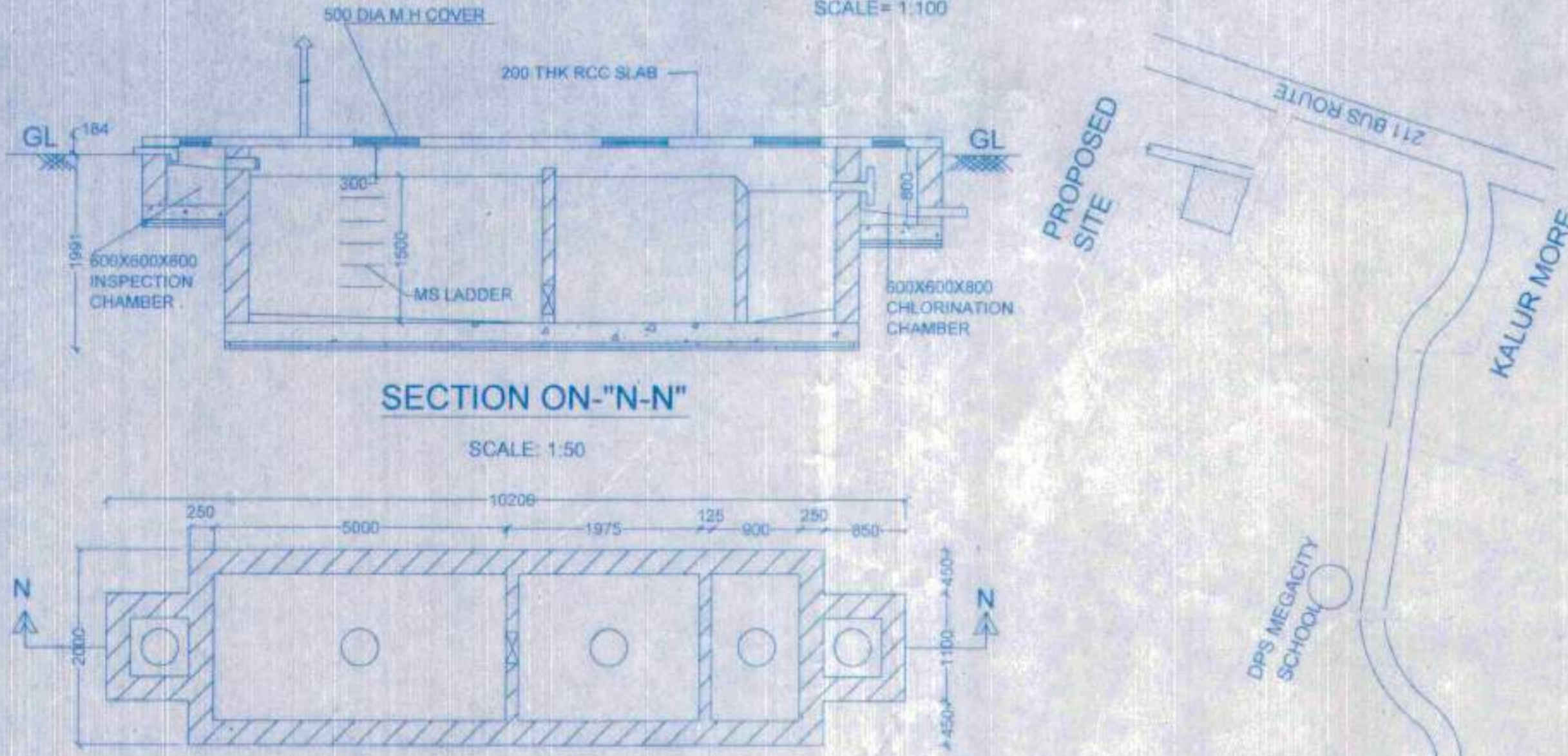

SECTION ON "N-N"

SCALE: 1:50

DETAILS OF SEPTIC TANK

150 USERS

SCALE = 1 : 50

PROPOSED G+IV STORIED RESIDENTIAL BUILDING PLAN OF A LAND OF 1) SK. NASIR, 2) RUPSA BIBI, 3) SHISHIR GUPTA, 4) VINITA GUPTA, 5) REALTECH HOUSING COMPANY, 6) REALITY DEVELOPMENT & CO. 7) R.B. DEVELOPMENT COMPANY, 8) N.R. CONSTRUCTIONS COMPANY. SITUATED AT RS/LR. DAG NOS: 686,689 & 690. LR KHATIAN NOS: 128, 1141, 3203, 3204, 3207, 3208, 3210, 3212, 3213, & 3225. MOUZA: KALIKAPUR, JL NO: 40, POLICE STATION: RAJARHAT, DIST: NORTH 24 PARGANAS, UNDER PATHARGHATA GRAM PANCHAYET.

AREA STATEMENT:

- AREA OF LAND=44K-14CH-15 SFT (3003.022 SQM)
PERMISSIBLE F.A.R.= 2.25 (6756.799 SQM)
PROPOSED F.A.R.= 2.239(6725.24 SQM)
1) COVERED AREA OF GROUND FLOOR: 1497.51 SQM (49.86%)
2) COVERED AREA OF TYPICAL FLOOR= 1751.35 SQM
3) LEFT OPEN AREA = 1505.51 SQM
4) PROPOSED CAR PARKING : 74 NOS

TENEMENT AREA

- 38= 41.01 SQM, 40= 42.30 SQM, 41= 42.30 SQM, 42= 41.01 SQM, 43= 41.01 SQM, 44= 42.30 SQM, 45= 42.30 SQM, 46= 41.01 SQM, 47= 41.01 SQM, 48= 42.30 SQM, 49= 42.30 SQM, 50= 41.01 SQM, 51= 41.91 SQM, 52= 42.30 SQM, 53= 42.30 SQM, 54= 41.01 SQM, 55= 40.85 SQM, 56= 41.22 SQM, 57= 41.22 SQM, 58= 40.85 SQM, 59= 43.20 SQM, 60= 43.20 SQM, 61= 40.85 SQM, 62= 41.22 SQM, 63= 41.22 SQM, 64= 40.85 SQM, 65= 40.85 SQM, 66= 41.22 SQM, 67= 41.22 SQM, 68= 40.85 SQM, 69= 44.32 SQM, 70= 44.32, 71= 40.85 SQM, 72= 41.22 SQM, 73= 41.22 SQM, 74= 40.85 SQM

CERTIFICATE OF ARCHITECT:

I certify that all the Architectural Drawing of the project at mouza - kalikapur, j.l. no - 40, Rs. dag nos: 686,689 & 690. L.R. kh. nos: 128, 1141, 3203, 3204, 3207, 3208, & Police station: Rajarhat. Dist: North 24 parganas, under patharghata gram panchayat. Kolkata Planning Area (Building) Rules, 2014. I also certify that the plans and drawings prepared by me complying with all the provisions regarding the Fire Protection as per the prevailing National Building Code of India. I shall be held responsible if any incorrect information is furnished by me or any violation of provisions of these rules or the prevailing National Building Code is found in any of the drawing and documents, signed by me and submitted to the Sanctioning Authority for obtaining sanction.

Signature of Architect: BIJAY KUMAR JANA, Registered Architect, Regd. No. - CA/98/22803, Council of Architecture.

CERTIFICATE OF STRUCTURAL ENGINEER:

Certified that the structural drawing and design of both the foundation and superstructure of the building has been made considering the Soil Test Report, as per the rules and regulations made under the Act and also considering all possible loads, seismic load and the moments generated by the proposed structure as per the Bureau of Indian Standard and National Building Code of India and certified that it is safe and stable in respect and these provisions shall be adhered to during the construction.

Signature of Structural Engineer: DR. DIPESH MAJUMDAR, PhD in Civil Engineering, MIE, ME (Structure), BE.

CERTIFICATE OF OWNER:

CERTIFIED THAT I HAVE GONE THROUGH THE NATIONAL BUILDING CODE OF INDIA AND ALSO ABIDE BY THOSE RULES DURING AND AFTER CONSTRUCTION OF THE BUILDING

Signature of Owners: ASHANA CONSTRUCTORS, Sh. N.C.

CERTIFICATE OF GEO-TECHNICAL ENGINEER:

THIS IS TO CERTIFY THAT THE SOIL TEST HAS BEEN PERFORMED BY ME TO THIS PROJECT.

Signature of Geo-Technical Engineer: S. Sar, SUDJOY SARKAR, B.C.E., M.C.E. (L&I), M.S.E., M.A.S.C.E., (GEO) TECHNICAL ENGINEER, R.M.C. Class-I, License No- 20.

DOOR WINDOW SCHEDULE:

Table with columns MKD, WIDTH, HEIGHT for Doors and Windows. Includes entries like D1 (1050 x 2100), W1 (1500 x 1200).

NOTE:

1) ALL OUTER WALLS SHALL BE 300 MM THK. ALL PARTITION WALLS SHALL BE 100 MM THK. ALL INTERIOR PARTITION WALLS SHALL BE 100 MM THK. SURFACE OF CONCRETE SHALL BE FINISHED WITH 15MM SANDWICH FINISHES.

SHEET NO: 1, DWG BY: CKD BY: FOR OFFICE USE.

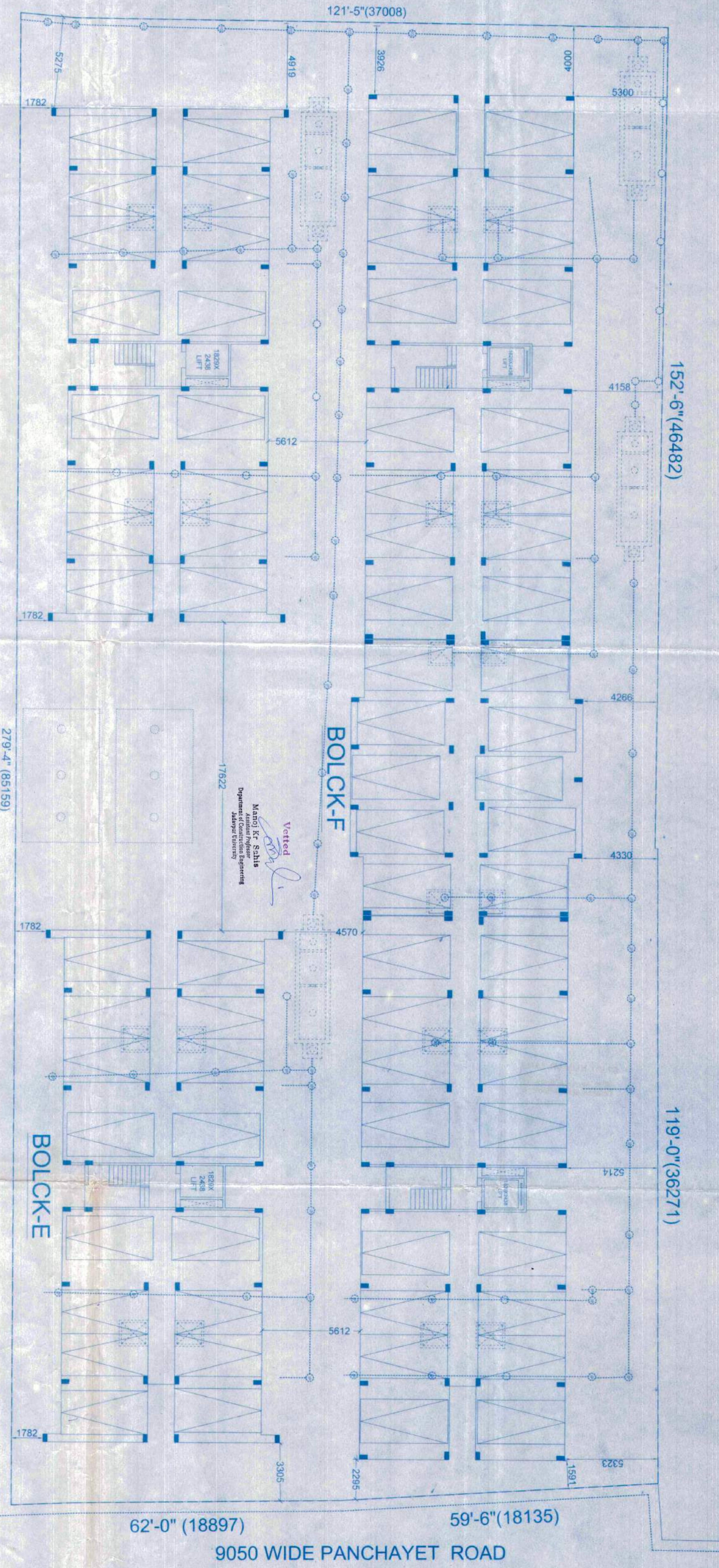

The structural analysis reports & soil reports are kept for reference in this office. The clearance is accorded subject to certificate of approved, Str. Engineer, Geo-Tech Engineer.

Sanctioned & Approved: 14/08/18, Executive Officer, Rajarhat Panchayat Samity.