

2388, 2416, L.R. KHATAN NOS 3821, 3822, 3823, 3824, 3825, 3826, 3827, 3828, 3829, 3830, 3831, 3832, 3833, 3834, HOLDING NO 3860 KUSUMBA WARD NO. 08, UNDER RAJPUR SONARPUR MUNICIPALITY, P.S. SONARPUR DIST - SOUTH 24- PARGANAS.

RIVA
19AAFC
gal

AREA OF LAND :- 78.20 KATTAHS EQUIVALENT TO 129 DECIMALS (MORE OR LESS SHOWN IN RED COLOUR)

OTMENT



FOR BANAJ DEVELOPERS PRIVATE LIMITED
AS CONSTITUTED AT THE OFFICE OF
DAFFODIL TOWER PRIVATE LIMITED
BRIGHTFUL RESIDENCY PRIVATE LIMITED
PRAYAGREE REALTORS PRIVATE LIMITED
PREMA VILINCLAVE PRIVATE LIMITED
SARINA VILINCLAVE PRIVATE LIMITED
SOLAR REAL ESTATE PRIVATE LIMITED

ABDUL KHAI EK MOHALLA
BADRA ALAM MOHALLA
NAJIR HOSSAIN MOHALLA
NASIR SARDAR
ABUL KALAM HALDER
AYUB HALDER
REHANA BIBI

C.S. Khatun
DIRECTOR

L.R. DAG NO. 2277

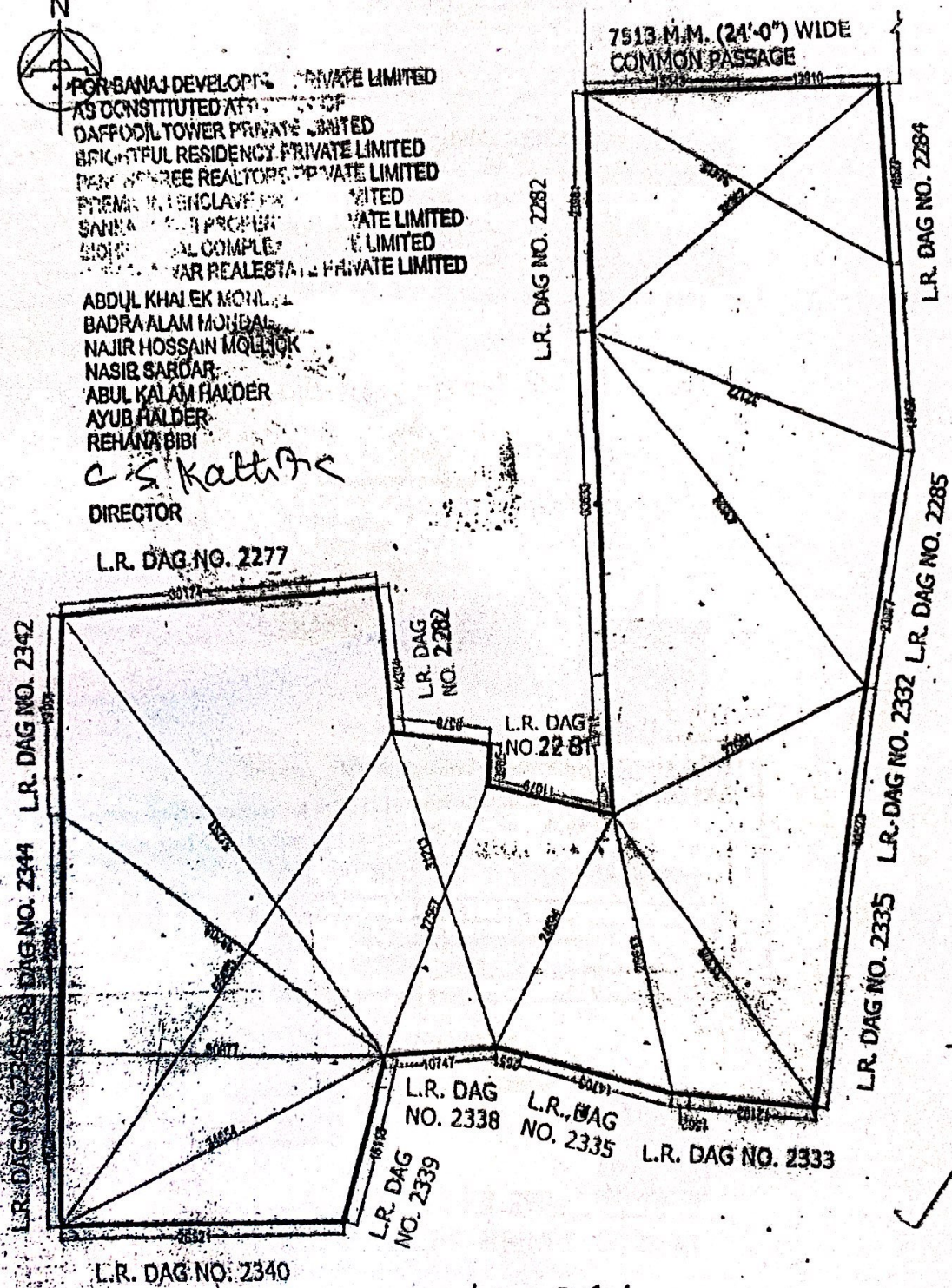

In the
Kolkata

Develop
it of y
i via th
condit

purpo

TA &
ICO

629
mai

LONGITUDE: 22.446296, 88.410791
LATITUDE: 22.446048, 88.410716



*Traced By:
S. Apurva
3B, Nagpur
Kolkata*