

PREMISES NO:-72, ABINASH CHANDRA BANERJEE LANE,  
WARD NO:- 34,BOROUGH :- III, KOLKATA- 700 010,UNDER KMC.

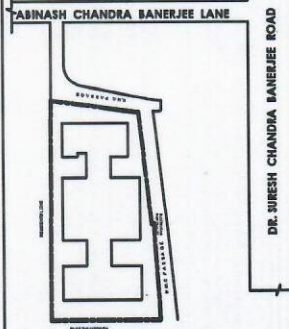

KEY PLAN



LEGEND:-

BOUNDARY LINE	—
BUILDING LINE	—
ROAD	—

NOTES:-

ALL DIMENSION ARE IN METER  
OTHERWISE STATED

TOTAL AREA OF LAND=953.404 SQ.M.  
(14 K.- 4 CH.- 2.40 SFT)



22°33'52.89"N  
88°23'31.66"E

K.M.C P A S S A G E

22°33'52.34"N  
88°23'31.41"E

22°33'52.51"N  
88°23'30.58"E

22°33'52.48"N  
88°23'30.57"E

K.M.C P A S S A G E

22°33'52.60"N  
88°23'29.89"E

RESIDENTIAL ZONE

22°33'53.34"N  
88°23'30.12"E

RESIDENTIAL ZONE