

SCHEDULE OF DOOR & WINDOW-

SL.NO.	MRD.	WIDTH	HEIGHT
1.	W1	2400	2350
2.	W2	2100	2350
3.	W3	2000	2350
4.	W4	600	600
1.	D	1500	2100
2.	D1	1200	2100
3.	D2	950	2100
4.	D3	750	2100

REVISED G+V STORIED RESIDENTIAL BUILDING PLAN AT MOUZA - JATRAGACHI, J.L. NO.-24, R.S. NO.-195, TOUZI NO.- 10, R.S. & L.R. DAG NO.- 985, 986, 1016, 1019, & 1020, R.S. KHATIAN NO.- 55, 257, 575, & 69, 1426, P.S. - NEW TOWN, DIST.- 24 PGS. (NORTH), UNDER JYANGRA HATIARA 2- NO. GRAM PANCHAYET.

NAME OF OWNER'S

SMT. DOLLY MONDAL
SRI SUJOY KRISHNA MONGAL

AREA STATEMENT

AREA OF LAND AS PER DEED - (14 K-03 CH - 23 SFT) 951.97 SQ.M
 AREA OF LAND AS PER PHYSICAL (14 K-03 CH - 23 SFT) = 951.97 SQ.M
 PROPOSED GROUND FLOOR COVERAGE 415.24 SQ.M
 BLOCK - A 176.66 SQ.M
 BLOCK - C 139.92 SQ.M / BLOCK - D 98.66 SQ.M

BLOCK A
(1ST, 2ND, 3RD & 4TH) FLOOR
 FLAT A = 77.93 SQ.M
 FLAT B = 67.87 SQ.M
 STAIR & LIFT = 30.86 SQ.M

BLOCK C
(1ST, 2ND, 3RD & 4TH) FLOOR
 FLAT A = 38.31 SQ.M
 FLAT B = 41.83 SQ.M
 FLAT C = 36.93 SQ.M
 STAIR & LIFT = 23.05 SQ.M

BLOCK D
(1ST, 2ND, 3RD & 4TH) FLOOR
 FLAT A = 38.47 SQ.M
 FLAT B = 42.84 SQ.M
 STAIR & LIFT = 17.35 SQ.M

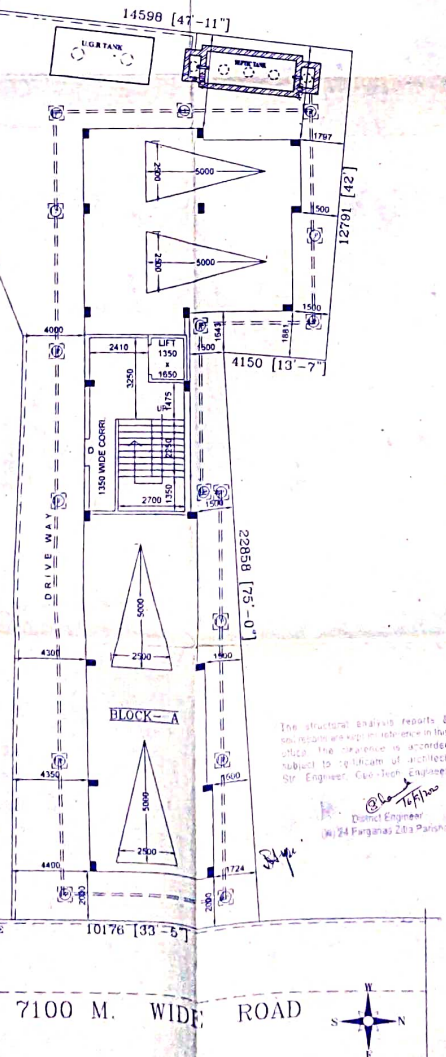
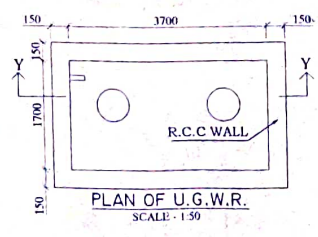
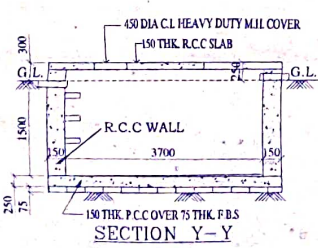
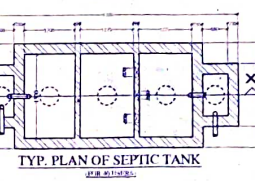
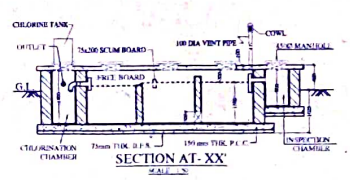

The structural Engineer certifies & shall not be responsible for any errors or omissions in this plan. The Engineer is not responsible for any errors or omissions in this plan. The Engineer is not responsible for any errors or omissions in this plan.

Jayendra Prasad Singh

SIG OF OWNERS
DECLARATION OF ARCHITECT

I CERTIFY THAT ALL ARCHITECTURAL DRAWING OF THE BUILDING AT MOUZA - JATRAGACHI, J.L. NO.-24, R.S. NO.-195, TOUZI NO.- 10, R.S. & L.R. DAG NO.- 985, 986, 1016, 1019, & 1020, R.S. KHATIAN NO.- 55, 257, 575, & 69, 1426, P.S. - NEW TOWN, DIST.- 24 PGS. (NORTH), UNDER JYANGRA HATIARA 2- NO. GRAM PANCHAYET.

PREPARED BY ME COMPLYING WITH THE NEW TOWN PLANNING AREA (BUILDING) RULES 2014.
 NO SUCH WRONG AND INCORRECT INFORMATION HAS BEEN FURNISHED BY ME INCLUDING AREA CALCULATION CHARTS IN THE DRAWING AND NO VIOLATION OF THE PROVISION OF THESE RULES WILL BE FOUND IN ANY OF THE DRAWINGS AND DOCUMENTS, SUBMITTED TO THE SANCTIONING AUTHORITY FOR OBTAINING SANCTION.

Jayendra Prasad Singh
 Jayendra Prasad Singh
 District Engineer
 U.S. CIVIL ENGINEER
 The Kolkata Municipal Corporation

SANCTIONED & APPROVED
 Executive Officer
 Rajahmundry Panchayat
 Approval Order No. 1215/RPS
 Date: 05/10/2020
 Valid up to: 07/10/2025

SIG OF ARCHITECT/ENGINEER

DECLARATION OF ENGINEER
 THE STRUCTURAL DESIGN AND DRAWINGS OF BOTH FOUNDATION AND SUPERSTRUCTURE OF THE BUILDING AT MOUZA - JATRAGACHI, J.L. NO.-24, R.S. NO.-195, TOUZI NO.- 10, R.S. & L.R. DAG NO.- 985, 986, 1016, 1019, & 1020, R.S. KHATIAN NO.- 55, 257, 575, & 69, 1426, P.S. - NEW TOWN, DIST.- 24 PGS. (NORTH), UNDER JYANGRA HATIARA 2- NO. GRAM PANCHAYET. HAS BEEN MADE BY ME CONSIDERING ALL POSSIBLE LOADS INCLUDING THE SEISMIC LOAD AS PER NATIONAL BUILDING CODE OF INDIA 2000 AS AMENDED FROM TIME TO TIME AND CERTIFY THAT IT IS SAFE AND STABLE IN ALL RESPECTS.

Sudhasril Bhalumik
 SUDHASRIL BHALUMIK
 B. ENG. CIVIL ENGRG. (1983)
 M.T.E. (1978) R. (L. & S. 1977)
 CIVIL ENGINEER (REGD. NO. 1215/RPS)
 M-584/65762

SIG OF STRUCTURAL ENGINEER