

SITE PLAN PART OF C.S. DAG-67103, P.S. - SONARPUR, M. - 30.81. OF MOUZA - NATAGACHHI. S.L.NO. - 37. SCALE 1" = 200'

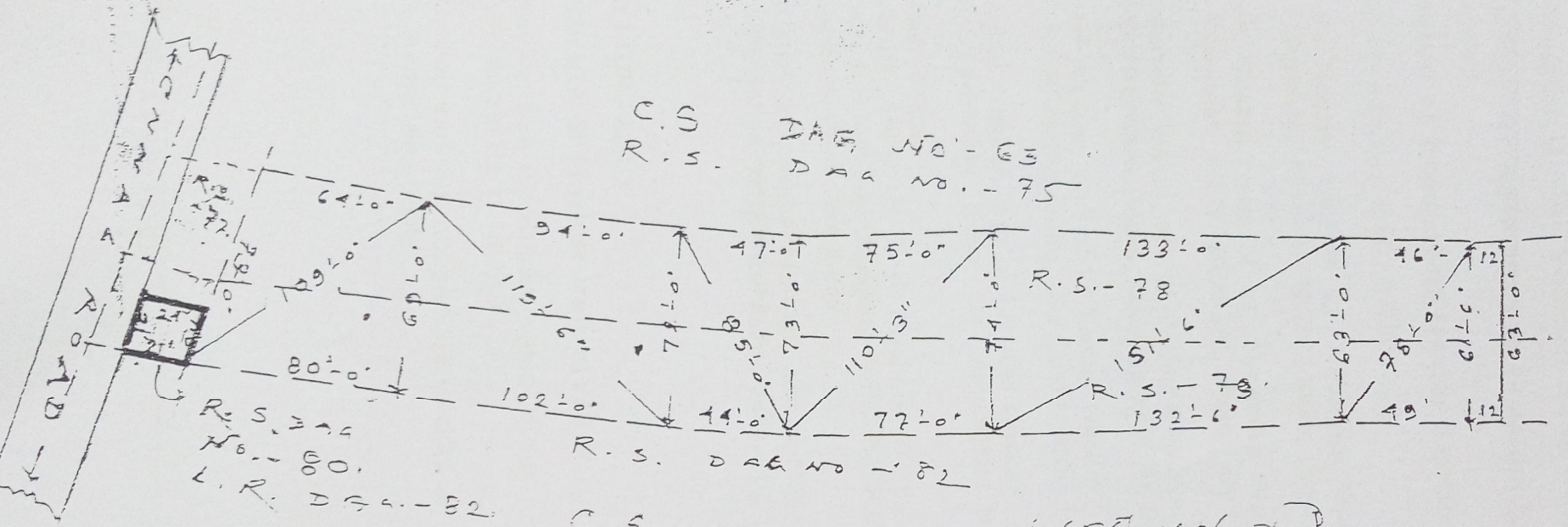

C.S. DAG NO - 65

(Signature)
 (Signature)
 (Signature)
 (Signature)

REFERENCES:-

- R.S. LINE SHOWN THUS:
- SOLD AREA COLOUR OF 'RED' BORDER.
- R.S. DAG → AREA
- 78, 79 → 77 DEC (M/L)
80. - AREA - 1 DEC. (M/L)

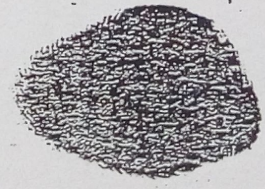

(Signature)
 (Signature)

BGA REAL
 (Signature)