

SITE PLAN OF PREMISES NO. - 75/2A, HAZRA ROAD , WARD NO - 85, BOROUGH - VIII , P.S. - LAKE , KOLKATA - 700 029.
 NET LAND AREA (8 K.-10 CH.- 32.09 SQ.FT.) = 579.904 SQ.M. (M/L)

SCALE-1:400

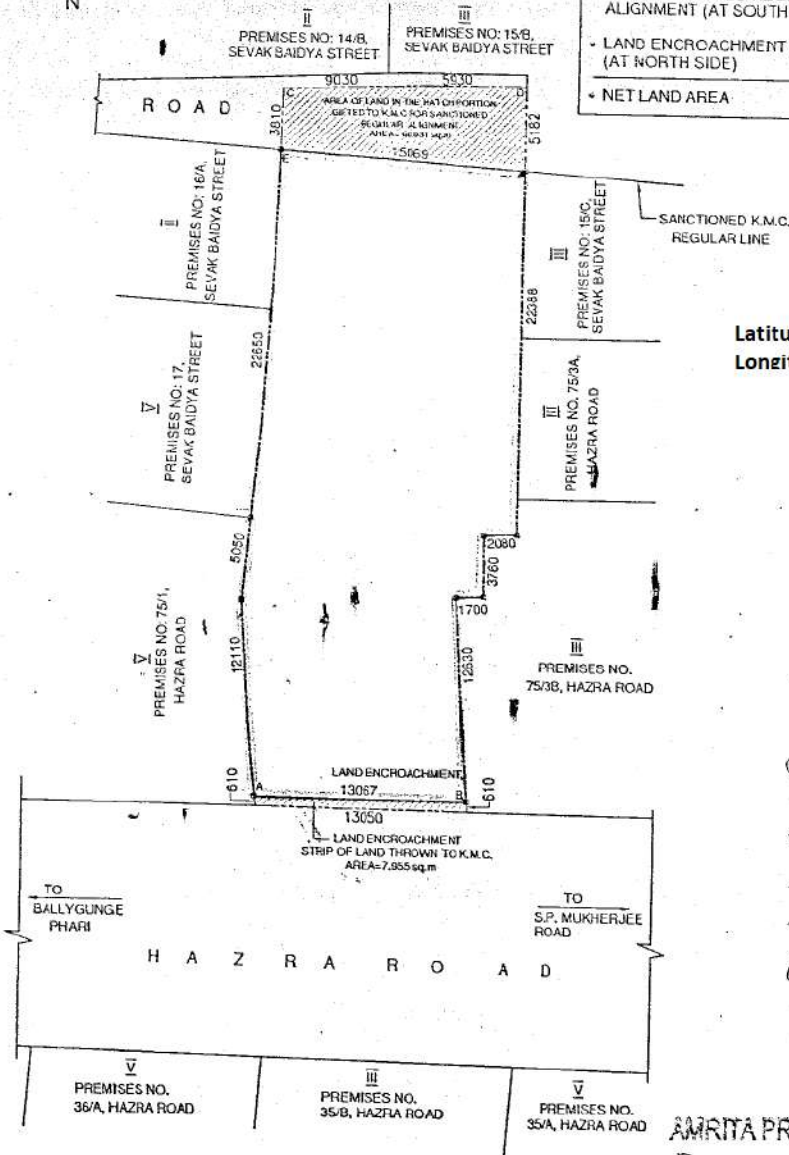

• LAND AREA AS PER DEED	= 655.890 SQ.M.
• AREA OF LAND GIFTED TO K.M.C FOR SANCTIONED REGULAR ALIGNMENT (AT SOUTH SIDE)	= 68.031 SQ.M.
• LAND ENCROACHMENT AREA (AT NORTH SIDE)	= 7.955 SQ.M.
• NET LAND AREA	= 579.904 SQ.M.



Latitude-22.524619
 Longitude-88.354217

Debabrati Banerjee

DEBABRATA BANERJEE
 Director of Amrita Promoters Pvt. Ltd.,
 Constituted Attorney of Naresh Kumar
 De & Saroj Kumar De, Executors to the
 Estate of Dilip Kumar De

AMRITA PROMOTERS PVT. LTD

Debabrati Banerjee
 Director

Suresh K. Agarwal
SURESH KUMAR AGARWAL, Director
 of Rochita Towers and Estates Pvt. Ltd.,
 Constituted Attorney of Naresh Kumar De
 & Saroj Kumar De, Executors to the Estate
 of Dilip Kumar De

ROCHITA TOWERS AND ESTATES PVT. LTD.

Suresh K. Agarwal
 Director
 SIGNATURE OF OWNERS

Debatosh Sarju
DEBATOSH SARJU
 Architect • Urban Designer
 M.ARCH. FIA. FIIDI. A.I.D.
 Regn. No. CA/89/12368