

SITE PLAN FOR PROP. G + IV STD. RESIDENTIAL FLAT TYPE BUILDING OF SRI ANIRUDDHA DUTTA, S/O SRI ALOKE KUMAR DUTTA, AT MOHALLA :- BOREHAT, HOLDING NO. :- 55, WARD NO. :- 28, MOUZA - BARDHAMAN, J.L. NO. :- 30, R.S. PLOT NO. :- 472, L.R. PLOT NO. :- 3237, R.S. KH NO. :- 136, L.R. KH NO. :- 19578, UNDER BURDWAN MUNICIPALITY, P.S. - BURDWAN, DIST. - PURBA BARDHAMAN.

**AREA OF LAND - 2819.74 SFT.
NATURE OF LAND - BASTU**

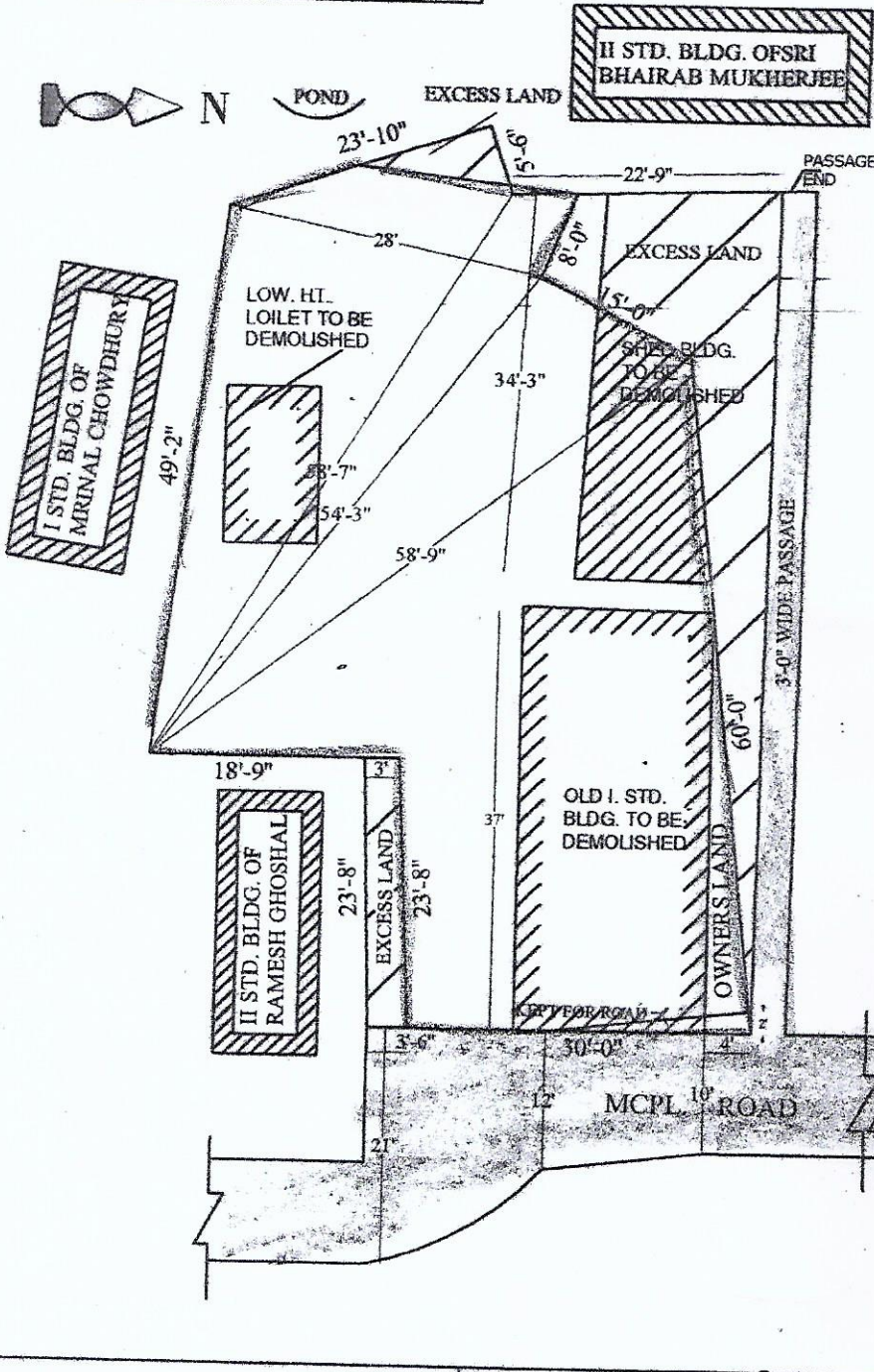

5/10/18

ENGINEER
Burdwan Municipality

5/10/18

HEALTH OFFICER

PROP. LINE SHOWN IN COL. - ○
 EXT. CONST. SHOWN IN COL. - ○
 ROAD SHOWN IN COL. - ○
 DRAIN SHOWN IN COL. - ○

Aniruddha Dutta

Uttan Kumar

5/10/18

SIG. OF OWNER

DRAWN BY

Chairman
Burdwan Municipality
CHANDRANATH