





SITE PLAN FOR PROP. G + IV STD. RESIDENTIAL FLAT TYPE BUILDING OF 1) SRI BISWAJIT DAS, 2) SRI ARABINDA DAS, BOTH ARE S/O KALIPADA DAS, & 3) SMT. BASANTI DAS (BANK), D/O KALIPADA DAS, AT MOUZA - ICHLABAD, J.L. NO.:- 75, L.R. PLOT NO.:- 2291, L.R. KH NO.:- 9658, 9375, & 1845 R.S. PLOT NO.:- 831/2619, C.S. PLOT NO.:- 831(P), L.O.P. NO.:- 255, MAHALLA :- ICHLABAZAR, WARD NO.:- 11, HOLDING NO.:- 291, UNDER BURDWAN MUNICIPALITY, P.S. - BURDWAN, DIST.- PURBA BARDHAMAN.

- PROP. LINE SHOWN IN COL. - 
- EXT. CONST. SHOWN IN COL. - 
- ROAD SHOWN IN COL. - 
- DRAIN SHOWN IN COL. - 

AREA OF LAND - 4173.32 SFT.
NATURE OF LAND - BASTU

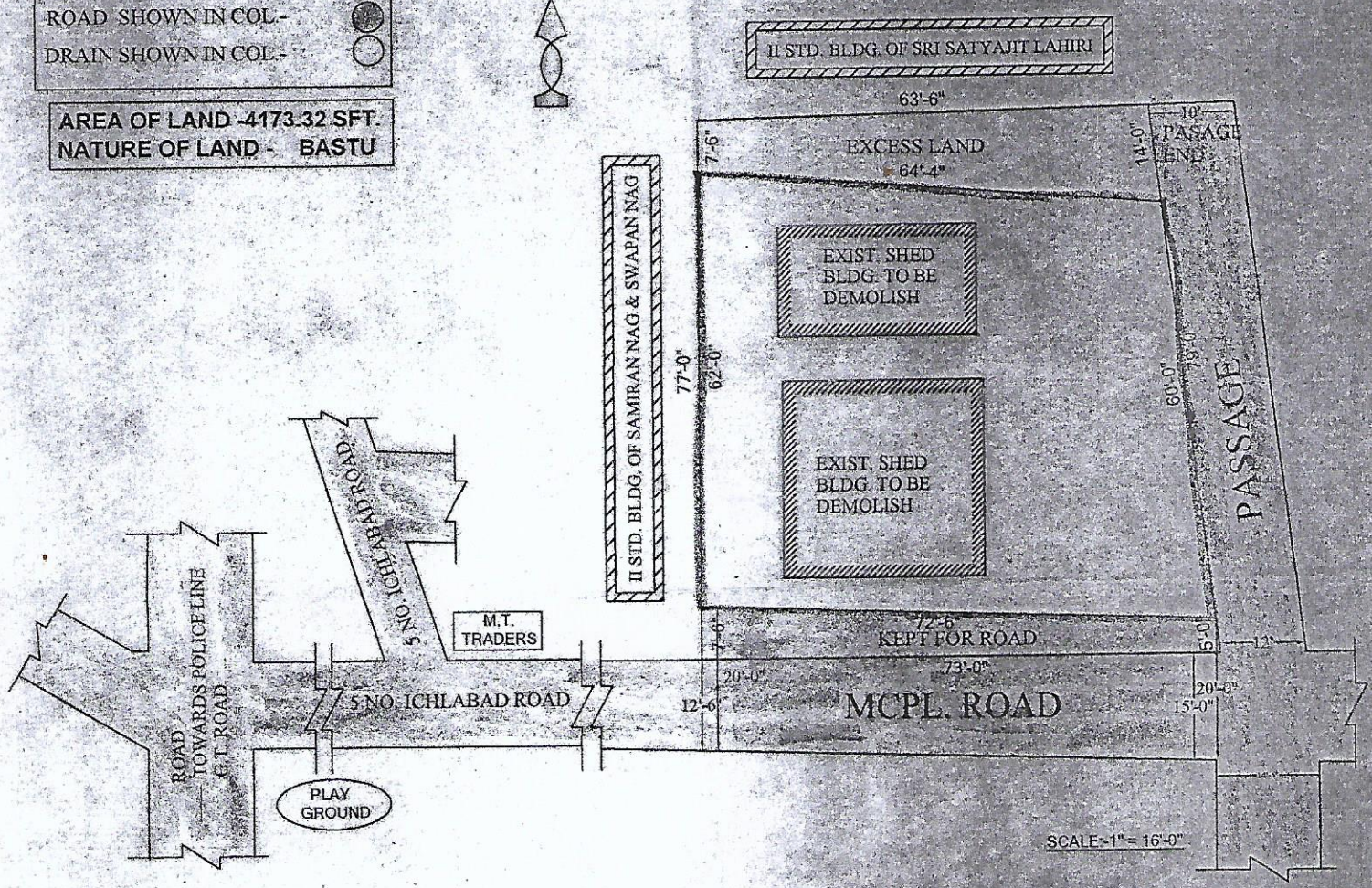

<p><i>Aravinda Das</i></p> <p>বিস্বজিৎ দাস</p>	<p><i>G. M. Sheikhulla</i> 12/10/18</p> <p>Vice-Chairman Burdwan Municipality</p>	<p><i>M. Topal</i> 12/10/18</p> <p>HEALTH OFFICER</p>
<p><i>Biswajit Das</i></p> <p>SIG. OF OWNER</p>	<p><i>Uttan Kumar</i></p> <p>DRAWN BY</p>	<p><i>ab</i> 12/10/18</p> <p>A.E. (B.M.)</p>