

SHOWING THE PLAN OF DEED OF AMALGAMATION OF FIVE PLOTS SITUATED AT MOUZA - JHOREHAT, J.L. NO - 30, P.S. - SANKRAIL, WITHIN THE AREA OF JHOREHAT GRAM PANCHAYET AT PRESENT BANUPUR - II NO GRAM PANCHAYET, DISTRICT - HOWRAH - 711302

AS FOLLOWS

Sl. NO.	NAME OF THE LAND OWNERS	MARK	R.S. DAG Nos	L.R. KH. Nos	L.R. DAG Nos	DEC. (As Per DEED)	DEC. (As Per FOR (L.R.))	AREA OF LAND K - CH - SFT
01.	SRI SOURAV KUMAR BARAL ● SRI SOURAV BARAL	'A' 'A1'	789	4490 Deriving from 574, 95, 167, 2657, 228	858	08.00	08	04 - 13 - 19
			788		857	03.42	04	02 - 06 - 32
						11.42	12	07 - 04 - 06
02.	SRI RAHUL BARAL	'B' 'B1'	789	3994 Deriving from 1539, 2875, 933	858	08.00	08	04 - 13 - 19
			781		850	02.32	02	01 - 03 - 16
						10.32	10	04 - 00 - 35
03.	SMT. RUMA BARAL	'C'	789	3913 Deriving from 1539 & 2875	858	08.00	08	04 - 13 - 19
TOTAL AREA OF LAND						29.74	30	18 - 02 - 15

SHOWN IN COLOUR RED BORDER LINE

N
SCALE : 1"=20'-0"

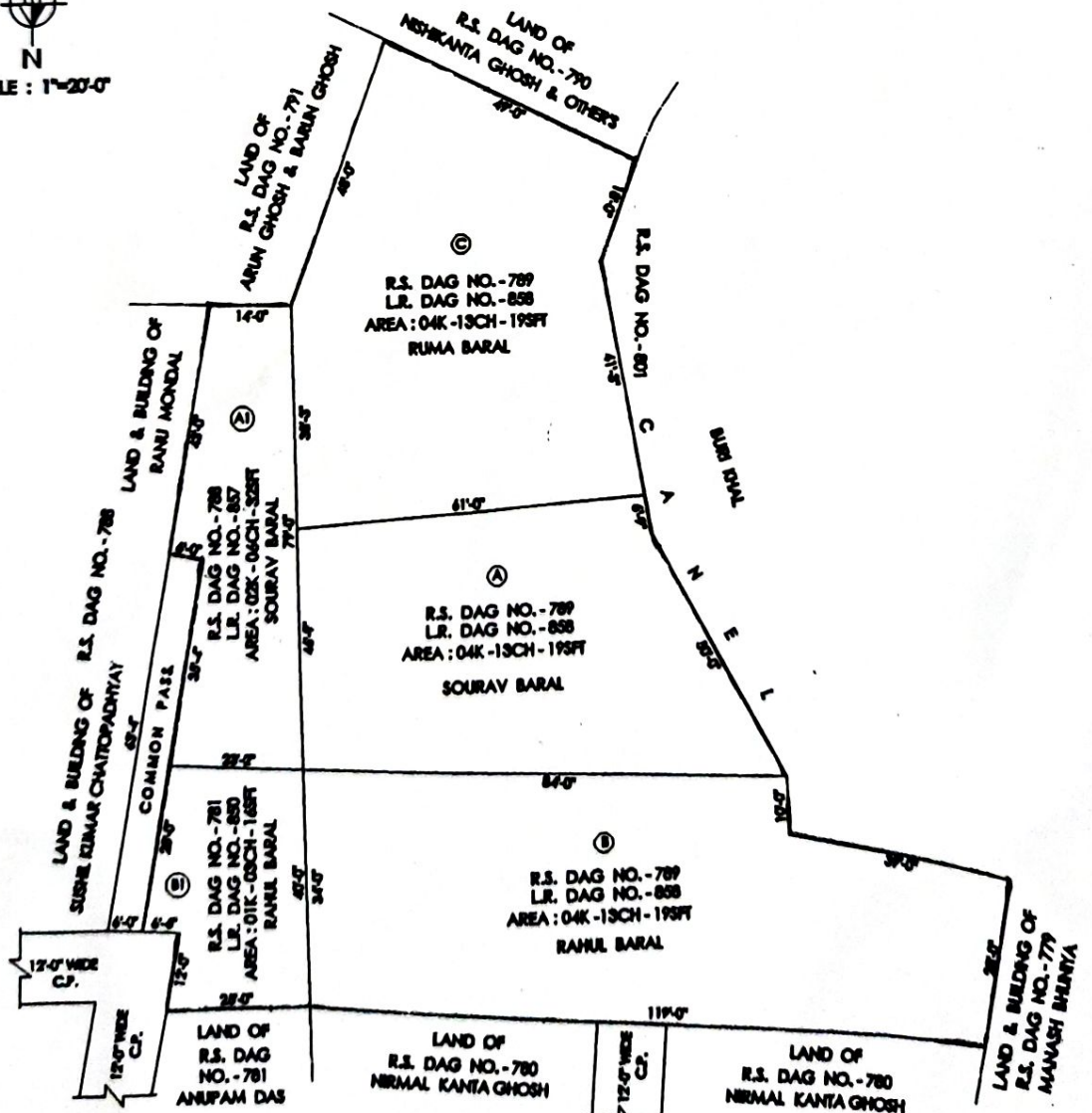

Tanmay Kanrar
TANMOY KANRAR
BUILDING PLANNER,
ESTIMATOR & SUPERVISION,
REGD. NO. 113
ALAMPUR - HOWRAH