

MAHESHWARI & ASSOCIATES
 ARCHITECTS

PROJECT: CHARTER HOUSE APARTMENTS
 LOCATION: 101, 102, 103, 104, 105, 106, 107, 108, 109, 110, 111, 112, 113, 114, 115, 116, 117, 118, 119, 120, 121, 122, 123, 124, 125, 126, 127, 128, 129, 130, 131, 132, 133, 134, 135, 136, 137, 138, 139, 140, 141, 142, 143, 144, 145, 146, 147, 148, 149, 150, 151, 152, 153, 154, 155, 156, 157, 158, 159, 160, 161, 162, 163, 164, 165, 166, 167, 168, 169, 170, 171, 172, 173, 174, 175, 176, 177, 178, 179, 180, 181, 182, 183, 184, 185, 186, 187, 188, 189, 190, 191, 192, 193, 194, 195, 196, 197, 198, 199, 200, 201, 202, 203, 204, 205, 206, 207, 208, 209, 210, 211, 212, 213, 214, 215, 216, 217, 218, 219, 220, 221, 222, 223, 224, 225, 226, 227, 228, 229, 230, 231, 232, 233, 234, 235, 236, 237, 238, 239, 240, 241, 242, 243, 244, 245, 246, 247, 248, 249, 250, 251, 252, 253, 254, 255, 256, 257, 258, 259, 260, 261, 262, 263, 264, 265, 266, 267, 268, 269, 270, 271, 272, 273, 274, 275, 276, 277, 278, 279, 280, 281, 282, 283, 284, 285, 286, 287, 288, 289, 290, 291, 292, 293, 294, 295, 296, 297, 298, 299, 300, 301, 302, 303, 304, 305, 306, 307, 308, 309, 310, 311, 312, 313, 314, 315, 316, 317, 318, 319, 320, 321, 322, 323, 324, 325, 326, 327, 328, 329, 330, 331, 332, 333, 334, 335, 336, 337, 338, 339, 340, 341, 342, 343, 344, 345, 346, 347, 348, 349, 350, 351, 352, 353, 354, 355, 356, 357, 358, 359, 360, 361, 362, 363, 364, 365, 366, 367, 368, 369, 370, 371, 372, 373, 374, 375, 376, 377, 378, 379, 380, 381, 382, 383, 384, 385, 386, 387, 388, 389, 390, 391, 392, 393, 394, 395, 396, 397, 398, 399, 400, 401, 402, 403, 404, 405, 406, 407, 408, 409, 410, 411, 412, 413, 414, 415, 416, 417, 418, 419, 420, 421, 422, 423, 424, 425, 426, 427, 428, 429, 430, 431, 432, 433, 434, 435, 436, 437, 438, 439, 440, 441, 442, 443, 444, 445, 446, 447, 448, 449, 450, 451, 452, 453, 454, 455, 456, 457, 458, 459, 460, 461, 462, 463, 464, 465, 466, 467, 468, 469, 470, 471, 472, 473, 474, 475, 476, 477, 478, 479, 480, 481, 482, 483, 484, 485, 486, 487, 488, 489, 490, 491, 492, 493, 494, 495, 496, 497, 498, 499, 500, 501, 502, 503, 504, 505, 506, 507, 508, 509, 510, 511, 512, 513, 514, 515, 516, 517, 518, 519, 520, 521, 522, 523, 524, 525, 526, 527, 528, 529, 530, 531, 532, 533, 534, 535, 536, 537, 538, 539, 540, 541, 542, 543, 544, 545, 546, 547, 548, 549, 550, 551, 552, 553, 554, 555, 556, 557, 558, 559, 560, 561, 562, 563, 564, 565, 566, 567, 568, 569, 570, 571, 572, 573, 574, 575, 576, 577, 578, 579, 580, 581, 582, 583, 584, 585, 586, 587, 588, 589, 590, 591, 592, 593, 594, 595, 596, 597, 598, 599, 600, 601, 602, 603, 604, 605, 606, 607, 608, 609, 610, 611, 612, 613, 614, 615, 616, 617, 618, 619, 620, 621, 622, 623, 624, 625, 626, 627, 628, 629, 630, 631, 632, 633, 634, 635, 636, 637, 638, 639, 640, 641, 642, 643, 644, 645, 646, 647, 648, 649, 650, 651, 652, 653, 654, 655, 656, 657, 658, 659, 660, 661, 662, 663, 664, 665, 666, 667, 668, 669, 670, 671, 672, 673, 674, 675, 676, 677, 678, 679, 680, 681, 682, 683, 684, 685, 686, 687, 688, 689, 690, 691, 692, 693, 694, 695, 696, 697, 698, 699, 700, 701, 702, 703, 704, 705, 706, 707, 708, 709, 710, 711, 712, 713, 714, 715, 716, 717, 718, 719, 720, 721, 722, 723, 724, 725, 726, 727, 728, 729, 730, 731, 732, 733, 734, 735, 736, 737, 738, 739, 740, 741, 742, 743, 744, 745, 746, 747, 748, 749, 750, 751, 752, 753, 754, 755, 756, 757, 758, 759, 760, 761, 762, 763, 764, 765, 766, 767, 768, 769, 770, 771, 772, 773, 774, 775, 776, 777, 778, 779, 780, 781, 782, 783, 784, 785, 786, 787, 788, 789, 790, 791, 792, 793, 794, 795, 796, 797, 798, 799, 800, 801, 802, 803, 804, 805, 806, 807, 808, 809, 810, 811, 812, 813, 814, 815, 816, 817, 818, 819, 820, 821, 822, 823, 824, 825, 826, 827, 828, 829, 830, 831, 832, 833, 834, 835, 836, 837, 838, 839, 840, 841, 842, 843, 844, 845, 846, 847, 848, 849, 850, 851, 852, 853, 854, 855, 856, 857, 858, 859, 860, 861, 862, 863, 864, 865, 866, 867, 868, 869, 870, 871, 872, 873, 874, 875, 876, 877, 878, 879, 880, 881, 882, 883, 884, 885, 886, 887, 888, 889, 890, 891, 892, 893, 894, 895, 896, 897, 898, 899, 900, 901, 902, 903, 904, 905, 906, 907, 908, 909, 910, 911, 912, 913, 914, 915, 916, 917, 918, 919, 920, 921, 922, 923, 924, 925, 926, 927, 928, 929, 930, 931, 932, 933, 934, 935, 936, 937, 938, 939, 940, 941, 942, 943, 944, 945, 946, 947, 948, 949, 950, 951, 952, 953, 954, 955, 956, 957, 958, 959, 960, 961, 962, 963, 964, 965, 966, 967, 968, 969, 970, 971, 972, 973, 974, 975, 976, 977, 978, 979, 980, 981, 982, 983, 984, 985, 986, 987, 988, 989, 990, 991, 992, 993, 994, 995, 996, 997, 998, 999, 1000

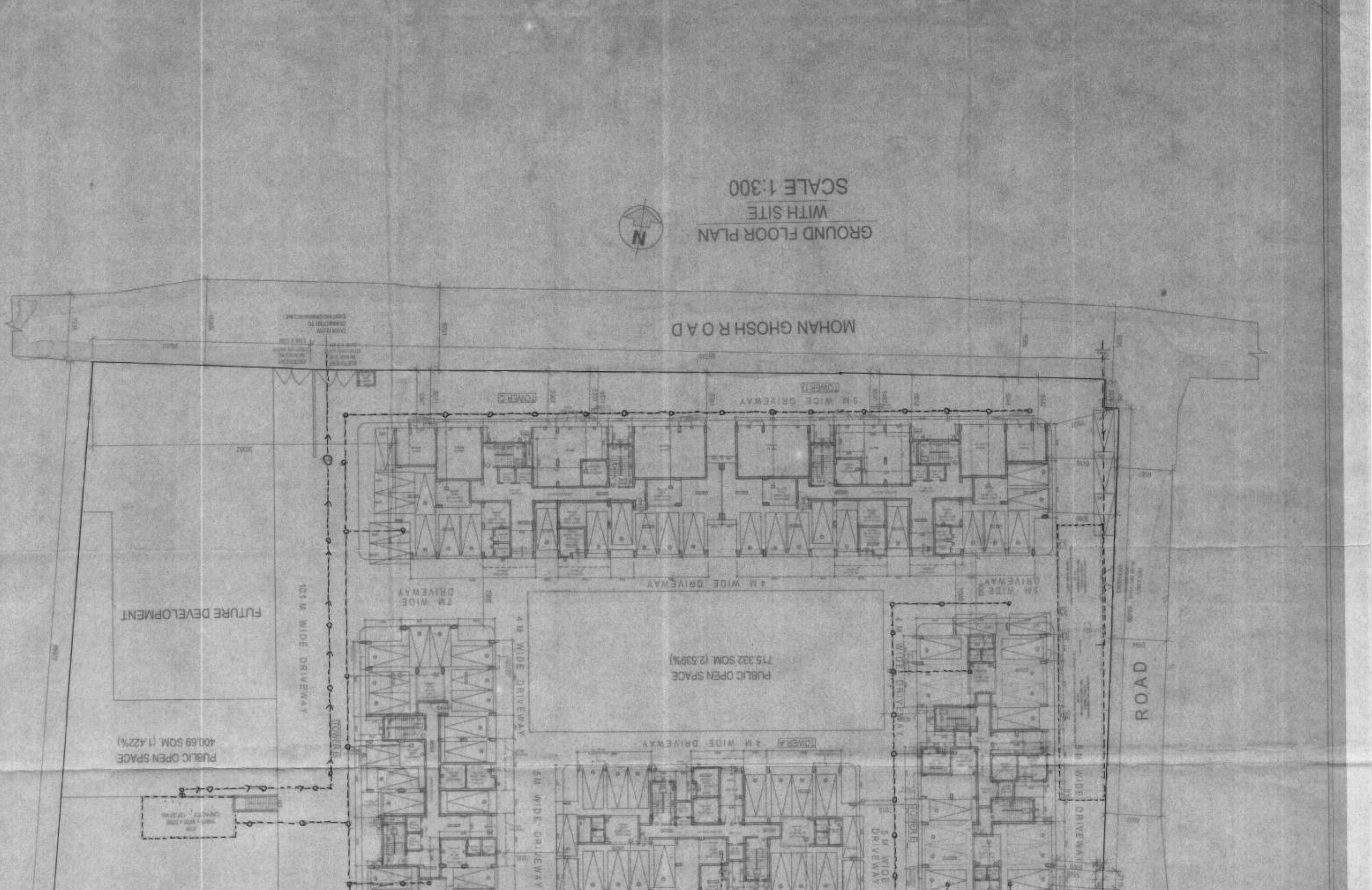

AREA STATEMENT

AREA OF LAND	28166.728	Sqm
PERMISSIBLE GROUND COVERAGE = 45%	12674.776	Sqm
PROPOSED GROUND COVERAGE = 8.93%	2516.279	Sqm
PERMISSIBLE FAR	2.250	
PROPOSED FAR	0.899	
PERMISSIBLE BUILT UP AREA	63372.869	Sqm
PERMISSIBLE HEIGHT OF BUILDING	40	m
PERMISSIBLE HEIGHT OF BUILDING (TOP OF SLAB)	25	m
PROPOSED HEIGHT OF BUILDING (TOP OF FEATURE)	30.9	m

PROPOSED FLOOR AREA	448790	Sqm
GROUND FLOOR AREA (TOWER A)	413190	Sqm
GROUND FLOOR AREA (TOWER B)	105220	Sqm
GROUND FLOOR AREA (TOWER C&D)	448790	Sqm
LESS FOR STAIR + LIFT BONUS (TOWER A)	-280880	Sqm
LESS FOR STAIR + LIFT BONUS (TOWER B)	-268800	Sqm
LESS FOR STAIR + LIFT BONUS (TOWER C&D)	-529680	Sqm
LESS FOR STAIR + LIFT BONUS (TOWER E)	-260880	Sqm
LESS FOR PARKING (TOWER A)	-259960	Sqm
LESS FOR PARKING (TOWER B)	-368277	Sqm
LESS FOR PARKING (TOWER C&D)	-429520	Sqm
LESS FOR PARKING (TOWER E)	-282030	Sqm
TOTAL LESS FOR PARKING	-1376767	Sqm
TOTAL AREA LESS FOR TOWER A, B, C, D, & E	2666.027	Sqm
PROPOSED BUILT UP AREA	18870.654	Sqm
FLOOR AREA RATIO (F.A.R.) COMPLIED	0.699	
CUP BOARD AREA (3% OF TOTAL FLR AREA EXCLUDING PARKING AREA)	547.843	Sqm
PROPOSED F.A.R.	0.699	
SHOP AREA	348.587	Sqm
PARKING REQUIRED FOR RESIDENCE	162.2	NOS
PARKING REQUIRED FOR SHOP	7.0	NOS
TOTAL PARKING REQUIRED	169.0	NOS

PERMISSIBLE PUBLIC OPEN SPACE	2253.258	Sqm
9%	=	
PROVIDED PUBLIC OPEN SPACE	4253.258	Sqm
7%	=	
REQUIRED FACILITIES	1971.601	Sqm
7.00%	=	
PROVIDED FACILITIES	1971.601	Sqm
7.00%	=	
RECORDED POND (WATERBODY) AREA	5644.116	Sqm
(1.37 ACRE)		

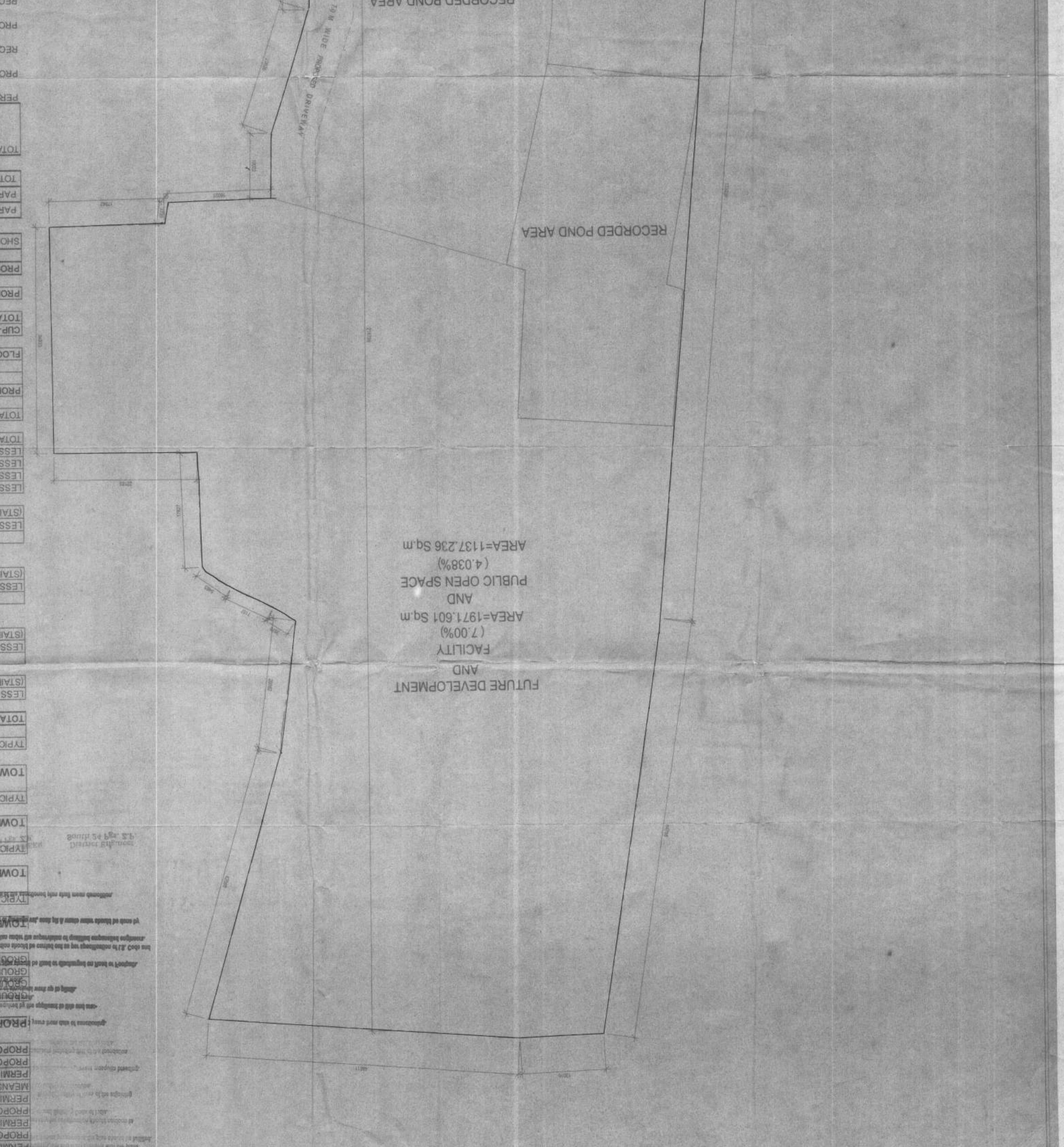

SCALE 1:300
 WITH SITE
 GROUND FLOOR PLAN



MOHAN GHOSH ROAD

ROAD

RECORDED POND AREA

RECORDED POND AREA

RECORDED POND AREA

FUTURE DEVELOPMENT
 AND
 FACILITY
 (7.00%)
 AREA=1971.601 Sq.m
 AND
 PUBLIC OPEN SPACE
 (4.038%)
 AREA=1137.236 Sq.m

CHECKED & VERIFIED

1. The Development Promoter is valid for 1 (one) year from the date of expiry of respective Authority (MUDA) license.
2. The Development Promoter shall not be entitled to transfer the land and other assets to any other person or entity.
3. The Development Promoter shall not be entitled to sub-license the land and other assets to any other person or entity.
4. All other terms and conditions of the license shall apply as stated in the license.

Assistant Planner
MUDA
K.M.D.A.

By: *[Signature]*
Director of Planning
MUDA

8.6.2016
9.7.16

Stationary Planning Unit
K.M.D.A.

105/23/2016
8.6.2016
8.6.2016

- After taking any conditions, the most common with the plan should be submitted to the Development Promoter for approval.
- All building materials used in the construction shall conform to the specifications and standards as prescribed in the plan.
- The Development Promoter shall not be entitled to sub-license the land and other assets to any other person or entity.
- The Development Promoter shall not be entitled to transfer the land and other assets to any other person or entity.
- The Development Promoter shall not be entitled to sub-license the land and other assets to any other person or entity.
- All other terms and conditions of the license shall apply as stated in the license.

SANCTIONED

ASSISTANT ENGINEER
District Engineer
South 24 Parganas

South 24 Parganas
District Engineer
South 24 Parganas

South 24 Parganas
District Engineer
South 24 Parganas

South 24 Parganas
District Engineer
South 24 Parganas