

MALDA PROJECTS Pvt.Ltd.

52/69, Rabindra Avenue, Malda. Pin- 732101.

E-mail : bhagat.kishor@yahoo.co.in Mob. No. 9434095057

PROJECT = BASUNDHARA GREEN

Latitude = $24^{\circ} 59' 38''$ N

Longitude = $88^{\circ} 08' - 26''$ E

NOTES:-

1. ALL MEASUREMENT ARE IN METRES.
2. AREA OF THE PLOT :-
 PLOT-01 :- 803.59 SQ.M OR 0.198 ACRES
 PLOT-02 :- 449.78 SQ.M OR 0.111 ACRES
 TOTAL AREA :- 1253.37 SQ.M OR 0.309 ACRES

LAND REF.N:-

PLOT-01
 MOUZA:- PIRAJPUR, J.L. NO:- 69
 L.R. DAG NO:- 6141
 L.R. KHATAN NO:- 2812, 4333, 4334 & 3245

PLOT-02
 MOUZA:- PIRAJPUR, J.L. NO:- 69
 L.R. DAG NO:- 6137
 L.R. KHATAN NO:- 2761, 3275, 5345, 6511 & 7081
 P.S.:- ENGLISH BAZAR, DIST.:- MALDA.



LEGEND

SYMBOL	DESCRIPTION
	STATION POINT/REF. POINT
	ELECTRIC POST
	BITUMENOUS ROAD
	PLOT BOUNDARY
	BOUNDARY WALL

COORDINATE LIST OF BOUNDARY POINT

COORDINATE			LINEAR MEASUREMENT	
BOUNDARY POINT	EASTING (X)	NORTHING (Y)	POINT	DISTANCE (M)
A	2496.229	4996.348	A-B	30.999
B	2472.607	5016.421	B-C	19.639
C	2483.959	5032.453	C-D	22.016
D	2502.749	5020.979	D-E	3.189
E	2505.423	5019.239	E-F	14.583
F	2515.919	5029.365	F-G	6.340
G	2520.940	5025.493	G-H	4.075
H	2518.132	5022.539	H-I	9.739
I	2512.038	5014.943	I-A	24.406
C	2483.959	5032.453	C-D	22.016
D	2502.749	5020.979	D-E	3.189
E	2505.423	5019.239	E-F	14.583
F	2515.919	5029.365	F-J	26.213
J	2497.842	5048.348	J-C	21.104

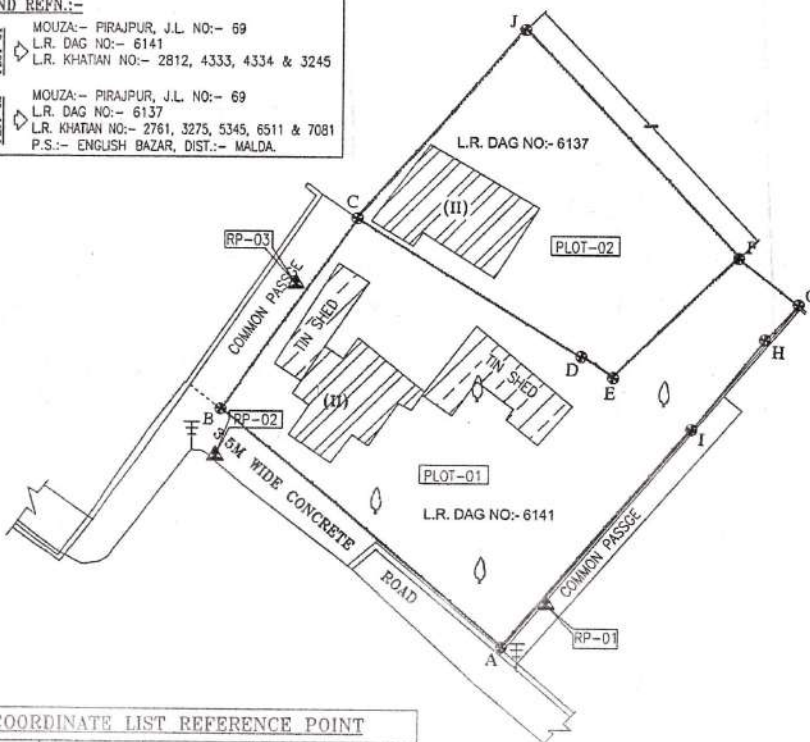

COORDINATE LIST REFERENCE POINT

REFR. POINT:-	EASTING (M)	NORTHING (M)	REDUCED LEVEL (M)
RP-01	2500.000	5000.000	100.000
RP-02	2472.195	5012.419	100.285
RP-03	2478.878	5026.990	100.193

CLIENT :-	MALDA PROJECTS PVT. LTD. 52/69, RABINDRA AVENUE, MALDA- 732101
SURVEYED BY :-	GEO-ARCH CONSULTANT. 48, R.B.S. ROAD BHADRESWAR, HOOGHLY. MOB. - 9283062945/9903975015.
DRG. TITLE :-	TOPOGRAPHICAL SURVEY FOR EXISTING PLOT AT PIRAJPUR, MALDA. (W.B)
DRAWING No.	DWN. BY:- B. DAS CHK. BY:- A3 SHEET NO. 1 OF 1 SCALE 1:300 DATE 08-08-18 REV. 00
GAC/MDT/06/02	

SITE PLAN LAYOUT OF A VACANT LAND AT - SINGATALA, ANI THE OWNERS ARE 1) BIMAN BEHARI PAL S/O LT BHUBANESHWAR PAL, 2) BHARATI PAL, W/O - LT. BASANTA BEHARI PAL, 3) RITANKAR PAL, 4) DIPTI REKHA PAL, W/O DEBOJYOTI PAL, 5) PARTHA SARATHI PAL, S/O - LT. BHUBANESHWAR PAL, H. NO. 60/207/13, W.NO.-05, MOUZA-PIROJPUR, JL NO.-69, L.R. PLOT NO.-6141, L.R. KHATIAN NO.- 2812, 4333, 4334, 3245, UNDER ENGLISH BAZAAR MUNICIPALITY, DIST.- MALDA.

AREA OF "A" :-
 $= 0.5 \times (7.673 + 6.339) \times 12.569$
 $= 88.058 \text{ SQM.}$

AREA OF "B" :-
 $= 0.5 \times (19.748 + 23.104) \times 30.991$
 $= 664.01 \text{ SQM.}$

AREA OF "C" :-
 $= 0.5 \times (1.706 + 19.565)$
 $= 16.69 \text{ SQM.}$

TOTAL AREA (A+B+C)
 $= (88.058 + 664.01 + 16.69)$
 $= 768.758 \text{ SQM.}$

As per N.C order.
Jmda.
26/11/18

TOTAL AREA OF LAND:- 768.758 SQM.
 TOTAL AREA OF LAND IN SQFT:- 8274.91 SQFT.
 TOTAL AREA OF LAND IN DECIMAL:- 18.996 DEC.

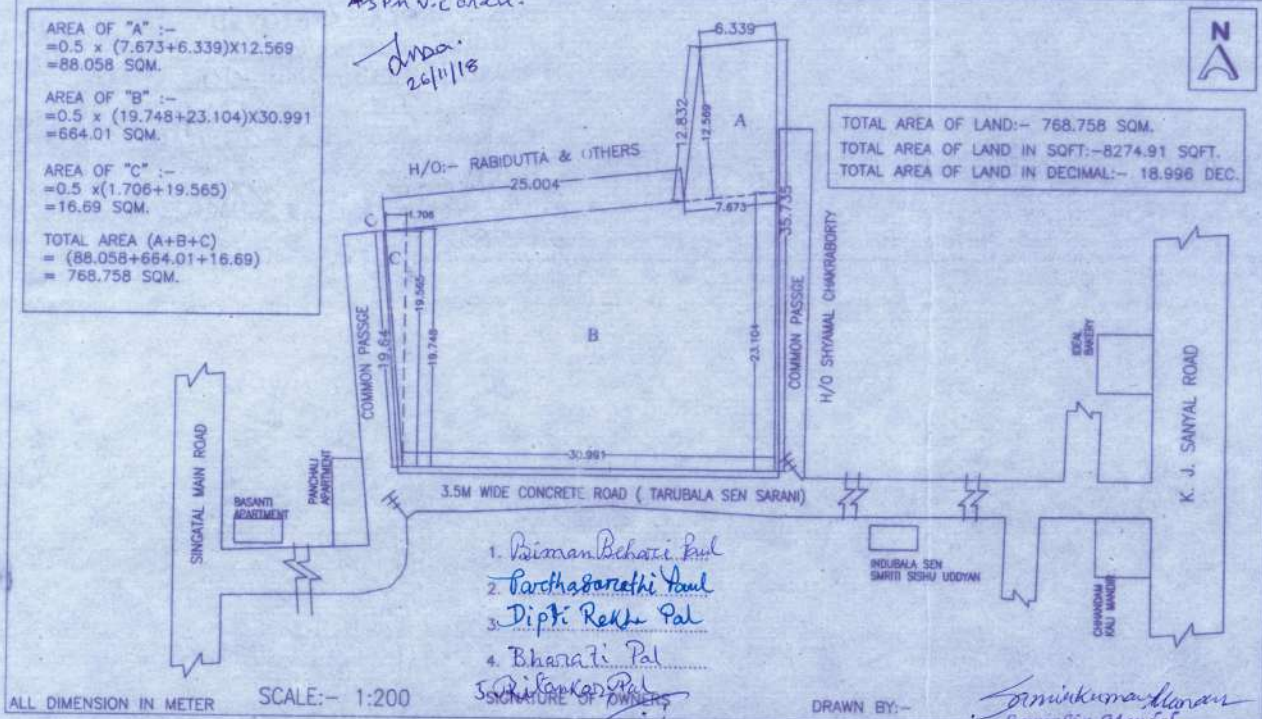

1. Biman Behari Pal
 2. Parthasarathi Pal
 3. Dipti Rekha Pal
 4. Bharati Pal
 5. Ritankar Pal
- SIGNATURE OF OWNERS

ALL DIMENSION IN METER SCALE:- 1:200

DRAWN BY:-

Sanku Kumar Mandal
Sanku K. Mandal
 B. TECH (CIVIL), M. TECH (STRUCTURE)
 REGD. - EBM / PW / PM-152
 Sunny Park, Malda