

GROUND FLOOR PLAN
SCALE-1:100

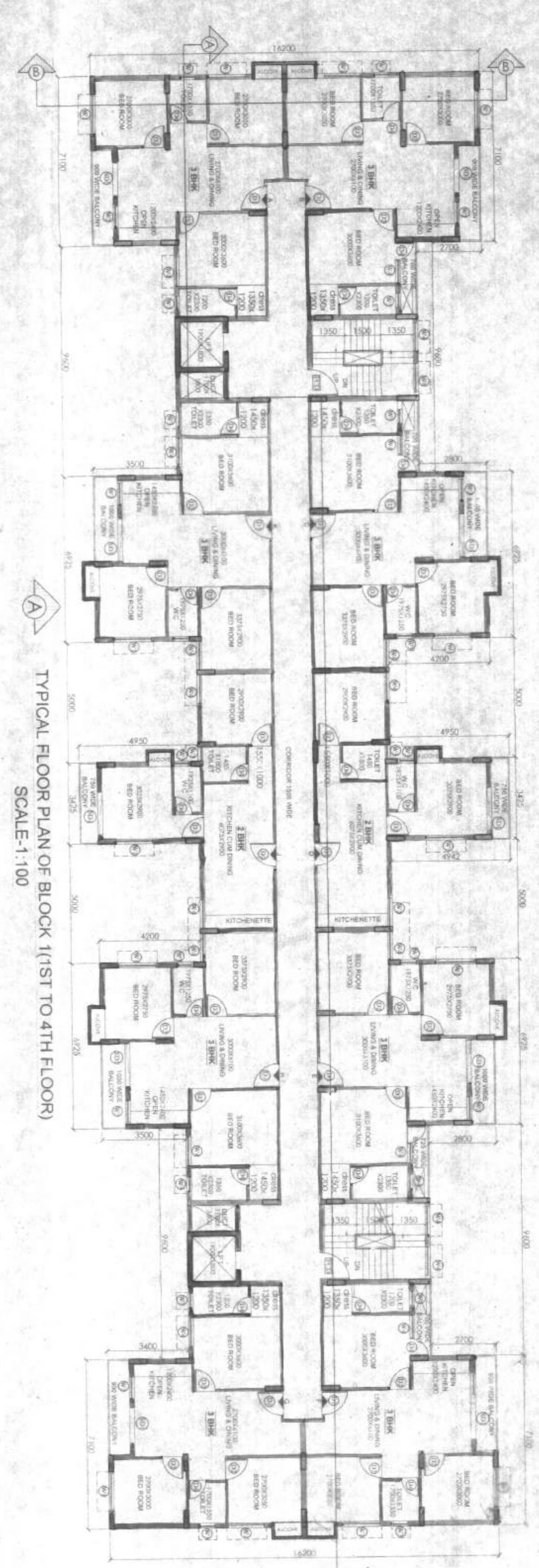

TYPICAL FLOOR PLAN OF BLOCK (1ST TO 4TH FLOOR)
SCALE-1:100

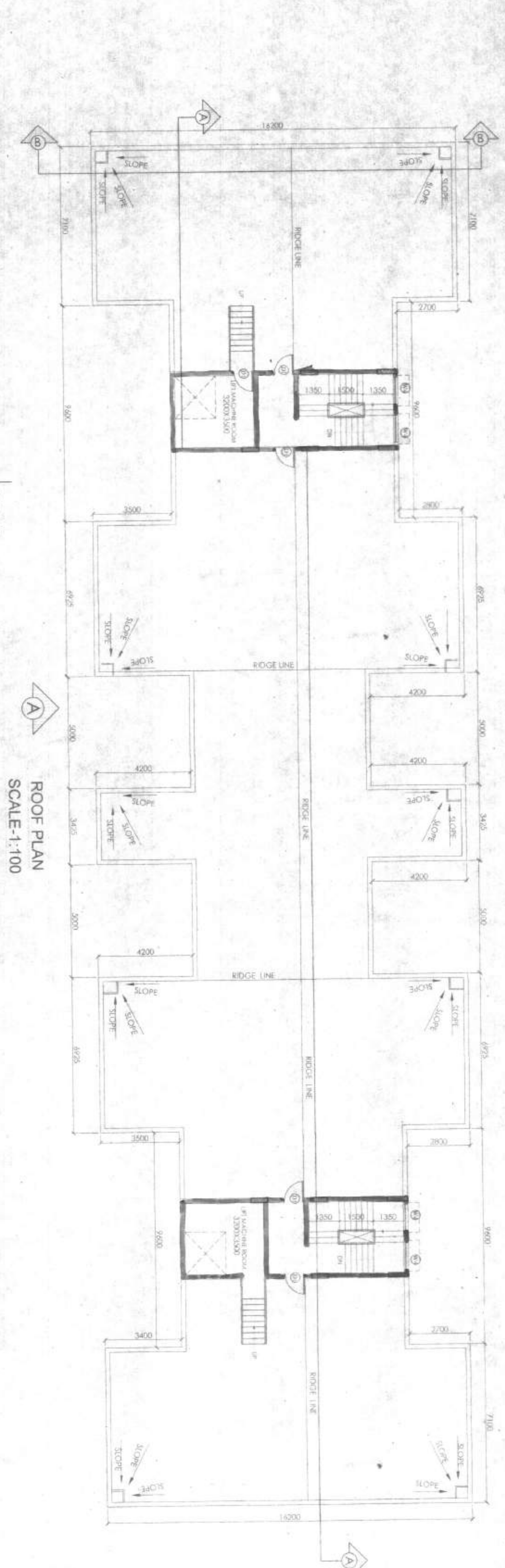

ROOF PLAN
SCALE-1:100

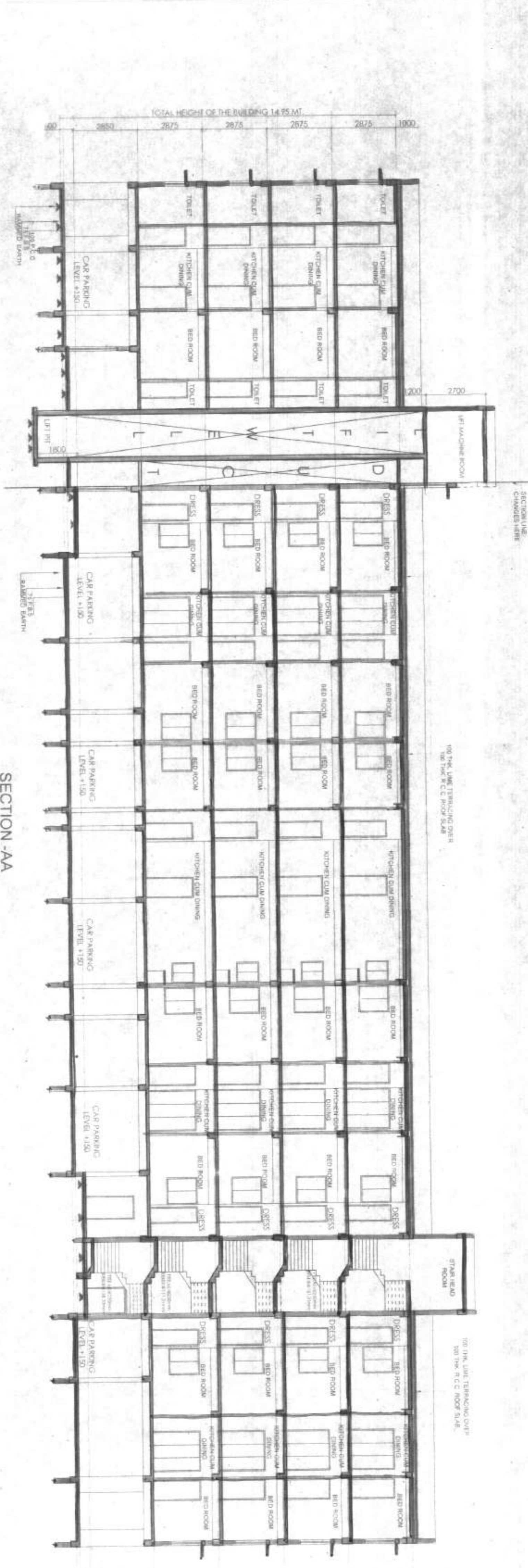

SECTION AA
SCALE-1:100

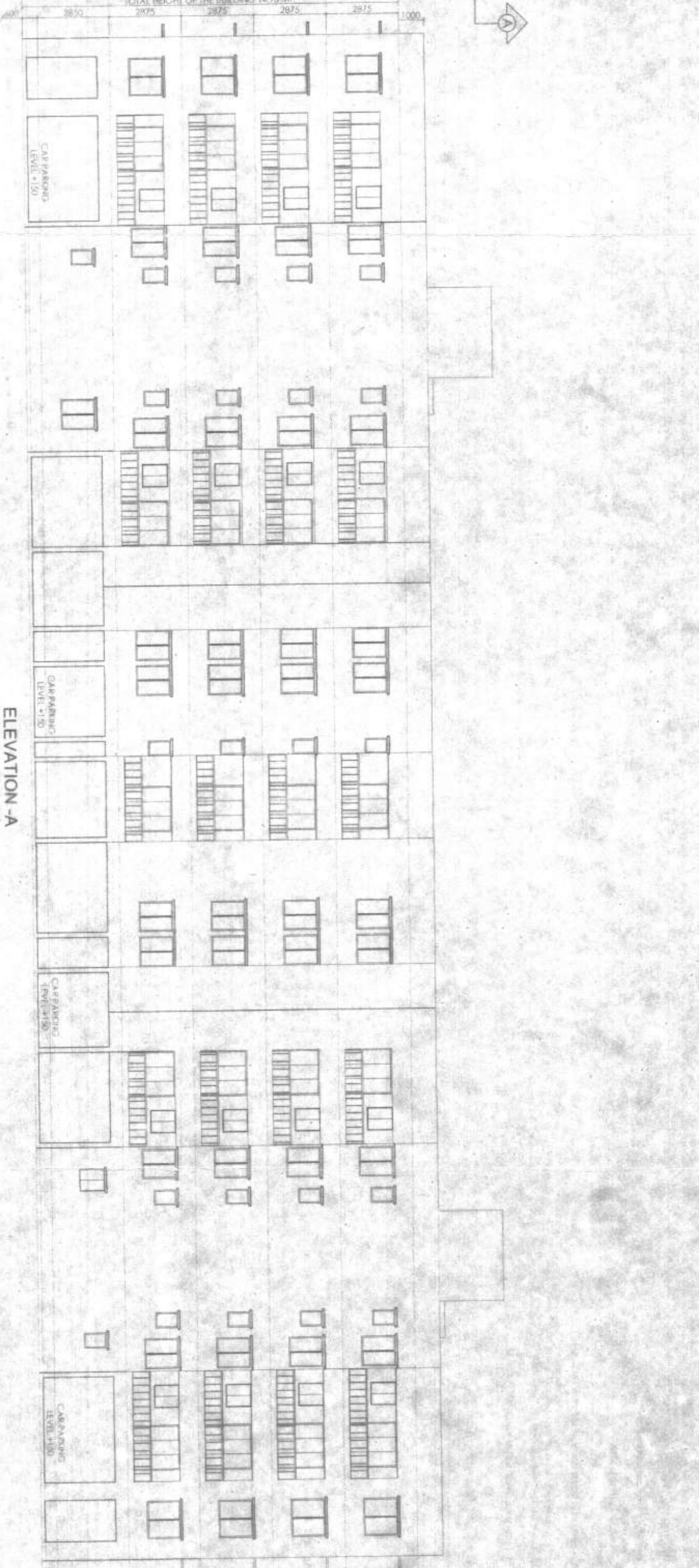

ELEVATION A
SCALE-1:100

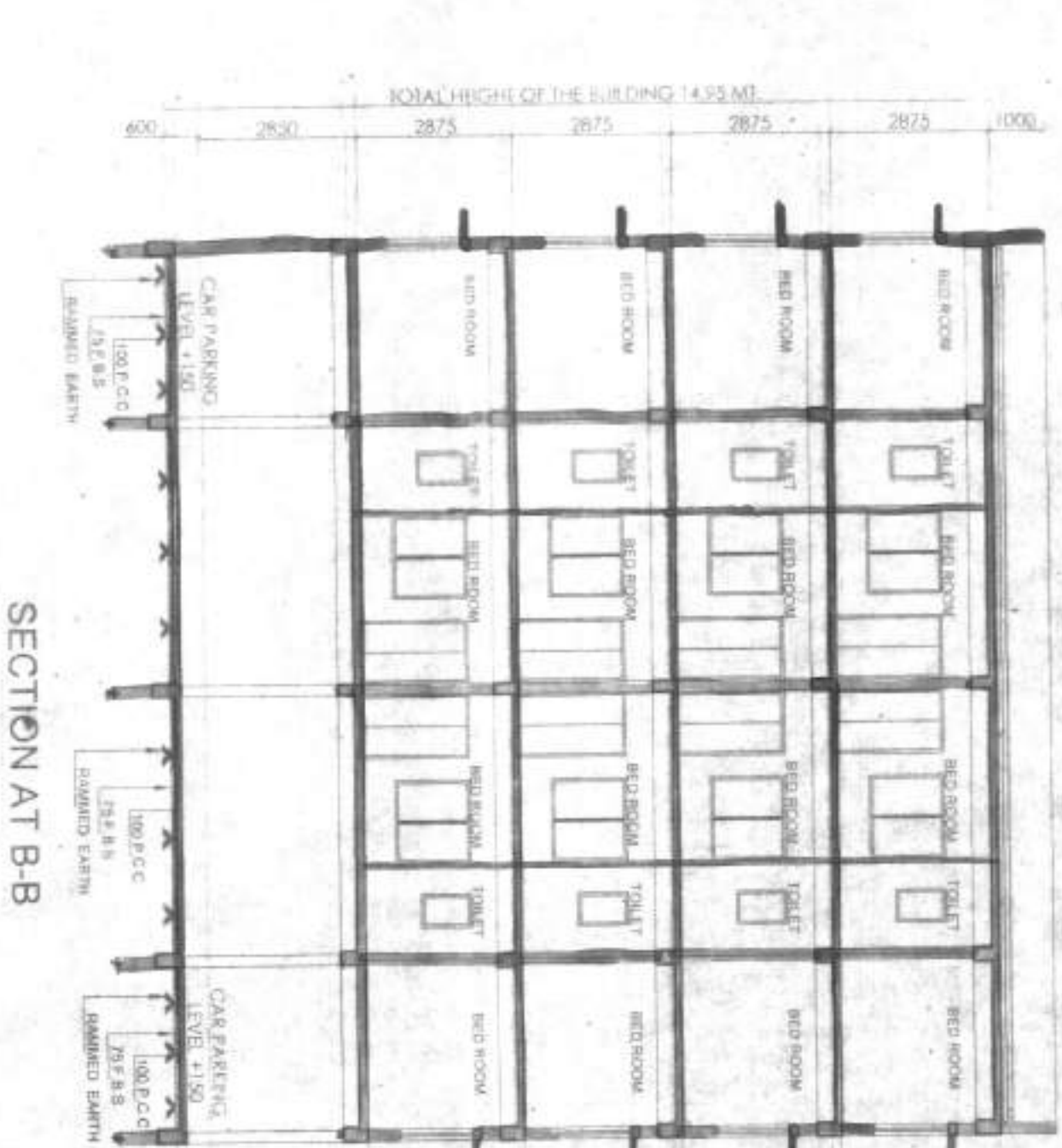

SECTION AT B-B

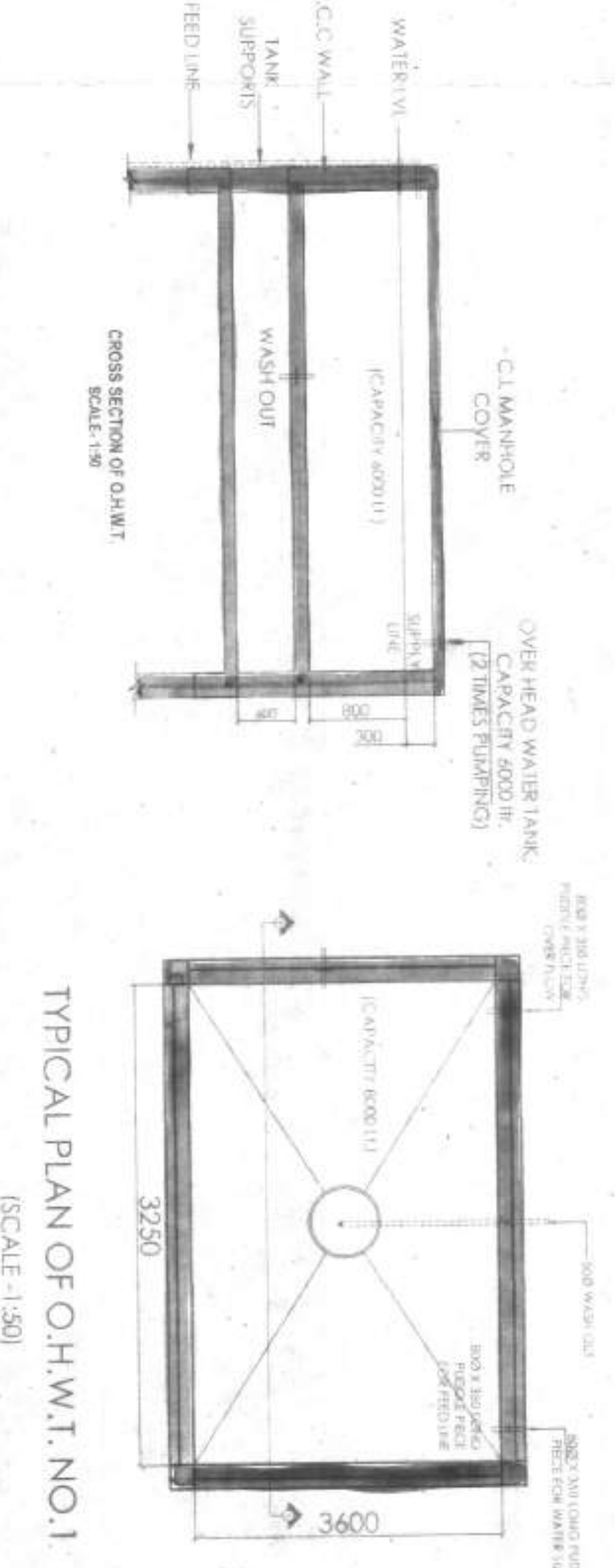

TYPICAL PLAN OF O.H.W.T. NO.1
SCALE-1:50

DOORS			WINDOWS			REMARKS		
MARKED WIDTH	HEIGHT	REMARK	MARKED WIDTH	HEIGHT	SILL			
D1	1200	2100	W1	1500	1350	750		
D2	1100	2100	W2	900	1000	1100		
D3	900	2100	W3	1500	1350	750		
D4	800	2100	W4	1100	1350	1200		
S01	750	2100	W5	500	900	1200		
S02	1800	2100	W6	1800	1350	750		
S03	1600	2100	W6	2400	600			
	1500	2100						

PROPOSED (G+4) STORED RESIDENTIAL AT MOUZA-KHATAUN NO-407/1401/1451, L.S.DAG NO-4781/P/177/P/178/P/179/P, PASCHIM BISHNUPUR GRAM PANCHAYAT, 24 PGS (S), WEST BENGAL

TRIPATHI ENGINEERS
Architects & Planners
10/1, Park Street
Calcutta-700016

ANANYI JI BARUI
Architect
R.C.E. (P)-145825-1
S.K. MOOK, 21/4 BARUA
BANGALORE

Tushar Barua
TUSHARBARUA ARCHITECT
P-22, Park Street, Kolkata-700016
Phone: 9903111111, 9903111117

Amankalyan Biswas
Architect
Amankalyan Biswas
24/201/9/17/26
Kolkata-700016

Amankalyan Biswas
Architect
Amankalyan Biswas
24/201/9/17/26
Kolkata-700016

PROPOSED (G+IV) STORED
RESIDENTIAL COMPLEX AT
MOUZA-UTTAR KAJIRAHAT ; J.L.
22, L.R. KHATAN NO-407, 1401, 1454
L.R. DAG
NO-475(P), 476(P), 477(P), 478(P) P.S.
BISHNUPUR, PASCHIM
BISHNUPUR GRAM PANCHAYAT,
24 PGS (S), WEST BENGAL

CONCERNING ALL THE ARCHITECTURAL, STRUCTURAL, ELECTRICAL, MECHANICAL, CIVIL, AND SANITARY WORKS TO BE EXECUTED IN THE PROPOSED (G+IV) STORED RESIDENTIAL COMPLEX AT MOUZA-UTTAR KAJIRAHAT ; J.L. 22, L.R. KHATAN NO-407, 1401, 1454 L.R. DAG NO-475(P), 476(P), 477(P), 478(P) P.S. BISHNUPUR, PASCHIM BISHNUPUR GRAM PANCHAYAT, 24 PGS (S), WEST BENGAL.

Signature of Architect
AMITAY BHAJAL
CHA/20/10/17702

Signature of Structural Engineer
TUSHABARAN PAHARI
M.E. (CIVIL), IIT KANPUR
R.C.E. No. of-1000-3
S/N-10/20/10/17702

Signature of Electrical Engineer
TUSHABARAN PAHARI
M.E. (ELECTRICAL), IIT KANPUR
R.C.E. No. of-1000-3
S/N-10/20/10/17702

Tushabaran Pahari

Signature of Director
AMITAY BHAJAL
CHA/20/10/17702

TITLE:
SITE INFRASTRUCTURAL LAYOUT FOR SOLID WASTE & RAIN WATER DISPOSAL SYSTEM LOCATION PLAN
DETAIL OF U.G. R. & STP

APPROVED BY:
AMITAY BHAJAL
CHA/20/10/17702

DATE: 11/07/19
SCALE: 1:100

PROJECT NO.: SUBMISSION
DRAWING NO.: 01

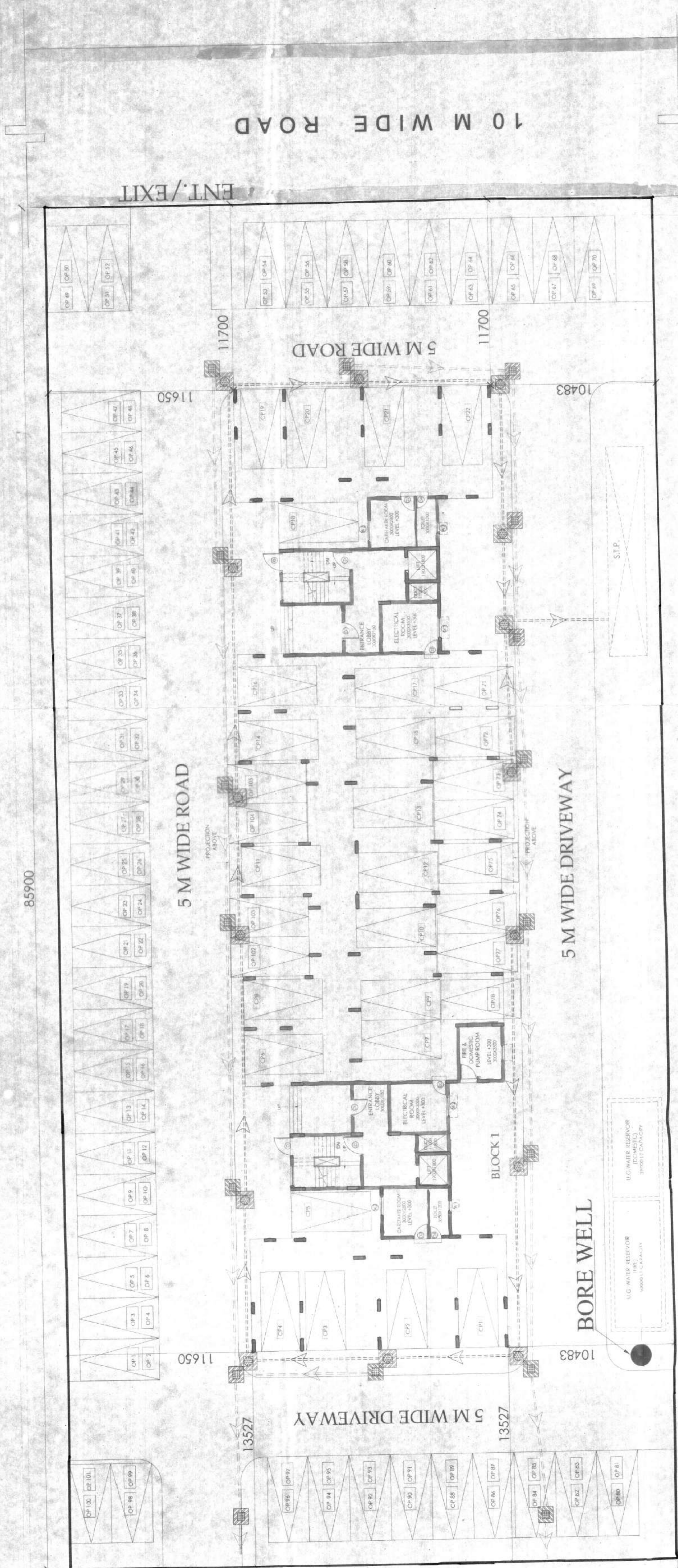

OVERALL SITE PLAN SHOWING GROUND FLOOR PLAN

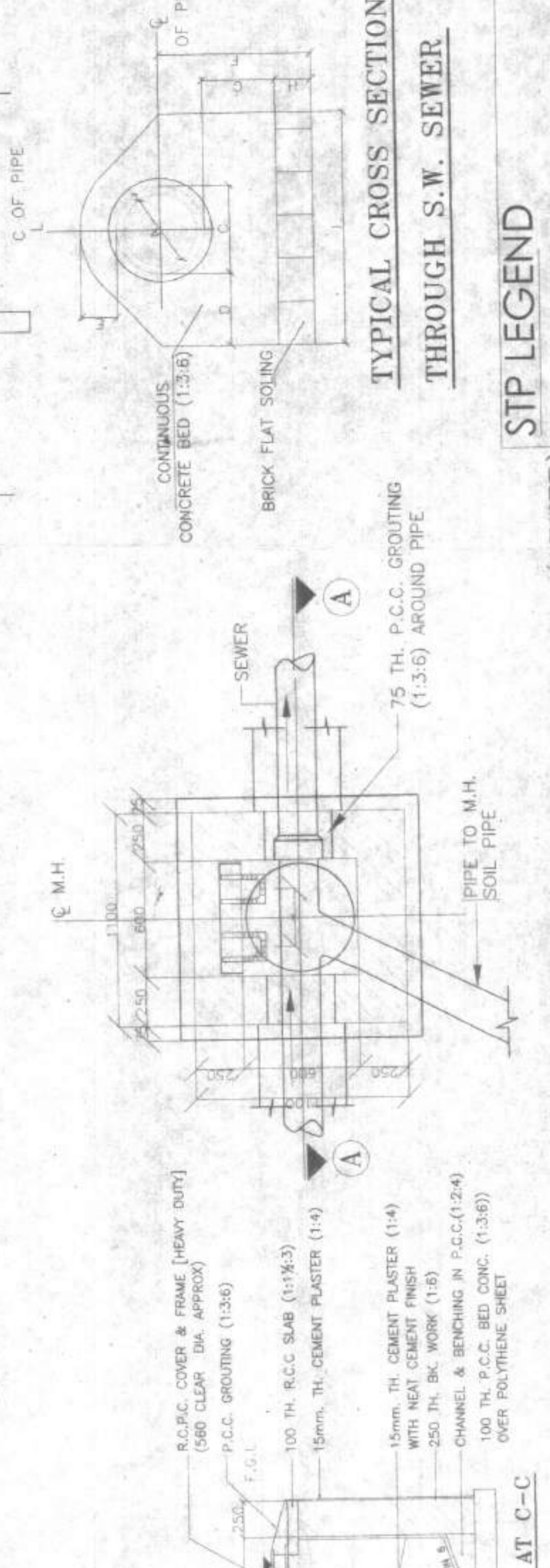

TYPICAL CROSS SECTION THROUGH S.W. SEWER

- STP LEGEND**
- 01 - COARSE BAR SCREEN CHAMBER
 - 02 - COLLECTION SUMP
 - 03 - TRANSFER PUMP
 - 04 - STARTER PANEL
 - 05 - FINE BAR SCREEN CHAMBER
 - 06 - GRIT CHAMBER
 - 07 - DISTRIBUTION CHAMBER
 - 08 - AERATION TANK
 - 09 - SECONDARY SETTLING TANK
 - 10 - SLUDGE PUMP
 - 11 - SLUDGE DRYING BED
 - 12 - FILTER FEED TANK
 - 13 - FILTER FEED PUMP
 - 14 - MULTIGRADE FILTER (MF)
 - 15 - ACTIVATED CARBON FILTER (ACF)
 - 16 - TREATED WATER TANK
 - 17 - PATHWAY

TYPICAL PLAN OF INSPECTION CHAMBER (SEWER)
SIZE - 600X600(CLEAR)
DEPTH UP TO 1500 MM FROM F.G.L.

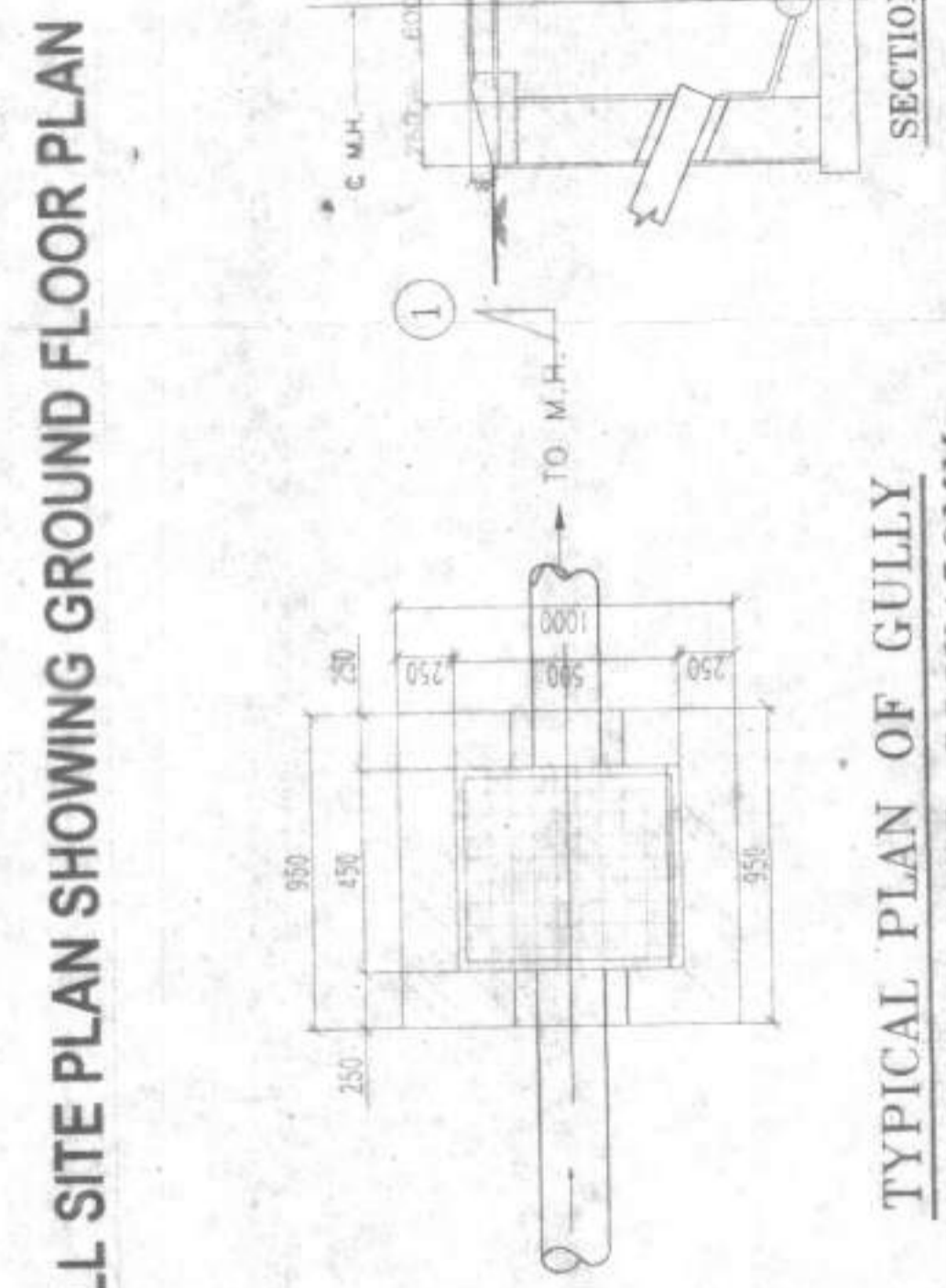

TYPICAL PLAN OF GULLY TRAP CHAMBER 500X450MM

TYPICAL PLAN OF MANHOLE CHAMBER (SEWER)
SIZE - (900MM X 750MM) CLEAR
DEPTH FROM 1501MM TO 2000MM FROM F.G.L.

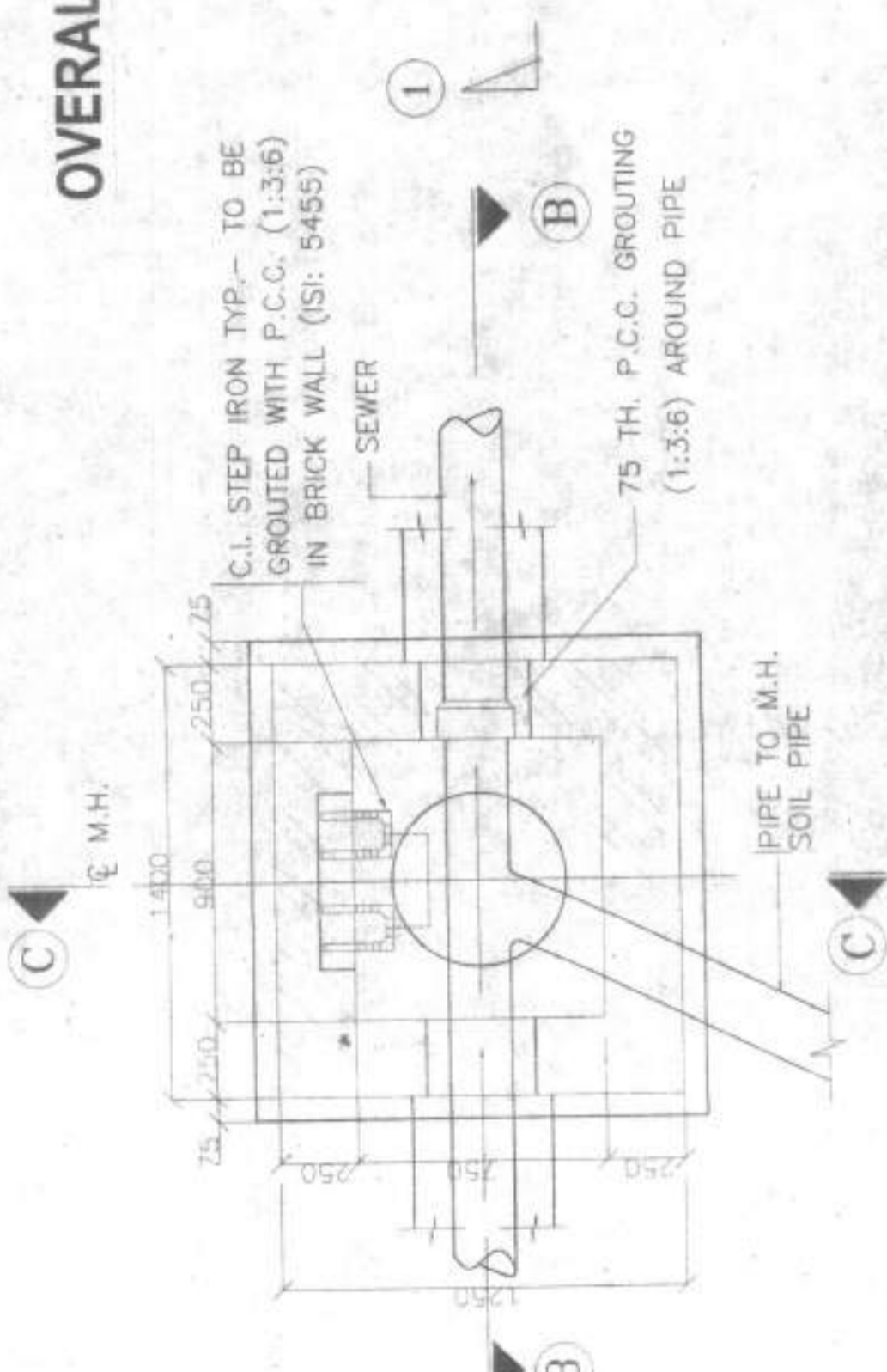

TYPICAL PLAN OF CATCH PIT EXCEPT SCUPPER, SIZE - 600X600

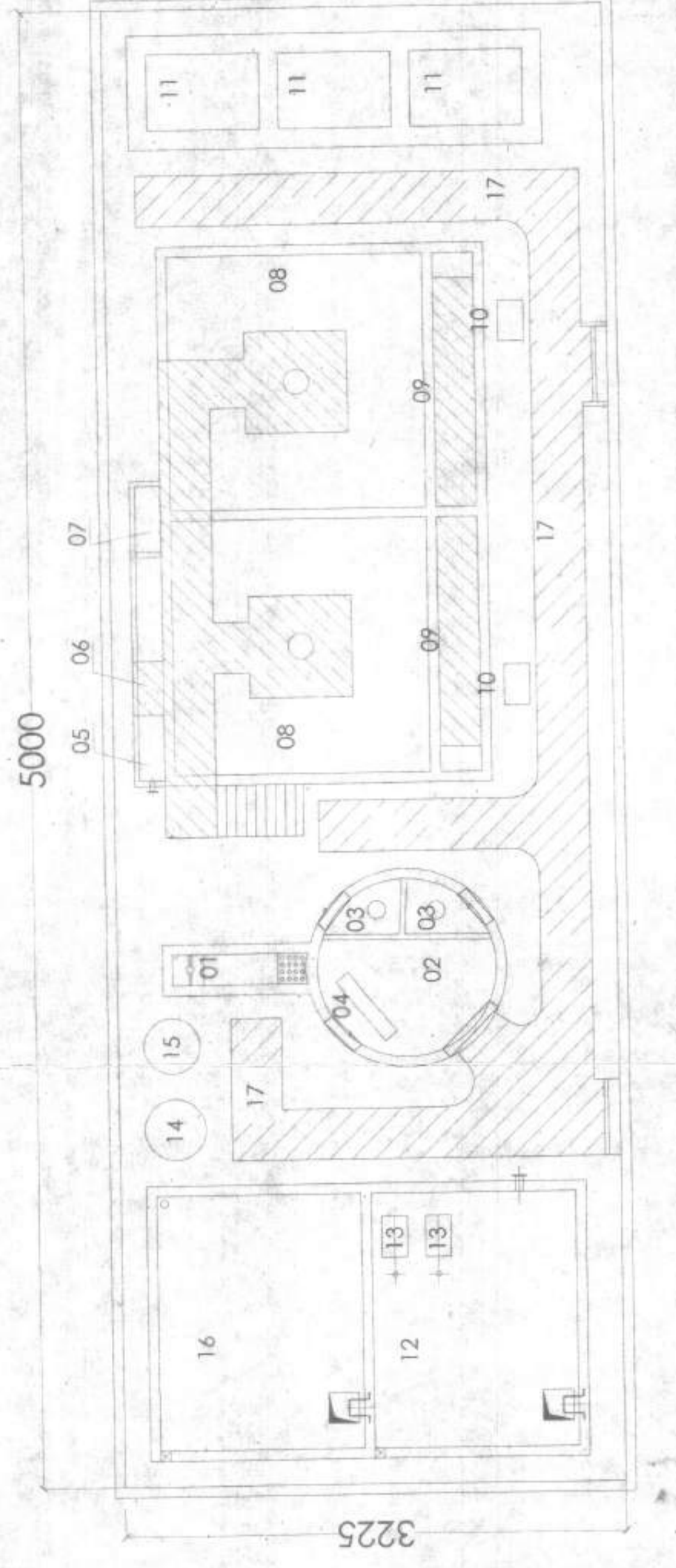
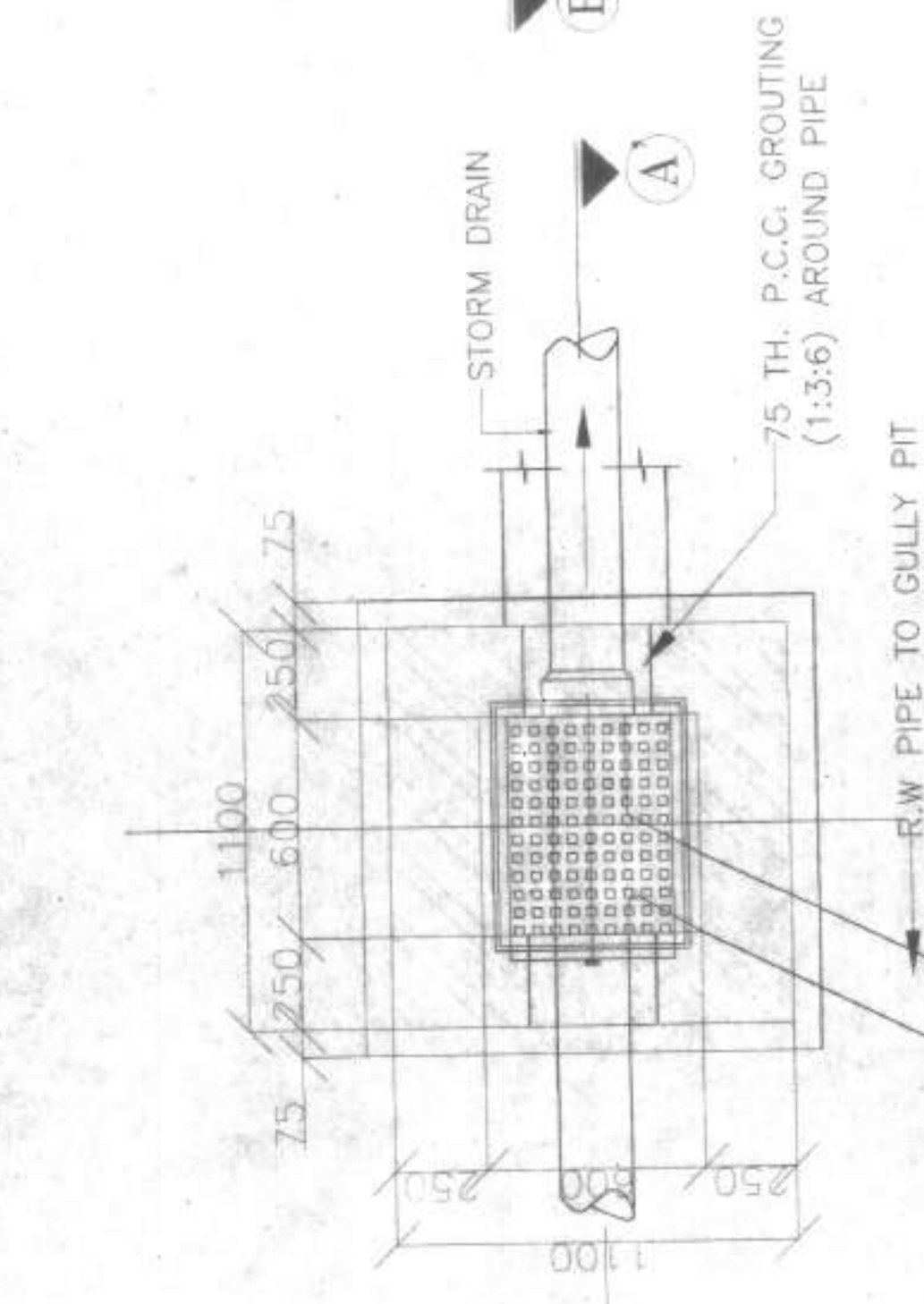

STP DETAIL

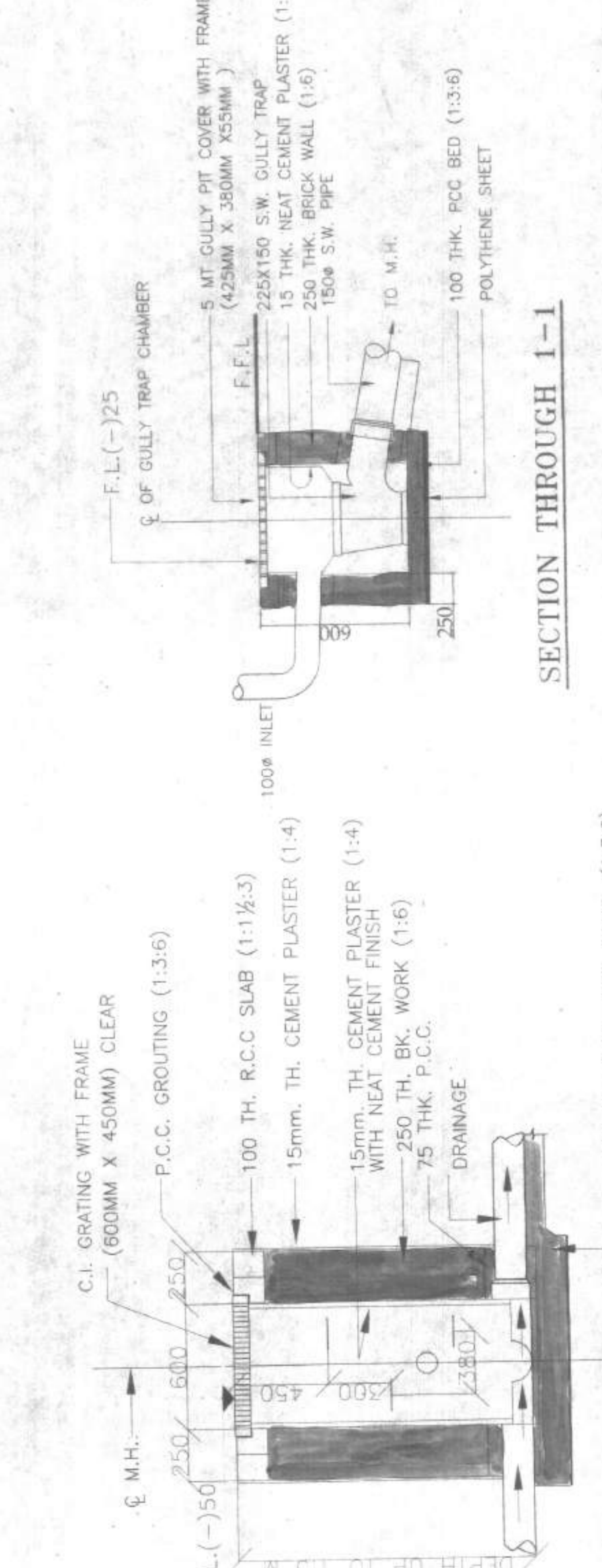

SECTION AT 'A-A'

SECTION THROUGH 1-1

LEGEND

- RAIN WATER DISPOSAL LINE
- SOLID WASTE DISPOSAL LINE
- CATCH PIT/STORM WATER PIT
- INSPECTION PIT

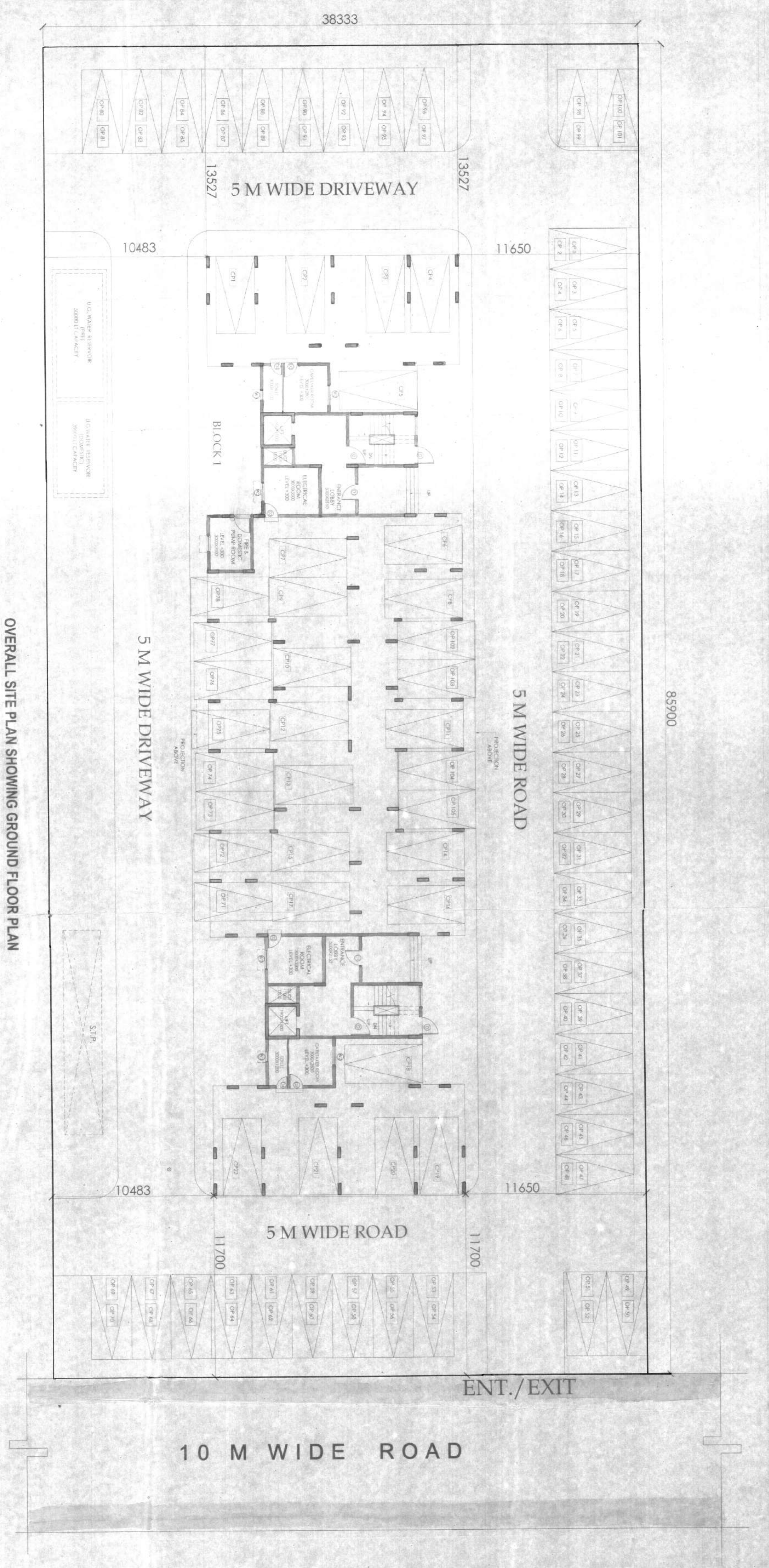

OVERALL SITE PLAN SHOWING GROUND FLOOR PLAN

AREA CALCULATION FOR (G+1) STORED RESIDENTIAL COMPLEX AT MOUZA-UTTAR KAJIRAHAT, J.L. 221 R. KHATIAN NO. 407, 1401/1454, 1. R. DAOG NO. 475(P), 477(P), 478(P), 479(P), 480(P), 481(P), 482(P), 483(P), 484(P), 485(P), 486(P), 487(P), 488(P), 489(P), 490(P), 491(P), 492(P), 493(P), 494(P), 495(P), 496(P), 497(P), 498(P), 499(P), 500(P) P.S. BISHNUPUR GRAM PANCHAYAT, 24 PGS (S), WEST BENGAL.

NAME AREA	AREA	NO. OF FLOORS	FLOOR AREA	TOTAL AREA	NO. OF FLOORS	FLOOR AREA	TOTAL AREA
Block 1	13527	4	54108	54108	4	54108	54108
Block 2	13527	4	54108	54108	4	54108	54108
DRIVEWAY	10483	1	10483	10483	1	10483	10483
ROAD	11650	1	11650	11650	1	11650	11650
ROAD	11700	1	11700	11700	1	11700	11700
ROAD	10483	1	10483	10483	1	10483	10483
TOTAL				138432			138432

AREA CALCULATION FOR (G+1) STORED RESIDENTIAL COMPLEX AT MOUZA-UTTAR KAJIRAHAT, J.L. 221 R. KHATIAN NO. 407, 1401/1454, 1. R. DAOG NO. 475(P), 477(P), 478(P), 479(P), 480(P), 481(P), 482(P), 483(P), 484(P), 485(P), 486(P), 487(P), 488(P), 489(P), 490(P), 491(P), 492(P), 493(P), 494(P), 495(P), 496(P), 497(P), 498(P), 499(P), 500(P) P.S. BISHNUPUR GRAM PANCHAYAT, 24 PGS (S), WEST BENGAL.

NAME AREA	AREA	NO. OF FLOORS	FLOOR AREA	TOTAL AREA
Block 1	13527	4	54108	54108
Block 2	13527	4	54108	54108
DRIVEWAY	10483	1	10483	10483
ROAD	11650	1	11650	11650
ROAD	11700	1	11700	11700
ROAD	10483	1	10483	10483
TOTAL				138432

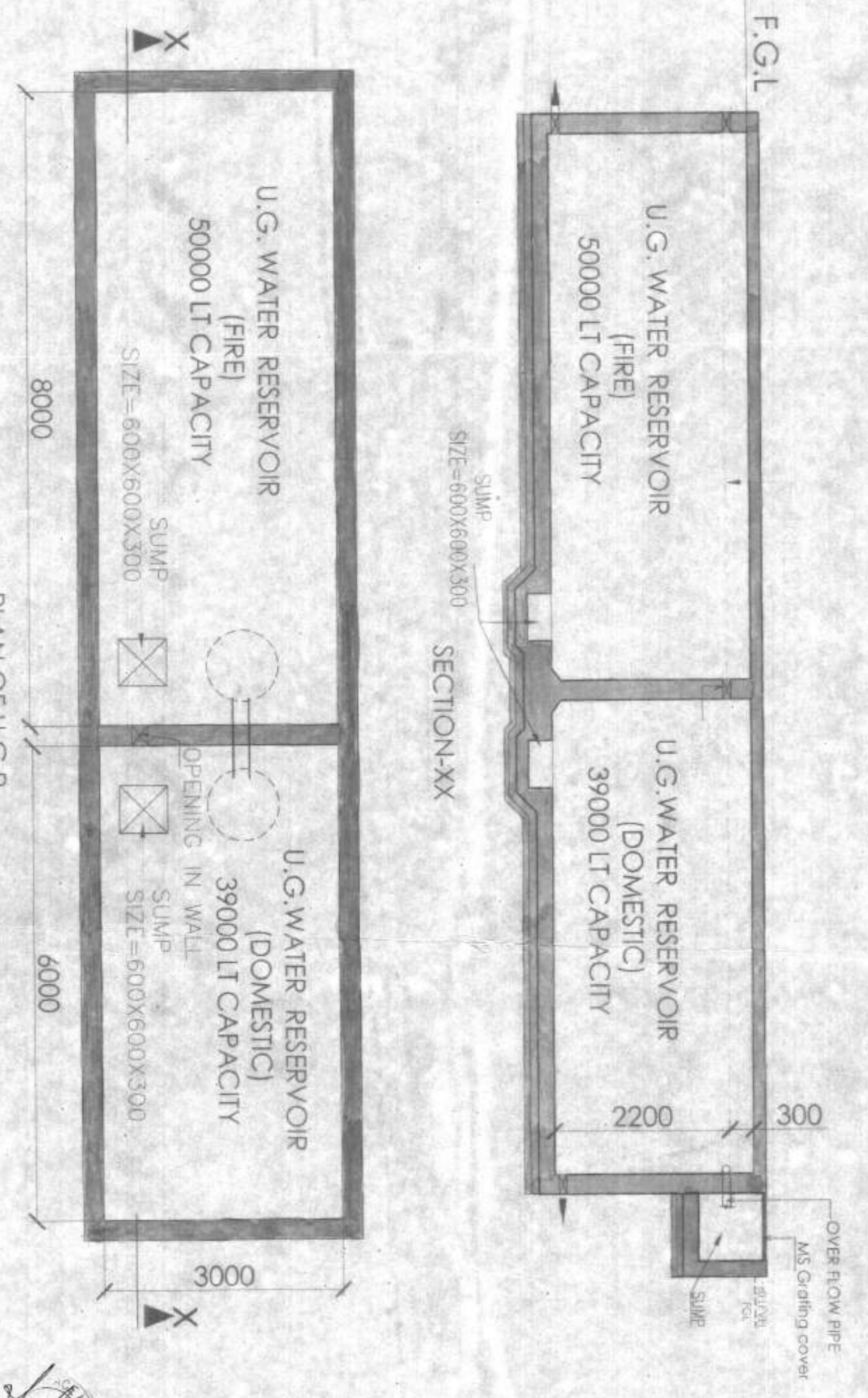
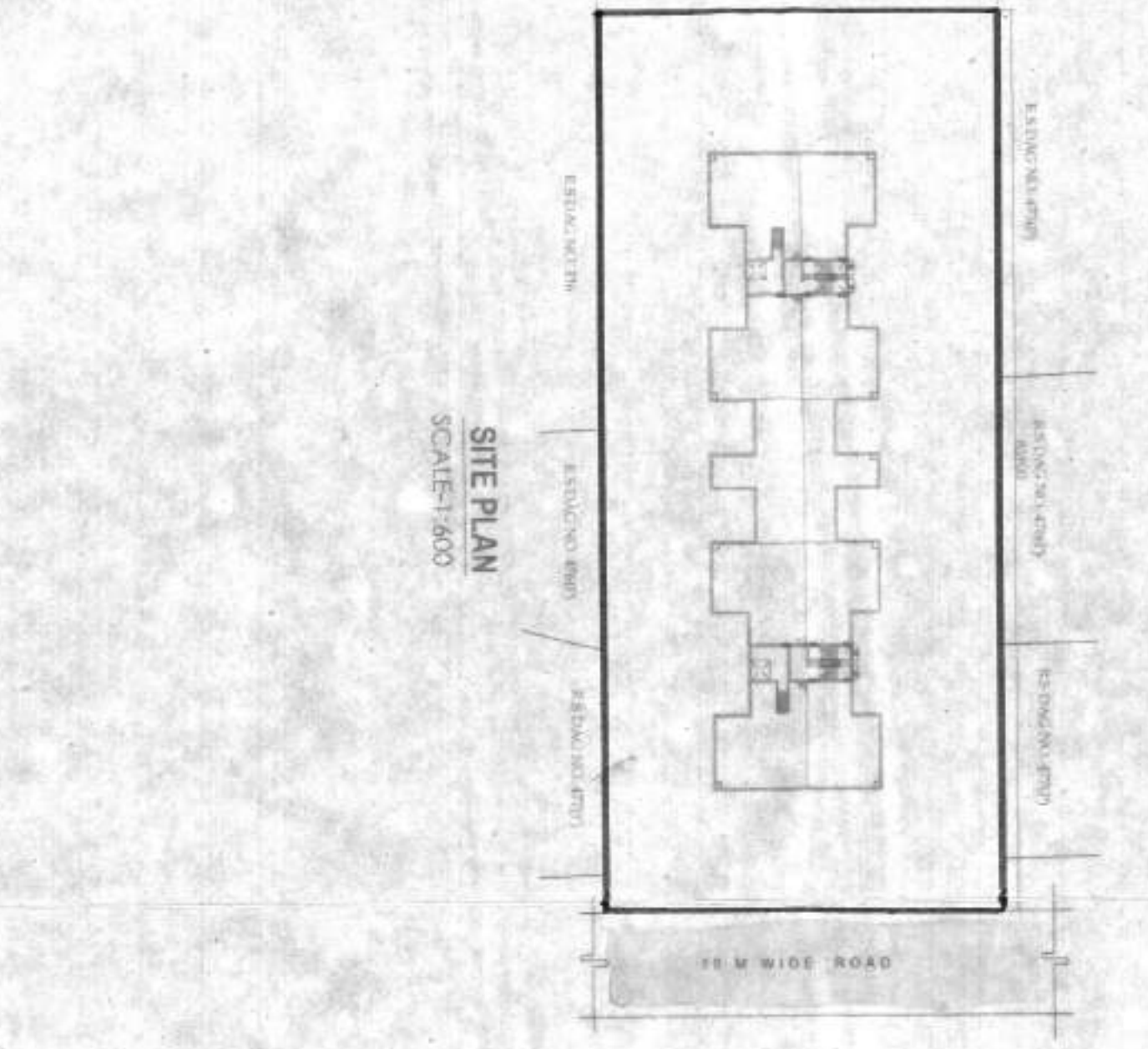

TITLE:
OVERALL SITE PLAN SHOWING GROUND FLOOR PLAN LOCATION PLAN SITE PLAN SHOWING DAG NOS. 24 PGS (S)

DATE: 11/03/2024

SCALE: 1:50

PROJECT: SUBMISSION DRAWING

DESIGNED BY: ANIL K.

CHECKED BY: ANIL K.

DATE: 11/03/2024

SCALE: 1:50

PROJECT: SUBMISSION DRAWING

DESIGNED BY: ANIL K.

CHECKED BY: ANIL K.

DATE: 11/03/2024

SCALE: 1:50

PROJECT: SUBMISSION DRAWING

PROPOSED (G+1) STORED RESIDENTIAL COMPLEX AT MOUZA-UTTAR KAJIRAHAT, J.L. 221 R. KHATIAN NO. 407, 1401/1454, 1. R. DAOG NO. 475(P), 477(P), 478(P), 479(P), 480(P), 481(P), 482(P), 483(P), 484(P), 485(P), 486(P), 487(P), 488(P), 489(P), 490(P), 491(P), 492(P), 493(P), 494(P), 495(P), 496(P), 497(P), 498(P), 499(P), 500(P) P.S. BISHNUPUR GRAM PANCHAYAT, 24 PGS (S), WEST BENGAL.

PREPARED BY: ANIL K.

CHECKED BY: ANIL K.

DATE: 11/03/2024

SCALE: 1:50

PROJECT: SUBMISSION DRAWING

