

PLAN FOR PROPOSED G+IV STORIED RESIDENTIAL BUILDING PLAN AT MOUZA-DHAMAITALA, J.L.NO - 75, R.S. DAG NO.- 50, R.S. KH. NO.- 27, L.R DAG. NO. 02, L.R.KH - 554,553 & 552, HOLDING NO.- 89 DHAMAITALA LANE, WARD NO- 25, P.S-SONARPUR, DIST.- 24 PGS (9), UNDER - RAJPUR-SONARPUR MUNICIPALITY, OWNERS NAME : SUJOY KR. PATHAK & OTHER'S

DETAILS SPECIFICATION OF BUILDING.

NOTES:

1. ALL DIMENSIONS ARE IN M.M. UNLESS OTHERWISE SPECIFIED.
2. THE FOUNDATION SHALL BE AS PER STANDARD SPECIFICATION.
3. ALL CONCRETE SHALL BE OF GRADE M20.
4. ALL STEEL SHALL BE OF GRADE Fe 415.
5. THE FINISH SHALL BE AS PER STANDARD SPECIFICATION.
6. THE WORK SHALL BE DONE AS PER STANDARD SPECIFICATION.
7. THE CONTRACTOR SHALL BE RESPONSIBLE FOR OBTAINING ALL NECESSARY PERMITS AND APPROVALS.
8. THE CONTRACTOR SHALL BE RESPONSIBLE FOR OBTAINING ALL NECESSARY PERMITS AND APPROVALS.
9. THE CONTRACTOR SHALL BE RESPONSIBLE FOR OBTAINING ALL NECESSARY PERMITS AND APPROVALS.
10. THE CONTRACTOR SHALL BE RESPONSIBLE FOR OBTAINING ALL NECESSARY PERMITS AND APPROVALS.

SCHEDULE OF DOORS & WINDOWS

DECLARATION OF E.E.S.

DECLARATION OF GEO-TECH.

SIGNATURE OF E.E.S. MANAS KUMAR JEE, RAJPUR-SONARPUR MUNICIPALITY.

SIGNATURE OF GEO-TECH. SUDAN KUMAR JEE, RAJPUR-SONARPUR MUNICIPALITY.

OFFICE USE

APPROVED

27/04/2024

RAJPUR-SONARPUR MUNICIPALITY

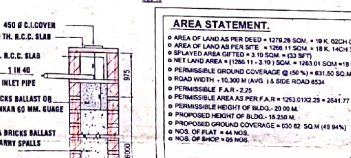

AREA STATEMENT.

AREA OF LAND AS PER SITE PLAN = 1712.28 SQ.M. = 196.11 SQ.M. X 8.70 M. X 18.70 M. X 9.57 M.

AREA OF LAND AS PER SITE PLAN = 1086.11 SQ.M. X 18.70 M. X 9.57 M.

NET LAND AREA = 1712.28 SQ.M. X 18.70 M. X 9.57 M.

PROPOSED BOUNDARY AREA = 1712.28 SQ.M. X 18.70 M. X 9.57 M.

PROPOSED PARKING AREA = 1712.28 SQ.M. X 18.70 M. X 9.57 M.

PROPOSED ROAD AREA = 1712.28 SQ.M. X 18.70 M. X 9.57 M.

PROPOSED UTILITY AREA = 1712.28 SQ.M. X 18.70 M. X 9.57 M.

PROPOSED TOTAL AREA = 1712.28 SQ.M. X 18.70 M. X 9.57 M.

AREA STATEMENT (CONTINUED)

NO.	DESCRIPTION	AREA (SQ.M.)	PERCENTAGE (%)
1	AREA OF LAND AS PER SITE PLAN	1712.28	100.00
2	AREA OF LAND AS PER SITE PLAN	1086.11	63.14
3	NET LAND AREA	1712.28	100.00
4	PROPOSED BOUNDARY AREA	1712.28	100.00
5	PROPOSED PARKING AREA	1712.28	100.00
6	PROPOSED ROAD AREA	1712.28	100.00
7	PROPOSED UTILITY AREA	1712.28	100.00
8	PROPOSED TOTAL AREA	1712.28	100.00