

FOUNDATION LAYOUT PLAN

SCALE: 1:100

S. K. SAHANA ROAD

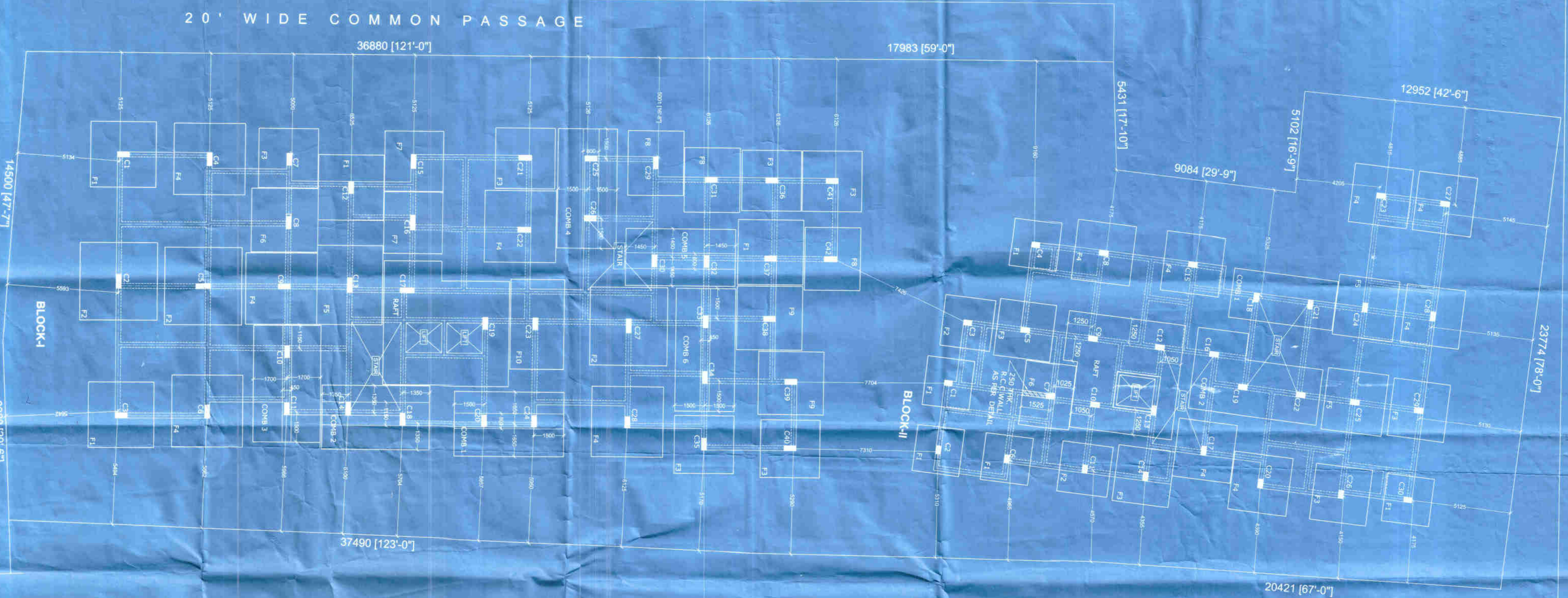

PROPOSED CONSTRUCTION OF G+V RESIDENTIAL GUM COMMERCIAL BUILDING BLOCK-I & G+V RESIDENTIAL BUILDING BLOCK-II OF TARUN KUMAR KUNDU, SUMITA KUNDU, ABHIT KUNDU ON C.S. DAG NO.-244(PART), L.R. DAG NO.-1571, C.S. KHATTAN NO.-212, L.R. KHATTAN NO.-6713,8712 & 6713, MOUGA-KENDUADIHI, J.L. NO.-213, WARD NO.-22, UNDER P.S & DIST. & MUNICIPALITY - BANKURA.

SPECIFICATIONS-

1. DEPTH OF FOUNDATION IS AT 1.50 M. BELOW G.L.
2. SAFE BEARING CAPACITY OF SOIL IS AS PER SOIL TEST REPORT
3. GRADE OF CONC. IS M-20 AND GRADE OF STEEL IS Fe 415
4. CLEAR COVER TO MAIN REIN. IS AS PER BELOW -
a) FOUNDATION - 40 MM. b) COLUMN - 40 MM. c) BEAM - 25 MM. d) SLAB - 15 MM.
5. ALL SLABS MUST BE CAST MONOLITHIC WITH SUPPORTING BEAM.
6. ALL OTHER SPECIFICATIONS ARE AS PER IS 456:2000 AND IS 1786:2000.

THIS STRUCTURAL DESIGN & DRAWING OF THIS FOUNDATION AND SUPERSTRUCTURE OF THE BUILDING HAS BEEN MADE BY ME CONSIDERING ALL POSSIBLE LOADS & CONDITIONS. THE SALES & STABLE IN ALL REFERENCE.

SIG. OF STRUCTURAL ENGINEER

Subodh Chandra Pal
Subodh Chandra Pal
Under Engineer Municipality
Licence No. 133-133

Sural Parthasar
SURAL PARTHASAR
P&S Building Services & Engineers
Licence No. 133-133

Slid. of L.S.

Shriya Bhattacharya
Shriya Bhattacharya
REG. NO. CA/87/10587

SIGNATURE OF ARCHITECT

Shriya K. Kundu
Shriya K. Kundu
Proprietor

SIGNATURE OF DEVELOPER

Proprietor
Proprietor

SIGNATURE OF OWNER

Signature of Client

SHEET NO.-5/1