

SITE PLAN FOR THE PROPOSED G+IV STORIED RESIDENSIAL FLAT BUILDING OF 1) SRI SUKUMAR KUNDU 2) SRI AMAL KUNDU BOTH ARE S/O SRI SASADHAR KUNDU 3) SMT. SANTANA KUNDU W/O SRI SUKUMAR KUNDU 4) SRI ANIRBAN KUNDU S/O SRI NIRMAL KUNDU 5) SRI INDRANIL KUNDU S/O SRI PARIMAL KUNDU, ON MOUZA - KANAINATSAL, J.L.NO. -76, R.S. & L.R. PLOT NO. -158, 160, R.S KH NO - 21 & 32, L.R KH NO - 2224, 2225, 2226, 2227, 2228, AT MAHALLA - KHUDIRAMPALLY, HOLDING NO- 326/7, WARD NO:-11, UNDER BURDWAN MUNICIPALITY, P.S.- BURDWAN, DIST - PURBA BARDHAMAN.

AREA OF LAND - 4815.00 SFT

NATURE OF LAND - BASTU

OWNER LAND SHOWN IN COLOUR 

ROAD SHOWN IN COLOUR 

EXT. CONST. SHOWN IN COLOUR 

DRAIN SHOWN IN COLOUR 

SITE PLAN

SCALE - 1" = 32'

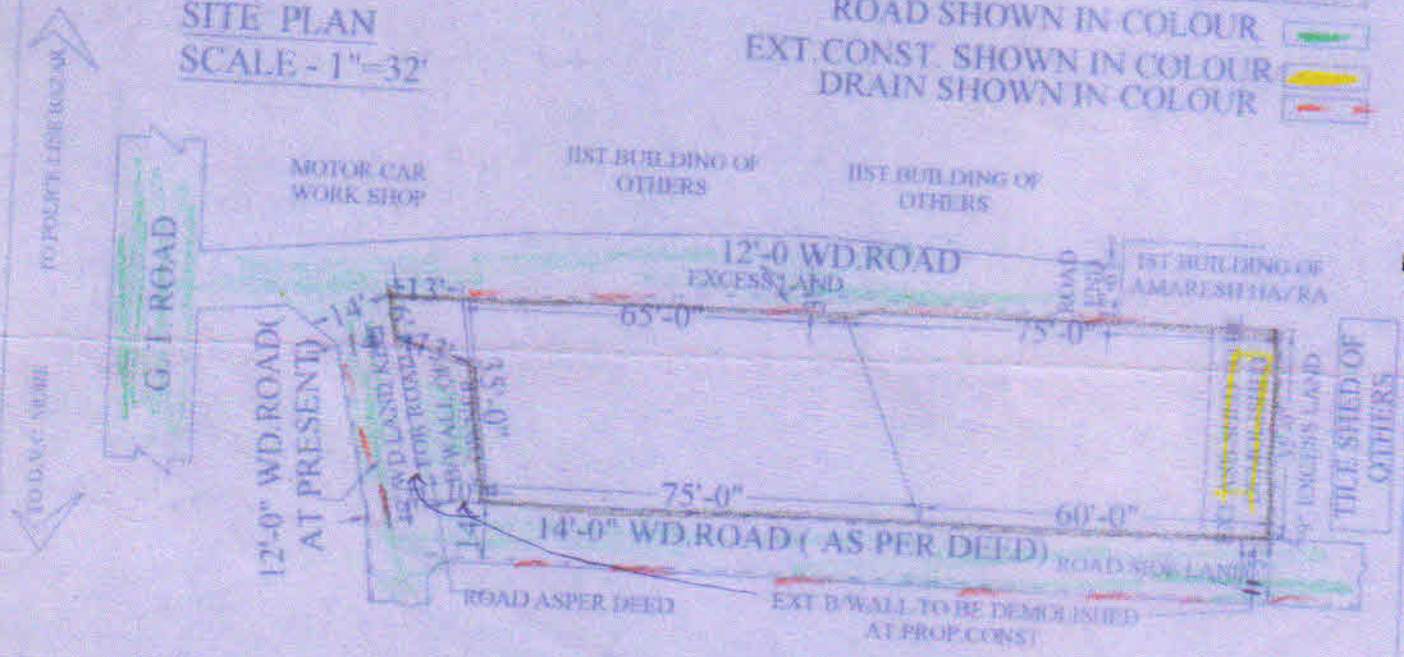

Chairman
Burdwan Municipality
VICE - CHAIRMAN

12/7/18
ENGINEER

12/7/18
for HEALTH OFFICER

Parimal Kunder Kundu

Sukumar Kundu

Amal Kundu

Anirban Kundu

Indranil Kundu

DRAWN BY

SIGN. OF OWNER