



SHREE GANESHAYA INFRAPROJECTS LTD

CIN NO : U70101WB2006PLC110807

A SITE PLAN SHOWING THE LAND DEMARCATON WITH BOUNDARYWALL AT HOLDING NO.- 156, JANGALPUR ROAD, WARD NO.- 17, AT R.S DAG NO.- 85, L.R. DAG NO.-93, R.S. KHATIAN NO.- 120, L.R. KHATIAN NO.- 51, J.L. NO.- 11, IN MOUZA-JANGALPUR, P.S.- AIRPORT, DIST.- 24 PGS.(N), UNDER NORTH DUMDUM MUNICIPALITY.

SCALE:- 1:400

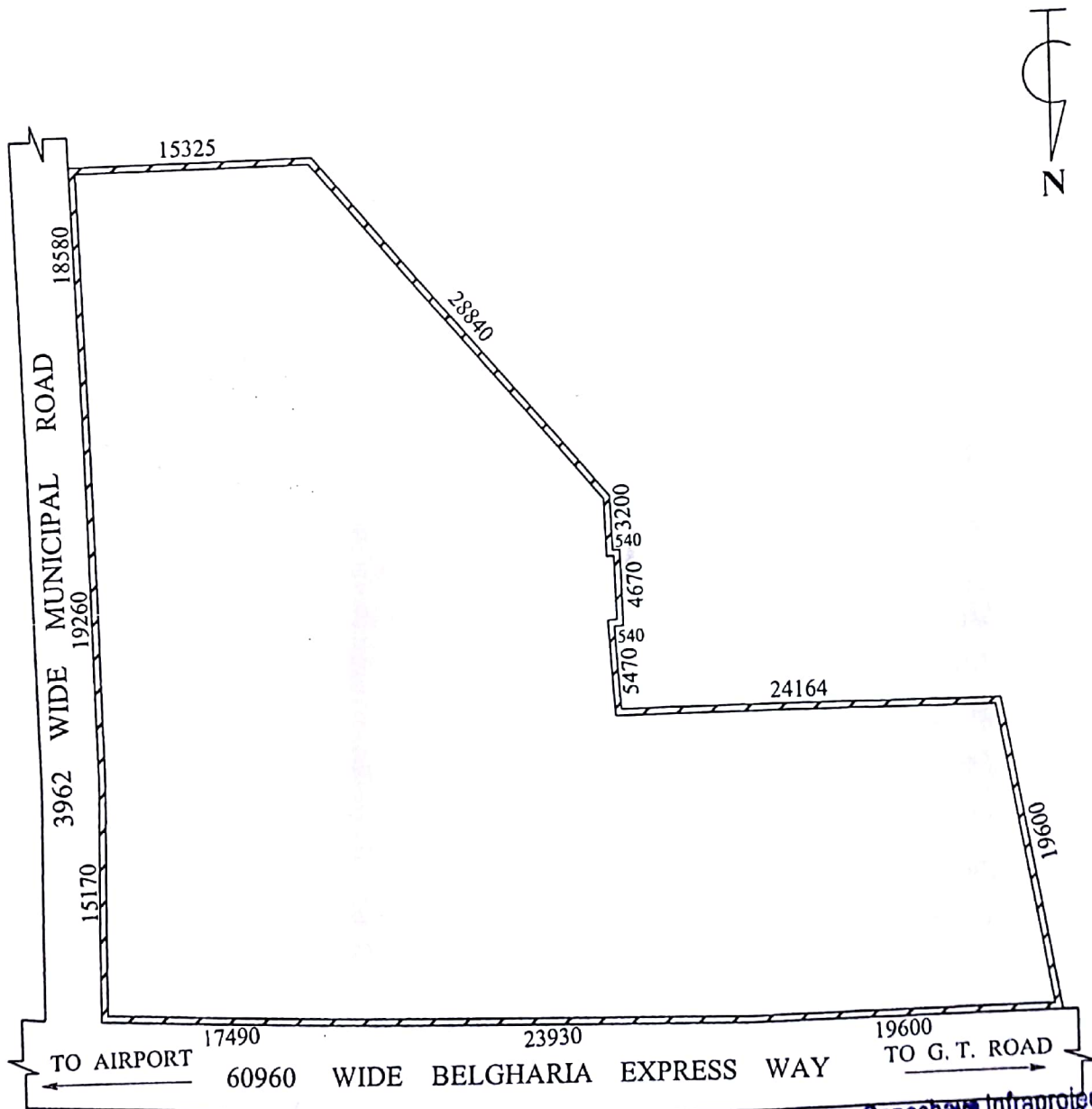

Shree Ganeshaya Infraprojects Ltd.
[Signature]
Director

613, Jasmine Tower, 31, Shakespeare Sarani, Kolkata-700017
Phone : 033 2283 5763 , email:info@sgggroup.co.in
url : www.sgggroup.co.in