



DEVELOPERS LIMITED(Donor herein) registered at D.S.R.-IV, and recorded in Book No.I,C.D. Volume No.23, Pages-1174 to1186 being No.4125 for the year 2014.

AND WHEREAS One Smt. Gita Patra sold the land measuring more or less 2 Cottahs 32 Sq.ft. equivalent to 3.3 decimals out of 50 decimals in **R.S.Dag No.17, I.R.Dag No.4, R.S.Khatian No.97** of Nischintapur Mouza, **J.L.No.53** in 2008 to **DEVALOKE DEVELOPERS LIMITED**(Donor herein) registered at A.R.A.-I, Kolkata and recorded in Book No.I,C.D. Volume No. 59, Pages- 4254 to4269 being No.11440 for the year 2008.

AND WHEREAS One Haripada Das & Palash Das sold the land measuring more or less 2 Cottahs 4 Chhattaks 34 Sq.ft. equivalent to 3.7 decimals out of 50 decimals in **R.S.Dag No.17, I.R.Dag No.4, R.S.Khatian No.97** of Nischintapur Mouza, **J.L.No.53** in 2009 to **DEVALOKE DEVELOPERS LIMITED**(Donor herein) registered at D.S.R. - IV, Alipore and recorded in Book No.I,C.D. Volume No. 4, Pages- 167 to179 being No.1355 for the year 2009.

AND WHEREAS One Sirajul Haque Fakir & Farida Khatun jointly sold the land measuring more or less 1 Cottah 12 Chhattaks equivalent to 3 decimals out of 50 decimals in **R.S.Dag No.17, I.R.Dag No.4, R.S.Khatian No.97** of Nischintapur Mouza, **J.L.No.53** in 2009 to **DEVALOKE DEVELOPERS LIMITED**(Donor herein) registered at D.S.R.-IV, Alipore and recorded in Book No.I,C.D. Volume No.4, Pages- 154 to166 being No.1354 for the year 2009.

AND WHEREAS One Nur Mohammad Halder sold the land measuring more or less 2 Cottahs 8 Chhattaks equivalent to 4 decimals out of 50 decimals in **R.S.Dag No.17, I.R.Dag No.4, R.S.Khatian No.97** of Nischintapur Mouza, **J.L.No.53** in 2009 to **DEVALOKE DEVELOPERS LIMITED**(Donor herein) registered at D.S.R.-IV, Alipore and recorded in Book No.I,C.D. Volume No. 13, Pages- 433 to445 being No.4028 for the year 2009.

AND WHEREAS One Faraz Gayen alias Faraz Gayen , Jummad Ali Gayen alias Jumman Ali Gayen and Alema Bibi alias Aleya Bibi jointly sold the land measuring 8.5 decimals out of 17 decimals in **R.S.Dag No.18, I.R.Dag No.6** of Nischintapur Mouza, **J.L.No.53** in 2013 to **DEVALOKE DEVELOPERS LIMITED**(Donor herein) registered at D.S.R.-IV, Alipore office and recorded in Book No.I, C.D. Volume No.41, Pages-



AND WHEREAS One Faraz Gayen alias Faraz Gayen , Jummad Ali Gayen alias Jumman Ali Gayen and Alema Bibi alias Aleya Bibi jointly sold the land measuring 14 Cottahs 14 Chhattaks 41 Sq ft. equivalent to 24.68 decimals out of 25 decimals in R.S.Dag No.19, L.R.Dag No.8 of Nischintapur Mouza, J.L.No.53 in 2013 to **DEVALOKE DEVELOPERS LIMITED**(Donor herein) registered at D.S.R.-IV, Alipore office and recorded in Book No.I, C.D. Volume No.42, Pages-1526 to1538 being No.8248 for the year 2013.

AND WHEREAS One Faraz Gayen alias Faraz Gayen , Jummad Ali Gayen alias Jumman Ali Gayen and Alema Bibi alias Aleya Bibi jointly sold the land measuring 14 decimals in R.S.Dag No.18/494, L.R.Dag No.5 of Nischintapur Mouza, J.L.No.53 in 2013 to **DEVALOKE DEVELOPERS LIMITED**(Donor herein) registered at D.S.R.-IV, Alipore office and recorded in Book No.I, C.D. Volume No.41, Pages-2696 to2708 being No.8088 for the year 2013.

AND WHEREAS thus the said Donor/ Giver became the absolute owner of the land measuring more or less 1156.3 decimals } (the split up of the land & Mouza being :- 5 decimals of R.S.Dag No.407, L.R.Dag No.449, R.S.Khatian No.65, L.R.Khatian No.1257, + 16 decimals of R.S.Dag No.408, L.R.Dag No.450, R.S.Khatian No.456, L.R.Khatian No.1257 + 38 decimals of R.S.Dag No.412, L.R.Dag No.454, R.S.Khatian No.168, L.R.Khatian No.1257+ 8.5 decimals out of 64 decimals of R.S.Dag No.416, L.R.Dag No.458, R.S.Khatian No.442, L.R.Khatian No.1257 + 21 decimals of R.S.Dag No.417, L.R.Dag No.459, R.S.Khatian No.172, L.R.Khatian No.1257 + 10 decimals of R.S.Dag No.418, L.R.Dag No.460, R.S.Khatian No.456, L.R.Khatian No.1257 + 10 decimals of R.S.Dag No.419, L.R.Dag No.461, R.S.Khatian No.438, L.R.Khatian No.1257 + 27 decimals but physical possession more or less 25 decimals of R.S.Dag No.420, L.R.Dag No.462, R.S.Khatian No.442, L.R.Khatian No.1257 + 17 decimals of R.S.Dag No.421, L.R.Dag No.463, R.S.Khatian No.137, L.R.Khatian No.1257 + 12 decimals out of 30 decimals of R.S.Dag No.433, L.R.Dag No.473, R.S.Khatian No.19, L.R.Khatian No.1257 + 6 decimals out of 8 decimals of R.S.Dag No.433/811, L.R.Dag No.475, R.S.Khatian No.19, L.R.Khatian No.1257 + 9 decimals out of 36 decimals of R.S.Dag No.434, L.R.Dag No.476, R.S.Khatian No.452, L.R.Khatian No.1257 + 14 decimals of R.S.Dag No.435,



mals of R.S.Dag No.436, L.R.Dag No.478, R.S.Khatian No.452, L.R.Khatian No.1257
 + 8 decimals of R.S.Dag No.437, L.R.Dag No.479, R.S.Khatian No.452, L.R.Khatian
 No.1257 + 27.5 decimals out of 29 decimals of R.S.Dag No.438, L.R.Dag No.480,
 R.S.Khatian No.452, L.R.Khatian No.1257 + 14 decimals of R.S.Dag No.439, L.R.Dag
 No.481, R.S.Khatian No.452, L.R.Khatian No.1257 + 12 decimals of R.S.Dag No.440,
 L.R.Dag No.482, R.S.Khatian No.190, L.R.Khatian No.1257 + 11 decimals of R.S.Dag
 No.441, L.R.Dag No.483, R.S.Khatian No.190, L.R.Khatian No.1257 + 25 decimals of
 R.S.Dag No.442, L.R.Dag No.484, R.S.Khatian No.442, L.R.Khatian No.1257 + 7
 decimals of R.S.Dag No.443, L.R.Dag No.485, R.S.Khatian No.190, L.R.Khatian
 No.1257 + 5 decimals of R.S.Dag No.445, L.R.Dag No.487, R.S.Khatian No.88,
 L.R.Khatian No.1257 + 6 decimals of R.S.Dag No.447, L.R.Dag No.488, R.S.Khatian
 No.88, L.R.Khatian No.1257 + 43 decimals of R.S.Dag No.448, L.R.Dag No.489,
 R.S.Khatian No.294, L.R.Khatian No.1257 + 47 decimals of R.S.Dag No.449, L.R.Dag
 No.490, R.S.Khatian No.1627, L.R.Khatian No.1257 + 40 decimals of R.S.Dag No.450,
 L.R.Dag No.491, R.S.Khatian No.182, L.R.Khatian No.1257 + 32 decimals of R.S.Dag
 No.451, L.R.Dag No.492, R.S.Khatian No.176, L.R.Khatian No.1257 + 22 decimals of
 R.S.Dag No.452, L.R.Dag No.493, R.S.Khatian No.44, L.R.Khatian No.1257 + 19
 decimals of R.S.Dag No.453, L.R.Dag No.494, R.S.Khatian No.137, L.R.Khatian
 No.1257 + 20 decimals of R.S.Dag No.454, L.R.Dag No.495, R.S.Khatian No.65
 L.R.Khatian No.1257 + 23 decimals of R.S.Dag No.455, L.R.Dag No.496, R.S.Khatian
 No.65, L.R.Khatian No.1257 + 24 decimals of R.S.Dag No.456, L.R.Dag No.497,
 R.S.Khatian No.456, L.R.Khatian No.1257 + 92 decimals of R.S.Dag No.457, L.R.Dag
 No.498, R.S.Khatian No.172, L.R.Khatian No.1257 + 54 decimals of R.S.Dag No.458,
 L.R.Dag No.499, R.S.Khatian No.70, L.R.Khatian No.1257 + 25 decimals out of 35 of
 R.S.Dag No.459, L.R.Dag No.500, R.S.Khatian No.200, L.R.Khatian No.1257 + 52
 decimals out of 103 decimals of R.S.Dag No.460, L.R.Dag No.501, R.S.Khatian No.44,
 L.R.Khatian No.1257 + 16 decimals of R.S.Dag No.464, L.R.Dag No.505, R.S.Khatian
 No.278, L.R.Khatian No.1257 } Mouze-Jagannathpur, J.L.No.51, Touzi No.271 } + ((
 3.3 out of 27 decimals of R.S.Dag No.400, L.R.Dag No.431, L.R.Khatian No.2480 +
 28 decimals out of 36 decimals of R.S.Dag No.404, L.R.Dag No.439, R.S.Khatian No.321,
 L.R.Khatian No.2480 + 25 decimals of R.S.Dag No.411, L.R.Dag No.446, R.S.Khatian



326, L.R.Khatian No.2480 + 12 decimals of R.S.Dag No.412, L.R.Dag No.434, R.S.Khatian No. 257 L.R.Khatian No.2480 + 4 decimal of R.S. Dag No.413, L.R.Dag No.435, R.S.Khatian No. 326, L.R.Khatian No.2480 + 4 decimals of R.S.Dag No.414 L.R.Dag No.436, R.S.Khatian No.326 L.R.Khatian No.2480 + 15 decimals decimals of R.S.Dag No.416, L.R.Dag No.447, R.S.Khatian No.326, L.R.Khatian No.2480 + 37 decimals of R.S.Dag No.417, L.R.Dag No.448, R.S.Khatian No.326 L.R. Khatian No.2480) of Tegheria Mouza, J.L.No.52, } + 14 decimals of R.S.Dag No.4, L.R.Dag No.1, R.S.Khatian No.273, L.R.Khatian No.948 + 12 decimals of R.S.Dag No.5, L.R.Dag No.2, R.S.Khatian No.223, L.R.Khatian No.948 + 16 decimals of R.S.Dag No.6, L.R.Dag No.3, R.S.Khatian No.569, L.R.Khatian No.948+ 14 decimals of R.S.Dag No.14, L.R.Dag No.10, R.S.Khatian No.10, L.R.Khatian No.948 + 17.decimals of R.S.Dag No.15, L.R.Dag No.9, R.S.Khatian No.10 L.R.Khatian No.948, + 32 decimals of R.S.Dag No.16, L.R.Dag No.7, R.S.Khatian No.97, L.R.Khatian No.948 + 50 decimals of R.S.Dag No.17, L.R.Dag No.4, R.S.Khatian No.97, L.R.Khatian No.948 + 16decimals of R.S.Dag No.18, L.R.Dag No.6, R.S.Khatian No.97 L.R.Khatian No.948 + 14 decimals of R.S.Dag No.18/494, L.R.Dag No.5, R.S.Khatian No.97, L.R.Khatian No.948 + 25 decimals of R.S.Dag No.19, L.R.Dag No.8, R.S.Khatian no.11, L.R.Khatian No.948) of Nischintapur, Mouza, J.L.No.53, } } , Pargana- Medannolla, P.S. Sonarpur, A.D.S.R.office at Sonarpur & Garia, Holding No.1117, Shimulala, Ward No.8 of Rajpur Sonarpur Municipality, P.S.Sonarpur, District-South 24-Pargana, which is fully described in the Schedule hereunder written.

AND WHEREAS Donees/Receiver being the well wisher of the Donors/givers and the Donees/Receivers are the lawful possessor of the adjacent land of the Donor/givers and the Donor/Giversal ways desire the betterment of the Donees/Receivers and the Donor/ Giver approached the Donees/Receivers to accept the gift of the undivided 8 Chataks of the land measuring 1156.3 decimals herein gifted in favour of the Donees/Receivers for their both interest and the said undivided area of land more particularly mentioned hereunder schedule below and the Govt. market value of the gifted property is Rs60,000/- (Rupees Sixty Thousand - only).



NOW THIS GIFT WITNESSETH : that in pursuance of the consideration, the Donor/Giver, with the execution of this deed, relinquishes all claims into or upon the undivided share, i.e. 8 chatraks out of 1156.3 decimals of land, fully described in the Schedule hereunder written, or every part thereof **TO HAVE AND TO HOLD** the same conditionally hereby donated, conveyed and transferred unto the said Donees/Receivers, their heirs, executors, administrators, representatives and assigns and the Donees/Receivers accept the gift of the said undivided land **NOTWITHSTANDING** any act, deed or thing herein before done, executed or knowingly suffered to the contrary the said Donees/Receivers are now lawfully seized and possessed of the said undivided land which is free from all sorts of encumbrances, attachments, charges whatsoever the Donor/Giver have full power and absolute authority to transfer and convey the said undivided land which is fully described in the Schedule hereunder written and also total area of land of Donor and Donees shown in the map or plan annexed hereto by Red border.

THE SCHEDULE REFERRED TO ABOVE

ALL THAT piece and parcel of the undivided 8 Chatraks out of the 1156.3 decimals of the split up of the land & Mouza being :-6.54 Sq.ft. out of 5 decimals of Dowa land of R.S.Dag No.407, L.R.Dag No.449, R.S.Khatian No.65, L.R.Khatian No.1257, + 6.54 sq.ft. out of 16 decimals of Danga land of R.S.Dag No.408, L.R.Dag No.450, L.R.Khatian No.1257 + 6.54 Sq.ft. out of 38 decimals of Bagan land of R.S.Dag No.412, L.R.Dag No.454, R.S.Khatian 168, L.R.Khatian No.1257 + 6.54 Sq.ft. out of 8.5 decimals out of 64 decimals of Danga land of R.S.Dag No.416, L.R.Dag No.458, R.S.Khatian No.442, L.R.Khatian No.1257 + 6.54 Sq.ft. out of 21 decimals of Danga land of R.S.Dag No.417, L.R.Dag No.459, R.S.Khatian No.172, L.R.Khatian No.1257 + 6.54 Sq.ft. out of 10 decimals Sali land of R.S.Dag No.418, L.R.Dag No.460, R.S.Khatian No.456, L.R.Khatian No.1257 + 6.54 Sq.ft. out of 10 decimals of Bagan land of R.S.Dag



out of 25 decimals of pukur of R.S.Dag No.420, L.R.Dag No.462, R.S.Khatian No.4
 L.R.Khatian No.1257 + 6.54 Sq.ft. out of 17 decimals Danga land of R.S.Dag No.4
 L.R.Dag No.463, R.S.Khatian No.137, L.R.Khatian No.1257 + 6.54Sq.ft. out of
 decimals out of 30 decimals Sali land of R.S.Dag No.433, L.R.Dag No.473, R.S.Khat
 No.19, L.R.Khatian No.1257 + 6.54 Sq.ft. out of 6 decimals out of 8 decimals Dova land
 R.S.Dag No.433/811, L.R.Dag No.475, R.S.Khatian No.19, L.R.Khatian No.1257
 6.54 Sq.ft. out of 9 decimals out of 36 decimals of Danga land of R.S.Dag No.43.
 L.R.Dag No.476, R.S.Khatian No.452, L.R.Khatian No.1257 + 6.54 Sq. ft out of 1
 decimals Bagan land of R.S.Dag No.435, L.R.Dag No.477, R.S.Khatian No.451
 L.R.Khatian No.1257 + 6.54 Sq.ft. out of 3 decimals out of 6 decimals Dova land o
 R.S.Dag No.436, L.R.Dag No.478, R.S.Khatian No.452, L.R.Khatian No.1257 + 6.54
 Sq.ft. out of 8 decimals of Dova land of R.S.Dag No.437, L.R.Dag No.479, R.S.Khatian
 No.452, L.R.Khatian No.1257 + 6.54 Sq.ft. out of 27.5 decimals out of 29 decimals
 Sali land of R.S.Dag No.438, L.R.Dag No.480, R.S.Khatian No.452, L.R.Khatian
 No.1257 + 6.54 Sq.ft. out of 14 decimals Bagan land of R.S.Dag No.439, L.R.Dag
 No.481, R.S.Khatian No.452 L.R.Khatian No.1257 + 6.54 Sq.ft. out of 12 decimals
 Danga land of R.S.Dag No.440, L.R.Dag No.482, R.S.Khatian No.190, L.R.Khatian
 No.1257 + 6.54 Sq.ft. out of 11 decimals Sali land of R.S.Dag No.441, L.R.Dag No.483,
 R.S.Khatian No.190, L.R.Khatian No.1257 + 6.54 Sq.ft. out of 25 decimals Danga of
 R.S.Dag No.442, L.R.Dag No.484, R.S.Khatian No.442, L.R.Khatian No.1257 + 6.54
 Sq.ft. out of 7 decimals Sali land of R.S.Dag No.443, L.R.Dag No.485, R.S.Khatian
 No.190, L.R.Khatian No.1257 + 6.54 Sq.ft. out of 5 decimals of Sali land of R.S.Dag
 No.445, L.R.Dag No.487 R.S.Khatian No.88, L.R.Khatian No.1257 + 6.54 Sq.ft. out
 of 6 decimals Sali land of R.S.Dag No.447, L.R.Dag No.488, R.S.Khatian No.88,
 L.R.Khatian No.1257 + 6.54 Sq.ft. out of 43 decimals of Danga land of R.S.Dag No.448,
 L.R.Dag No.489, L.R.Khatian No.1257 + 6.54 sq.ft. out of 47 decimals Sali land of
 R.S.Dag No.449, L.R.Dag No.490, R.S.Khatian No.162/2, L.R.Khatian No.1257 +
 6.54 Sq.ft. out of 40 decimals Danga land of R.S.Dag No.450, L.R.Dag No.491,
 R.S.Khatian No.182, L.R.Khatian No.1257 + 6.54 Sq.ft. out of 32 decimals Danga land
 of R.S.Dag No.451, L.R.Dag No.499



6.54 Sq.ft. out of 22 decimals Danga land of R.S.Dag No.452, L.R.Dag No.493,
 R.S.Khatian No.65, L.R.Khatian No.1257 + 6.54 Sq.ft. out of 19 decimals Danga land of
 R.S.Dag No.453, L.R.Dag No.494, R.S.Khatian No.137, L.R.Khatian No.1257 + 6.54
 Sq.ft. out of 20 decimals of Danga land of R.S.Dag No.454, L.R.Dag No.495,
 L.R.Khatian No.1257 + 6.54 Sq.ft. out of 23 decimals Danga land of R.S.Dag No.455,
 L.R.Dag No.496, R.S.Khatian No.65, L.R.Khatian No.1257 + 6.54 Sq.ft. out of 24
 decimals pukur of R.S.Dag No.456, L.R.Dag No.497, R.S.Khatian No.456,
 L.R.Khatian No.,1257 + 6.54 Sq.ft. out of 92 decimals Bagan land of R.S.Dag No.457,
 L.R.Dag No.498, R.S.Khatian No.172, L.R.Khatian No.1257 + 6.54 Sq.ft. out of 54
 decimals Danga land of R.S.Dag No.458, L.R.Dag No.499, R.S.Khatian No.70,
 L.R.Khatian No.1257 + 6.54 Sq.ft. out of 25 decimals out of 35 decimals of Sali land of
 R.S.Dag No.459, L.R.Dag No.500, R.S.Khatian No.200, L.R.Khatian No.1257 + 6.54
 Sq.ft. out of 52 decimals out of 103 decimals of Danga land of R.S.Dag No.460, L.R.Dag
 No.501, R.S.Khatian No.44, L.R.Khatian No.1257 + 6.54 Sq.ft. out of 16 decimals of
 Bagan land of R.S.Dag No.464, L.R.Dag No.505, R.S.Khatian No.278 L.R.Khatian
 No.1257) Mouza-Jagannathpur, J.L.No.51, Touzi No.271, } + { (6.565 Sq.ft. out of
 3.3 decimals out of 27 decimals of bastu land of R.S.Dag No.460, L.R.Dag No.431,
 L.R.Khatian No.2480 + 6.565 Sq.ft. out of 28 decimals out 36 decimals Bastu land of
 R.S.Dag No.404, L.R.Dag No.439, R.S.Khatian No.321, L.R.Khatian No.2480 + 6.565
 Sq.ft. out of 25 decimals Bagan land of R.S.Dag No.411, L.R.Dag No.446, R.S.Khatian
 326, L.R.Khatian No.2480 + 6.565 Sq.ft. out of 12 decimals Danga land of R.S.Dag
 No.412, L.R.Dag No.434, R.S.Khatian No.257, L.R.Khatian No.2480 + 6.565 Sq.ft.
 out of 4 decimal of Danga land of R.S.Dag No.413, L.R.Dag No.435, R.S.Khatian No
 326, L.R.Khatian No.2480 + 6.565 Sq.ft. out of 4 decimals Danga land of R.S.Dag
 No.414, L.R.Dag No.436, R.S.Khatian No.326, L.R.Khatian No.2480 + 6.565 Sq.ft.
 out of 15 decimals of Sali of R.S.Dag No.416, L.R.Dag No.447, R.S.Khatian No.326
 L.R.Khatian No.2480 + 6.565 Sq.ft. out of 37 decimals of Danga land of R.S.Dag
 No.417, L.R.Dag No.448, R.S.Khatian No.326, L.R.Khatian No.2480) of Teghoria
 Mouza, J.L.No.52, } + { (6.55 Sq.ft. out of 14 decimals of Danga land of R.S.Dag
 No.4, L.R.Dag No.1, R.S.Khatian No.273, L.R.Khatian No.948 + 6.55 Sq.ft. out of
 17 decimals of Danga land of R.S.Dag No.5, L.R.Dag No.2, R.S.Khatian No.223.



L.R.Khatian No.948 + 6.55 Sq.ft. out of 16 decimals of Danga land of R.S.Dag No.6, L.R.Dag No.3, R. S.Khatian No.569, L.R.Khatian No.948+ 6.55 Sq.ft. out of 14 decimals Sali land of R.S.Dag No.14, L.R.Dag No.10, R.S.Khatian No.10, L.R.Khatian No.948 + 6.55 Sq.ft. out of 17 decimals of sali land of R.S.Dag No.15, L.R.Dag No.9, R.S.Khatian No.10 L.R.Khatian No.948, + 6.55 Sq.ft. out of 32 decimals Danga land of R.S.Dag No.16, L.R.Dag No.7, R.S.Khatian No.97 L.R.Khatian No.948 + 6.55 Sq.ft. out of 50 decimals of R.S.Dag No.17, L.R.Dag No.4, R.S.Khatian No.97, L.R.Khatian No.948+ 6.55 Sq.ft. out of 16 decimals of Danga land of R.S.Dag No.18, L.R.Dag No.6, L.R.Khatian No.948 R.S.Khatian No.97+6.55 Sq.ft. out of 14 decimals of R.S.Dag No.18/494, L.R.Dag No.5, L.R.Khatian No.948, R.S.Khatian No.97 + 6.55 Sq.ft. out of 25 decimals of Danga land of R.S.Dag No.19, L.R.Dag No.8, L.R.Khatian No.948, R.S.Khatian No.11) of Nischintapur, Mouza, J.L.No.53.)]].
Pargana- Medammolla, P.S. Sonarpur, A.D.S.R. office at Sonarpur & Garia, Holding No.1117, Shimultala, Ward No.8 of Raipur-Sonarpur Municipality, P.S.Sonarpur, District- South 24-Pargana

IN WITNESS WHEREOF the Donors/Givers have hereunto set and subscribed their hand, seal and signature on the day, month and year first above written

SIGNED, SEALED AND DELIVERED

of the Donor/Giver

In Presence of WITNESSES:-

1. *Daksh Bandyopadhyay*
49, Gan Ni Rd
Sector-84
2. *Sathi Kishore*

FOR DEVELOPER DEVELOPERS LTD.

Sudhakar

Director

SIGNATURE OF THE DONOR/GIVER.



SIGNED, SEALED AND DELIVERED

of the Donees/Receivers

In Presence of **WITNESSES:-**

1. *Qaim Ayubi*
47, Gnd Floor Rd
Baruipur. 84
2. *Sahib Khatun*

Sahib Khatun

Constituted Attorney of

- 1) **ABDUR RAUF SARDAR** alias
ABDUR ROUF SARKAR,
- 2) **JAHANARA BIBI,**
- 3) **RAFIKUL ALAM SARKAR,** and
- 4) **HOSNEARA BIBI** alias
HOSSENARA BIBI,

SIGNATURE OF THE DONEES/RECEIVERS

Prepared and Drafted by me

Tarun Kanti Chakrabarti

TARUN KANTI CHAKRABARTI

Advocate, F.No. 853/95

Baruipur Civil Court.

Printed By me:-

C. Khatun





Left Hand	Right Hand	Thumb	1st. Finger	Middle Finger	Ring Finger	Small finger

Name SUKANTA KUNDU

Signature *Sukanta Kundu*

Photo	Left Hand	Thumb	1st. Finger	Middle Finger	Ring Finger	Small finger
	Right Hand					

Name

Signature

Photo	Left Hand	Thumb	1st. Finger	Middle Finger	Ring Finger	Small finger
	Right Hand					

Name

Signature

Photo	Left Hand	Thumb	1st. Finger	Middle Finger	Ring Finger	Small finger
	Right Hand					

Name

Signature



PLAN AT MOUZA - TEHSEEL J. L. NO. 52 R. S. DAG
 OS -400(P), 404(P), 411, 412, 413, 414, 416, 417 AND
 MOUZA - NISCHINTAPUR J. L. NO. 83 R. S. DAG NOS. 4, 5
 6, 14, 15, 16, 17, 18, 19, 20 AND MOUZA -
 JAGANNATHPUR J. L. NO. 51 R. S. DAG NOS. 407, 408(P),
 412, 416(P), 417, 418, 419, 420, 421, 430(P), 431, 432, 435,
 436(P), 437, 438(P), 439, 440, 441, 442, 443, 445, 447, 448, 449,
 450, 451, 452, 453, 454, 455, 456, 457, 458, 459, 460, 464, P. 5
 - SONARPUR, DIST. - SOUTH-24 PARGANAS (WARD NO. 8
 UNDER RAJPUR - SONARPUR MUNICIPALITY)

SCALE - 1" INCH = 150 FT
 TOTAL LAND AREA = 1217.30 DEC. OR 49261.97 SQ. M.
 (AS PER DEED & PARCHA)
 TOTAL LAND AREA = 49017.36 SQ. M.
 (AS PER PHYSICAL MEASUREMENT)
 TOTAL LAND AREA (AS PER PHYSICAL MEASUREMENT)
 SHOWN IN RED BORDER

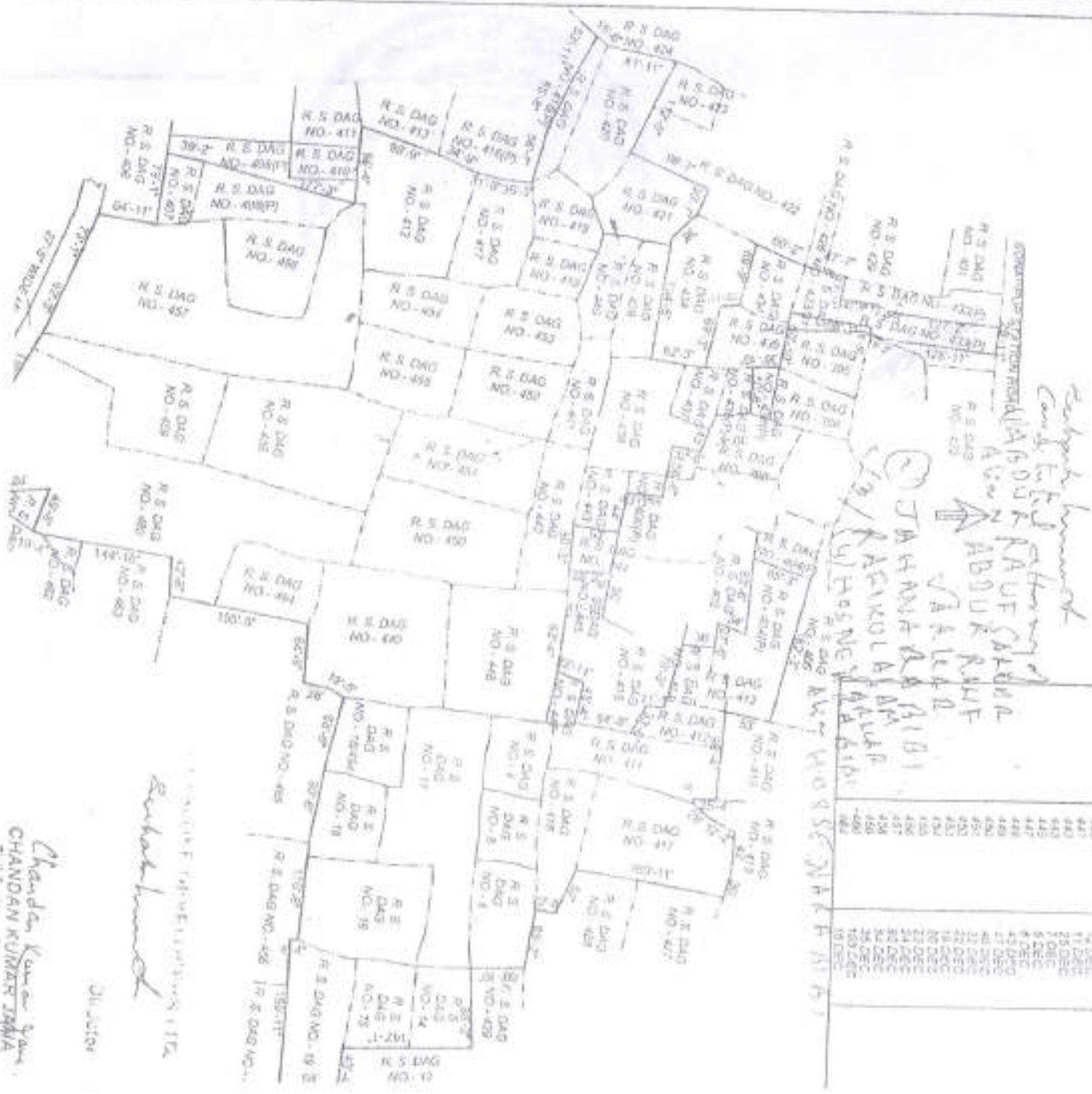

MOUZA	R. S. DAG NO.	LAND AREA (TOTAL)
TEHRAN	400(P)	28.287
	404(P)	28.287
	411	28.287
	412	28.287
	413	28.287
	414	28.287
	416	28.287
	417	28.287
	418	28.287
	419	28.287
MOUZA - NISCHINTAPUR	4	28.287
	5	28.287
	6	28.287
	14	28.287
	15	28.287
	16	28.287
	17	28.287
	18	28.287
	19	28.287
	20	28.287
MOUZA - JAGANNATHPUR	407	28.287
	408(P)	28.287
	412	28.287
	416(P)	28.287
	417	28.287
	418	28.287
	419	28.287
	420	28.287
	430(P)	28.287
	431	28.287

Chandan Kumar Pan
 CHANDAN KUMAR PAN
 Director

★ Addl. Dist. Sub-Registrar ★
Sonapet, South 24 Pgs.
11.10.2015

★ Additional District Sub-Registrar ★
Sonapet, South 24 Pgs.

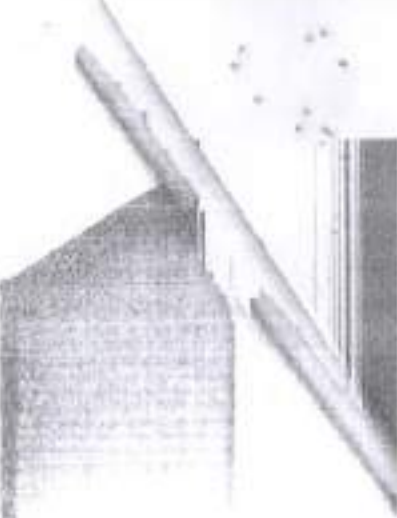

Seller, Buyer and Property Details

Donor & Donee Details

Presentant Details

Sl. No. Name, Address, Photo, Finger print and Signature of Presentant

1	Mr. Sukeanta Kundu 16 Nazrul Pally, Mahamayatala, P.O.-Garia, P.S.- Sonarpur, Rajpur-sonarpur, District-South 24- Parganas, West Bengal, India, PIN-700094		
		14/10/2015 3:41:45 PM	14/10/2015 3:41:51 PM
<i>Sukeanta Kundu</i>			
14/10/2015 3:42:23 PM			

Donor Details

Sl. No. Name, Address, Photo, Finger print and Signature

1	Devaloke Developers Limited 47 Garia Main Road, P.O.-Garia, P.S.-Sonarpur, Rajpur-sonarpur, District-South 24- Parganas, West Bengal, India, PIN-700094. Status: Organization. Represented by representative as given below.		
		14/10/2015 3:41:45 PM	14/10/2015 3:41:51 PM
<i>Sukeanta Kundu</i>			
14/10/2015 3:42:23 PM			

Mr. Sukeanta Kundu
16 Nazrul Pally, Mahamayatala, P.O.-Garia, P.S.-
Sonarpur, Rajpur-sonarpur, District-South 24-
Parganas, West Bengal, India, PIN-700094. Sex:
Male, Dy. Castel: Indian, Occupation: Business,
Citizen of India, Status: Representative, Date of
Execution: 14/10/2015, Date of Admission:
14/10/2015, Place of Admission of Execution:
Office

Donee Details

SL No.	Name, Address, Photo, Finger print and Signature
1	<p>Mr Abdur Rauf Sarkar (Alias: Mr Abdur Rauf Sarkar) Son of Mr Abdul Hakim Sarkar Jagannathpur, P.O.- RKPally, P.S.- Sonarpur, Rajpur-sonarpur, District: South 24-Parganas, West Bengal, India, PIN - 700150 Sex: Male, By Caste: Hindu, Occupation: Business, Citizen of India., Status : Individual</p>
2	<p>Mrs Jehanara Bibi Wife of Mr Yunus Ali Molla Poleghat, P.O.- Jagaddal, P.S.- Sonarpur, Rajpur-sonarpur, District: South 24-Parganas, West Bengal, India, PIN - 700151 Sex: Female, By Caste: Hindu, Occupation: House wife, Citizen of India., Status : Individual</p>
3	<p>Mr Rafikul Alam Sarkar Son of Mr Abdul Hakim Sarkar Jagannathpur, P.O.- RK-Pally, P.S.- Sonarpur, Rajpur-sonarpur, District: South 24-Parganas, West Bengal, India, PIN - 700150 Sex: Male, By Caste: Hindu, Occupation: Business, Citizen of India., Status : Individual</p>
4	<p>Mrs Hoarna Ara Bibi (Alias: Mrs Hosenara Bibi) Wife of Mr. Rabiul Haque Mondal B-3, Brahmapur Place, P.O.- Brahmapur, Bidamala, P.S.- Banadroni, District: South 24-Parganas, West Bengal, India, PIN - 700094 Sex: Female, By Caste: Hindu, Occupation: House wife, Citizen of India., Status : Individual; Represented by trait (14) constituted attorney as given below:</p>
14	<p>Mr Sulaita Kundu Son of Mr Sarkar (10-21) 18 Nazrul Pally, Mahanayabati., P.O.- Garia, P.S.- Sonarpur, Rajpur-sonarpur, District: South 24-Parganas, West Bengal, India, PIN - 700084 Sex: Male, By Caste: Hindu, Occupation: Business, Citizen of India., Status : Attorney; Date of Execution : 14/10/2015, Date of Admission : 14/10/2015- Place of Admission of Execution : Office</p>



14/10/2015 3:41:17 PM



14/10/2015 3:41:24 PM

Sulaita Kundu

14/10/2015 3:41:35 PM

B. Identifire Details

SL No.	Identifier Name & Address	Identifier Details	Identifier of	Signature

Identifier Details			
S. No.	Identifier Name & Address	Identifier of	Signature
1	Mr Ashish Bagchi Son of Late Joydeb Bagchi 47 Garia Main Road, P.O:- Garia, P.S.- Sonarpur, Rajpur-sonarpur, District:- South 24-Parganas, West Bengal, India, PIN - 700064 Sex: Male, BY Caste: Hindu, Occupation: Service, Citizen of: India.	Mr Sukanta Kundu, Mr Sukanta Kundu	<i>(Signature)</i> 14/10/2015 3:42:37 PM

C. Transacted Property Details

Sch No.	Property Location	Land Details				Other Details
		Plot No & Khatian No/ Road Zone	Area of Land	Setforth Value(In Rs.)	Market Value(In Rs.)	
L1	District: South 24-Parganas, P.S:- Sonarpur, Municipality: RAJPUR- SONARPUR, Mouza: Jagannathpur	LR Plot No:- 449 . LR Khatian No:- 1257	6.54 Sq Ft	909/-	5,495/-	Proposed Use: Bastu, ROR: Doba, Width of Approach Road: 30 Ft.
L2	District: South 24-Parganas, P.S:- Sonarpur, Municipality: RAJPUR- SONARPUR, Mouza: Jagannathpur	LR Plot No:- 450 . LR Khatian No:- 1257	6.54 Sq Ft	909/-	5,495/-	Proposed Use: Bastu, ROR: Danga, Width of Approach Road: 30 Ft.
L3	District: South 24-Parganas, P.S:- Sonarpur, Municipality: RAJPUR- SONARPUR, Mouza: Jagannathpur	LR Plot No:- 454 . LR Khatian No:- 1257	6.54 Sq Ft	909/-	5,495/-	Proposed Use: Bastu, ROR: Bagan, Width of Approach Road: 30 Ft.
L4	District: South 24-Parganas, P.S:- Sonarpur, Municipality: RAJPUR- SONARPUR, Mouza: Sonarpur	RS Plot No:- 419 . RS Khatian No:- 442	6.54 Sq Ft	909/-	7,194/-	Proposed Use: Bastu, ROR: Danga, Width of Approach Road: 30 Ft.
L5	District: South 24-Parganas, P.S:- Sonarpur, Municipality: RAJPUR- SONARPUR, Mouza: Jagannathpur	LR Plot No:- 459 . LR Khatian No:- 1257	6.54 Sq Ft	909/-	5,495/-	Proposed Use: Bastu, ROR: Danga, Width of Approach

Land Details						
Sl. No.	Property Location	Plot No. & Khatian No/ Road Zone	Area of Land	Setforth Value(In Rs.)	Market Value(In Rs.)	Other Details
L6	District: South 24-Parganas, P.S.- Sonarpur, Municipality: RAJPUR- SONARPUR, Mouza: Jagannathpur	LR Plot No:- 460 . LR Khatian No:- 1257	6.54 Sq Ft	909/-	5,495/-	Proposed Use: Bastu, ROR: Small, Width of Approach Road: 30 Ft.
L7	District: South 24-Parganas, P.S.- Sonarpur, Municipality: RAJPUR- SONARPUR, Mouza: Jagannathpur	LR Plot No:- 461 . LR Khatian No:- 1257	6.54 Sq Ft	909/-	5,495/-	Proposed Use: Bastu, ROR: Bagan, Width of Approach Road: 30 Ft.
L8	District: South 24-Parganas, P.S.- Sonarpur, Municipality: RAJPUR- SONARPUR, Mouza: Jagannathpur	LR Plot No:- 462 . LR Khatian No:- 1257	6.54 Sq Ft	909/-	5,495/-	Proposed Use: Bastu, ROR: Pukur, Width of Approach Road: 30 Ft.
L9	District: South 24-Parganas, P.S.- Sonarpur, Municipality: RAJPUR- SONARPUR, Mouza: Jagannathpur	LR Plot No:- 463 . LR Khatian No:- 1257	6.54 Sq Ft	909/-	5,495/-	Proposed Use: Bastu, ROR: Danga, Width of Approach Road: 30 Ft.
L10	District: South 24-Parganas, P.S.- Sonarpur, Municipality: RAJPUR- SONARPUR, Mouza: Jagannathpur	LR Plot No:- 473 . LR Khatian No:- 1257	6.54 Sq Ft	909/-	8,793/-	Proposed Use: Bastu, ROR: Small, Width of Approach Road: 30 Ft.
L11	District: South 24-Parganas, P.S.- Sonarpur, Municipality: RAJPUR- SONARPUR, Mouza: Jagannathpur	LR Plot No:- 475 . LR Khatian No:- 1257	6.54 Sq Ft	909/-	8,793/-	Proposed Use: Bastu, ROR: Doba, Width of Approach Road: 30 Ft.
L12	District: South 24-Parganas, P.S.- Sonarpur, Municipality: RAJPUR- SONARPUR, Mouza: Jagannathpur	LR Plot No:- 476 . LR Khatian No:- 1257	6.54 Sq Ft	909/-	5,495/-	Proposed Use: Bastu, ROR: Danga, Width of Approach Road: 30 Ft.

Sl. No.	Property Location	Land Details				Other Details
		Plot No & Road Zone	Area of Land	Settorth Value(In Rs.)	Market Value(In Rs.)	
L13	District: South 24-Ferganas, P.S.- Sonarpur, Municipality: RAJPUR- SONARPUR, Mouza: Jagannathpur	LR Plot No:- 477 LR Khatian No:- 1257	6.54 Sq Ft	909/-	5,495/-	Proposed Use: Bastu, ROR: Bagan, Width of Approach Road: 30 Ft.
L14	District: South 24-Ferganas, P.S.- Sonarpur, Municipality: RAJPUR- SONARPUR, Mouza: Jagannathpur	LR Plot No:- 478 LR Khatian No:- 1257	6.54 Sq Ft	909/-	5,495/-	Proposed Use: Bastu, ROR: Doba, Width of Approach Road: 30 Ft.
L15	District: South 24-Ferganas, P.S.- Sonarpur, Municipality: RAJPUR- SONARPUR, Mouza: Jagannathpur	LR Plot No:- 479 LR Khatian No:- 1257	6.54 Sq Ft	909/-	5,495/-	Proposed Use: Bastu, ROR: Doba, Width of Approach Road: 30 Ft.
L16	District: South 24-Ferganas, P.S.- Sonarpur, Municipality: RAJPUR- SONARPUR, Mouza: Jagannathpur	LR Plot No:- 480 LR Khatian No:- 1257	6.54 Sq Ft	909/-	5,495/-	Proposed Use: Bastu, ROR: Shall, Width of Approach Road: 30 Ft.
L17	District: South 24-Ferganas, P.S.- Sonarpur, Municipality: RAJPUR- SONARPUR, Mouza: Jagannathpur	RS Plot No:- 439 RS Khatian No:- 452	6.54 Sq Ft	909/-	5,495/-	Proposed Use: Bastu, ROR: Bagan, Width of Approach Road: 30 Ft.
L18	District: South 24-Ferganas, P.S.- Sonarpur, Municipality: RAJPUR- SONARPUR, Mouza: Jagannathpur	LR Plot No:- 482 LR Khatian No:- 1257	6.54 Sq Ft	909/-	5,495/-	Proposed Use: Bastu, ROR: Danga, Width of Approach Road: 30 Ft.
L19	District: South 24-Ferganas, P.S.- Sonarpur, Municipality: RAJPUR- SONARPUR, Mouza: Jagannathpur	LR Plot No:- 483 LR Khatian No:- 1257	6.54 Sq Ft	909/-	5,495/-	Proposed Use: Bastu, ROR: Shall, Width of Approach Road: 30 Ft.

Land Details						
Plot No.	Property Location	Plot No & Khatian No/ Road Zone	Area of Land	Setforth Value(In Rs.)	Market Value(In Rs.)	Other Details
L20	District: South 24-Parganas, P.S.- Sonarpur, Municipality: RAJPUUR- SONARPUR, Mouza: Jagannathpur	LR Plot No:- 484 . LR Khatian No:- 1257	6.54 Sq Ft	909/-	5,495/-	Proposed Use: Bastu, ROR: Danga, Width of Approach Road: 30 Ft.
L21	District: South 24-Parganas, P.S.- Sonarpur, Municipality: RAJPUUR- SONARPUR, Mouza: Jagannathpur	LR Plot No:- 485 . LR Khatian No:- 1267	6.54 Sq Ft	909/-	5,495/-	Proposed Use: Bastu, ROR: Shail, Width of Approach Road: 30 Ft.
L22	District: South 24-Parganas, P.S.- Sonarpur, Municipality: RAJPUUR- SONARPUR, Mouza: Jagannathpur	LR Plot No:- 487 . LR Khatian No:- 1257	6.54 Sq Ft	909/-	5,495/-	Proposed Use: Bastu, ROR: Shail, Width of Approach Road: 30 Ft.
L23	District: South 24-Parganas, P.S.- Sonarpur, Municipality: RAJPUUR- SONARPUR, Mouza: Jagannathpur	LR Plot No:- 488 . LR Khatian No:- 1257	6.54 Sq Ft	909/-	5,495/-	Proposed Use: Bastu, ROR: Shail, Width of Approach Road: 30 Ft.
L24	District: South 24-Parganas, P.S.- Sonarpur, Municipality: RAJPUUR- SONARPUR, Mouza: Jagannathpur	LR Plot No:- 489 . LR Khatian No:- 1257	6.54 Sq Ft	909/-	5,495/-	Proposed Use: Bastu, ROR: Danga Width of Approach Road: 30 Ft.
L25	District: South 24-Parganas, P.S.- Sonarpur, Municipality: RAJPUUR- SONARPUR, Mouza: Jagannathpur	LR Plot No:- 490 . LR Khatian No:- 1257	6.54 Sq Ft	909/-	5,495/-	Proposed Use: Bastu, ROR: Shail, Width of Approach Road: 30 Ft.
L26	District: South 24-Parganas, P.S.- Sonarpur, Municipality: RAJPUUR- SONARPUR, Mouza: Jagannathpur	LR Plot No:- 491 . LR Khatian No:- 1257	6.54 Sq Ft	909/-	5,495/-	Proposed Use: Bastu, ROR: Dangi Width of Approach Road: 30 Ft.

Land Details						
Sl. No.	Property Location	Plot No & Khatain No/ Road Zone	Area of Land	Setorth Value(In Rs.)	Market Value(In Rs.)	Other Details
L27	District: South 24-Parganas, P.S.- Sonarpur, Municipality: RAJPUR- SONARPUR, Mouza: Jagannathpur	LR Plot No:- 492 . LR Khatain No:- 1257	6.54 Sq Ft	909/-	5,495/-	Proposed Use: Bastu, ROR: Danga, Width of Approach Road: 30 Ft.,
L28	District: South 24-Parganas, P.S.- Sonarpur, Municipality: RAJPUR- SONARPUR, Mouza: Jagannathpur	LR Plot No:- 493 . LR Khatain No:- 1257	6.54 Sq Ft	909/-	5,495/-	Proposed Use: Bastu, ROR: Danga, Width of Approach Road: 30 Ft.,
L29	District: South 24-Parganas, P.S.- Sonarpur, Municipality: RAJPUR- SONARPUR, Mouza: Jagannathpur	LR Plot No:- 494 . LR Khatain No:- 1257	6.54 Sq Ft	909/-	5,495/-	Proposed Use: Bastu, ROR: Danga, Width of Approach Road: 30 Ft.,
L30	District: South 24-Parganas, P.S.- Sonarpur, Municipality: RAJPUR- SONARPUR, Mouza: Jagannathpur	LR Plot No:- 495 . LR Khatain No:- 1257	6.54 Sq Ft	909/-	5,495/-	Proposed Use: Bastu, ROR: Danga, Width of Approach Road: 30 Ft.,
L31	District: South 24-Parganas, P.S.- Sonarpur, Municipality: RAJPUR- SONARPUR, Mouza: Jagannathpur	LR Plot No:- 496 . LR Khatain No:- 1257	6.54 Sq Ft	909/-	5,495/-	Proposed Use: Bastu, ROR: Danga, Width of Approach Road: 30 Ft.,
L32	District: South 24-Parganas, P.S.- Sonarpur, Municipality: RAJPUR- SONARPUR, Mouza: Jagannathpur	RS Plot No:- 456 . RS Khatain No:- 456	6.54 Sq Ft	909/-	5,495/-	Proposed Use: Bastu, ROR: Pukur, Width of Approach Road: 30 Ft.,
L33	District: South 24-Parganas, P.S.- Sonarpur, Municipality: RAJPUR- SONARPUR, Mouza: Jagannathpur	LR Plot No:- 498 . LR Khatain No:- 1257	6.54 Sq Ft	909/-	5,495/-	Proposed Use: Bastu, ROR: Bagan, Width of Approach Road: 30 Ft.,

Land Details						
Sr No.	Property Location	Plot No & Khatian No/ Road Zone	Area of Land	Selforth Value(In Rs.)	Market Value(In Rs.)	Other Details
L34	District: South 24-Parganas, P.S:- Sonarpur, Municipality: RAJPUR- SONARPUR, Mouza: Jagannathpur	LR Plot No:- 499 . LR Khatian No:- 1257	6.54 Sq Ft	909/-	5,495/-	Proposed Use: Bastu, ROR: Danga, Width of Approach Road: 30 Ft.,
L35	District: South 24-Parganas, P.S:- Sonarpur, Municipality: RAJPUR- SONARPUR, Mouza: Jagannathpur	LR Plot No:- 500 . LR Khatian No:- 1257	6.54 Sq Ft	909/-	5,495/-	Proposed Use: Bastu, ROR: Shali, Width of Approach Road: 30 Ft.,
L36	District: South 24-Parganas, P.S:- Sonarpur, Municipality: RAJPUR- SONARPUR, Mouza: Jagannathpur	LR Plot No:- 501 . LR Khatian No:- 1257	6.54 Sq Ft	909/-	5,495/-	Proposed Use: Bastu, ROR: Danga, Width of Approach Road: 30 Ft.,
L37	District: South 24-Parganas, P.S:- Sonarpur, Municipality: RAJPUR- SONARPUR, Mouza: Jagannathpur	LR Plot No:- 505 . LR Khatian No:- 1257	6.54 Sq Ft	909/-	5,495/-	Proposed Use: Bastu, ROR: Bagan, Width of Approach Road: 30 Ft.,
L38	District: South 24-Parganas, P.S:- Sonarpur, Municipality: RAJPUR- SONARPUR, Mouza: Teghari	LR Plot No:- 431 . LR Khatian No:- 2480	6.565 Sq Ft	909/-	6,018/-	Proposed Use: Bastu, ROR: Bastu, Width of Approach Road: 30 Ft.,
L39	District: South 24-Parganas, P.S:- Sonarpur, Municipality: RAJPUR- SONARPUR, Mouza: Teghari	LR Plot No:- 439 . LR Khatian No:- 2480	6.565 Sq Ft	909/-	6,018/-	Proposed Use: Bastu, ROR: Bastu, Width of Approach Road: 30 Ft.,
L40	District: South 24-Parganas, P.S:- Sonarpur, Municipality: RAJPUR- SONARPUR, Mouza: Teghari	LR Plot No:- 448 . LR Khatian No:- 2480	6.565 Sq Ft	909/-	4,814/-	Proposed Use: Bastu, ROR: Bagan, Width of Approach Road: 30 Ft.,

Land Details						
Plot No.	Property Location	PLOT No & Khatian No/ Road Zone	Area of Land	Setforth Value(In Rs.)	Market Value(In Rs.)	Other Details
L41	District: South 24-Parganas, P.S.- Sonarpur, Municipality: RAJPUR- SONARPUR, Mouza: Teghari	LR Plot No:- 434 . LR Khatian No:- 2480	6.565 Sq Ft	909/-	4,814/-	Proposed Use: Bastu, ROR: Danga, Width of Approach Road: 30 Ft.,
L42	District: South 24-Parganas, P.S.- Sonarpur, Municipality: RAJPUR- SONARPUR, Mouza: Teghari	LR Plot No:- 435 . LR Khatian No:- 2480	6.565 Sq Ft	909/-	4,814/-	Proposed Use: Bastu, ROR: Danga, Width of Approach Road: 30 Ft.,
L43	District: South 24-Parganas, P.S.- Sonarpur, Municipality: RAJPUR- SONARPUR, Mouza: Teghari	LR Plot No:- 436 . LR Khatian No:- 2480	6.565 Sq Ft	909/-	4,814/-	Proposed Use: Bastu, ROR: Danga, Width of Approach Road: 30 Ft.,
L44	District: South 24-Parganas, P.S.- Sonarpur, Municipality: RAJPUR- SONARPUR, Mouza: Jagannathpur	LR Plot No:- 447 . LR Khatian No:- 2480	6.565 Sq Ft	909/-	5,516/-	Proposed Use: Bastu, ROR: Danga, Width of Approach Road: 30 Ft.,
L45	District: South 24-Parganas, P.S.- Sonarpur, Municipality: RAJPUR- SONARPUR, Mouza: Teghari	LR Plot No:- 448 . LR Khatian No:- 2480	6.565 Sq Ft	909/-	4,814/-	Proposed Use: Bastu, ROR: Danga, Width of Approach Road: 30 Ft.,
L46	District: South 24-Parganas, P.S.- Sonarpur, Municipality: RAJPUR- SONARPUR, Mouza: Nischintapur	LR Plot No:- 1 . LR Khatian No:- 948	6.55 Sq Ft	909/-	5,504/-	Proposed Use: Bastu, ROR: Danga, Width of Approach Road: 30 Ft.,
L47	District: South 24-Parganas, P.S.- Sonarpur, Municipality: RAJPUR- SONARPUR, Mouza: Nischintapur	LR Plot No:- 2 . LR Khatian No:- 948	6.55 Sq Ft	909/-	5,504/-	Proposed Use: Bastu, ROR: Danga, Width of Approach Road: 30 Ft.,

Land Details						
Sl. No.	Property Location	Plot No & Khatian No/ Road Zone	Area of Land	Setforth Value(In Rs.)	Market Value(In Rs.)	Other Detail
L48	District: South 24-Parganas, P.S.- Sonarpur, Municipality: RAJPUR- SONARPUR, Mouza: Nischintapur	LR Plot No:- 3 . LR Khatian No:- 948	6.55 Sq Ft	909/-	5,504/-	Proposed Use: Bastu, ROR: Dangi Width of Approach Road: 30 Ft.
L49	District: South 24-Parganas, P.S.- Sonarpur, Municipality: RAJPUR- SONARPUR, Mouza: Nischintapur	LR Plot No:- 10 . LR Khatian No:- 948	6.55 Sq Ft	909/-	5,504/-	Proposed Use: Bastu, ROR: Sheti, Width of Approach Road: 30 Ft.
L50	District: South 24-Parganas, P.S.- Sonarpur, Municipality: RAJPUR- SONARPUR, Mouza: Nischintapur	LR Plot No:- 9 . LR Khatian No:- 948	6.55 Sq Ft	909/-	5,504/-	Proposed Use: Bastu, ROR: Sheti, Width of Approach Road: 30 Ft.
L51	District: South 24-Parganas, P.S.- Sonarpur, Municipality: RAJPUR- SONARPUR, Mouza: Nischintapur	RS Plot No:- 16 . RS Khatian No:- 948	6.55 Sq Ft	909/-	5,504/-	Proposed Use: Bastu, ROR: Dangi Width of Approach Road: 30 Ft.
L52	District: South 24-Parganas, P.S.- Sonarpur, Municipality: RAJPUR- SONARPUR, Mouza: Nischintapur	LR Plot No:- 4 . LR Khatian No:- 948	6.55 Sq Ft	909/-	5,504/-	Proposed Use: Bastu, ROR: Dangi Width of Approach Road: 30 Ft.
L53	District: South 24-Parganas, P.S.- Sonarpur, Municipality: RAJPUR- SONARPUR, Mouza: Nischintapur	RS Plot No:- 18 . RS Khatian No:- 948	6.55 Sq Ft	909/-	5,504/-	Proposed Use: Bastu, ROR: Pukur Width of Approach Road: 30 Ft.
L54	District: South 24-Parganas, P.S.- Sonarpur, Municipality: RAJPUR- SONARPUR, Mouza: Nischintapur	RS Plot No:- 18/494 . RS Khatian No:- 948	6.55 Sq Ft	909/-	5,504/-	Proposed Use: Bastu, ROR: Dangi Width of Approach Road: 30 Ft.

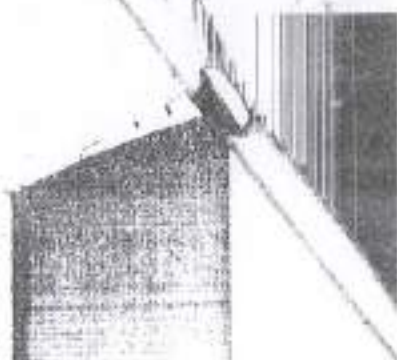

Land Details						
Sch No.	Property Location	Plot No & Khatian No/ Road Zone	Area of Land	Setforth Value(In Rs.)	Market Value(In Rs.)	Other Detail
L55	District: South 24 Parganas, P.S.- Sagarpur, Municipality: RAJPUR- SIONARPUJ, Mouza: Nishchintapur	RS Pict No:- 19 , RS Khatian No:- 948	6.55 Sq Ft	914/-	5,504/-	Proposed Use: Bastu, RCR: Shell, Width of Approach Road: 30 Ft.

Structure Details					
Sch No.	Structure Location	Area of Structure	Setforth Value(In Rs.)	Market Value(In Rs.)	Other Details
F0	Gr. Floor	100 Sq Ft	0/-		Residential Use, Cemented Floor, Age of Structure: 10 Years, Roof Type: Thatched Extent of Completion: Complete
S1	On Land L38, L39	100 Sq Ft.	10,000/-	14,625/-	Structure Type: Structure

Transfer of Property from Donor to Donee					
Sch No.	Name of the Donor	Name of the Donee	Transferred Area	Transferred Area In(%)	
L1	Devaloke Developers Limited	Mr Abdur Rauf Sarder	0.00374688	25	
	Devaloke Developers Limited	Mr Rafikul Alam Sarker	0.00374688	25	
	Devaloke Developers Limited	Mrs Hosne Ara Bibi	0.00374688	25	
L2	Devaloke Developers Limited	Mrs Jahannara Bibi	0.00374688	25	
	Devaloke Developers Limited	Mr Abdur Rauf Sarder	0.00374688	25	
	Devaloke Developers Limited	Mr Rafikul Alam Sarker	0.00374688	25	
L3	Devaloke Developers Limited	Mrs Hosnu Aya Bibi	0.00374688	25	
	Devaloke Developers Limited	Mrs Jahannara Bibi	0.00374688	25	
	Devaloke Developers Limited	Mr Abdur Rauf Sarder	0.00374688	25	
L4	Devaloke Developers Limited	Mr Rafikul Alam Sarker	0.00374688	25	
	Devaloke Developers Limited	Mr Rafikul Alam Sarker	0.00374688	25	
	Devaloke Developers Limited	Mrs Hosne Aya Bibi	0.00374688	25	
	Devaloke Developers Limited	Mrs Jahannara Bibi	0.00374688	25	

Transfer of Property from Donor to Donee

Sch No.	Name of the Donor	Name of the Donee	Transferred Area	Transferer Area in(%)
L13	Devaloke Developers Limited	Mr Abdur Rauf Sardar	0.00374688	25
	Devaloke Developers Limited	Mr Rafikul Alam Sarkar	0.00374688	25
	Devaloke Developers Limited	Mrs Hosne Ara Bibi	0.00374688	25
L14	Devaloke Developers Limited	Mrs Jahannara Bibi	0.00374688	25
	Devaloke Developers Limited	Mr Abdur Rauf Sardar	0.00374688	25
	Devaloke Developers Limited	Mr Rafikul Alam Sarkar	0.00374688	25
L15	Devaloke Developers Limited	Mrs Hosne Ara Bibi	0.00374688	25
	Devaloke Developers Limited	Mr Abdur Rauf Sardar	0.00374688	25
	Devaloke Developers Limited	Mr Rafikul Alam Sarkar	0.00374688	25
L16	Devaloke Developers Limited	Mrs Jahannara Bibi	0.00374688	25
	Devaloke Developers Limited	Mr Abdur Rauf Sardar	0.00374688	25
	Devaloke Developers Limited	Mr Rafikul Alam Sarkar	0.00374688	25
L17	Devaloke Developers Limited	Mrs Hosne Ara Bibi	0.00374688	25
	Devaloke Developers Limited	Mr Abdur Rauf Sardar	0.00374688	25
	Devaloke Developers Limited	Mr Rafikul Alam Sarkar	0.00374688	25
L18	Devaloke Developers Limited	Mrs Jahannara Bibi	0.00374688	25
	Devaloke Developers Limited	Mr Abdur Rauf Sardar	0.00374688	25
	Devaloke Developers Limited	Mr Rafikul Alam Sarkar	0.00374688	25
L19	Devaloke Developers Limited	Mrs Hosne Ara Bibi	0.00374688	25
	Devaloke Developers Limited	Mrs Jahannara Bibi	0.00374688	25
	Devaloke Developers Limited	Mr Abdur Rauf Sardar	0.00374688	25
L20	Devaloke Developers Limited	Mr Rafikul Alam Sarkar	0.00374688	25
	Devaloke Developers Limited	Mrs Hosne Ara Bibi	0.00374688	25
	Devaloke Developers Limited	Mrs Jahannara Bibi	0.00374688	25

Transfer of Property from Donor to Donee					
Sl. No.	Name of the Donor	Name of the Donee	Transferred Area	Transferred Area in(%)	
L21	Devaloke Developers Limited	Mr Abdur Rauf Sardar	0.00374688	25	
	Devaloke Developers Limited	Mr Rafikul Alam Sarkar	0.00374688	25	
	Devaloke Developers Limited	Mrs Hosne Ara Bibi	0.00374688	25	
L22	Devaloke Developers Limited	Mrs Jahannara Bibi	0.00374688	25	
	Devaloke Developers Limited	Mr Abdur Rauf Sardar	0.00374688	25	
	Devaloke Developers Limited	Mr Rafikul Alam Sarkar	0.00374688	25	
L23	Devaloke Developers Limited	Mrs Hosne Ara Bibi	0.00374688	25	
	Devaloke Developers Limited	Mr Abdur Rauf Sardar	0.00374688	25	
	Devaloke Developers Limited	Mr Rafikul Alam Sarkar	0.00374688	25	
L24	Devaloke Developers Limited	Mrs Hosne Ara Bibi	0.00374688	25	
	Devaloke Developers Limited	Mrs Jahannara Bibi	0.00374688	25	
	Devaloke Developers Limited	Mr Abdur Rauf Sardar	0.00374688	25	
L25	Devaloke Developers Limited	Mr Rafikul Alam Sarkar	0.00374688	25	
	Devaloke Developers Limited	Mrs Hosne Ara Bibi	0.00374688	25	
	Devaloke Developers Limited	Mrs Jahannara Bibi	0.00374688	25	
L26	Devaloke Developers Limited	Mr Abdur Rauf Sardar	0.00374688	25	
	Devaloke Developers Limited	Mr Rafikul Alam Sarkar	0.00374688	25	
	Devaloke Developers Limited	Mrs Hosne Ara Bibi	0.00374688	25	
L27	Devaloke Developers Limited	Mrs Jahannara Bibi	0.00374688	25	
	Devaloke Developers Limited	Mr Abdur Rauf Sardar	0.00374688	25	
	Devaloke Developers Limited	Mr Rafikul Alam Sarkar	0.00374688	25	
L28	Devaloke Developers Limited	Mrs Hosne Ara Bibi	0.00374688	25	
	Devaloke Developers Limited	Mrs Jahannara Bibi	0.00374688	25	
	Devaloke Developers Limited	Mr Abdur Rauf Sardar	0.00374688	25	
	Devaloke Developers Limited	Mr Rafikul Alam Sarkar	0.00374688	25	
	Devaloke Developers Limited	Mrs Hosne Ara Bibi	0.00374688	25	
	Devaloke Developers Limited	Mrs Jahannara Bibi	0.00374688	25	

Transfer of Property from Donor to Donee

Sl. No.	Name of the Donor	Name of the Donee	Transferred Area	Transferred Area In(%)
L29	Devaloke Developers Limited	Mr Abdur Rauf Sardar	0.00374688	25
	Devaloke Developers Limited	Mr Rafikul Alam Sarkar	0.00374688	25
	Devaloke Developers Limited	Mrs Hosna Ara Bibi	0.00374688	25
L30	Devaloke Developers Limited	Mrs Jahannara Bibi	0.00374688	25
	Devaloke Developers Limited	Mr Abdur Rauf Sardar	0.00374688	25
	Devaloke Developers Limited	Mr Rafikul Alam Sarkar	0.00374688	25
L31	Devaloke Developers Limited	Mrs Hosane Ara Bibi	0.00374688	25
	Devaloke Developers Limited	Mrs Jahannara Bibi	0.00374688	25
	Devaloke Developers Limited	Mr Abdur Rauf Sardar	0.00374688	25
L32	Devaloke Developers Limited	Mr Rafikul Alam Sarkar	0.00374688	25
	Devaloke Developers Limited	Mrs Hosane Ara Bibi	0.00374688	25
	Devaloke Developers Limited	Mrs Jahannara Bibi	0.00374688	25
L33	Devaloke Developers Limited	Mr Abdur Rauf Sardar	0.00374688	25
	Devaloke Developers Limited	Mr Rafikul Alam Sarkar	0.00374688	25
	Devaloke Developers Limited	Mrs Hosane Ara Bibi	0.00374688	25
L34	Devaloke Developers Limited	Mrs Jahannara Bibi	0.00374688	25
	Devaloke Developers Limited	Mr Abdur Rauf Sardar	0.00374688	25
	Devaloke Developers Limited	Mr Rafikul Alam Sarkar	0.00374688	25
L35	Devaloke Developers Limited	Mrs Hosane Ara Bibi	0.00374688	25
	Devaloke Developers Limited	Mrs Jahannara Bibi	0.00374688	25
	Devaloke Developers Limited	Mr Abdur Rauf Sardar	0.00374688	25
L36	Devaloke Developers Limited	Mr Rafikul Alam Sarkar	0.00374688	25
	Devaloke Developers Limited	Mrs Hosane Ara Bibi	0.00374688	25
	Devaloke Developers Limited	Mrs Jahannara Bibi	0.00374688	25

Transfer of Property from Donor to Donee

Sch No.	Name of the Donor	Name of the Donee	Transferred Area	Transferred Area in(%)
L37	Devaloke Developers Limited	Mr Abdur Rauf Sardar	0.00374688	25
	Devaloke Developers Limited	Mr Rafikul Alam Sarkar	0.00374688	25
	Devaloke Developers Limited	Mrs Hosne Ara Bibi	0.00374688	25
L38	Devaloke Developers Limited	Mrs Jahannara Bibi	0.00374688	25
	Devaloke Developers Limited	Mr Abour Rauf Sardar	0.0037612	25
	Devaloke Developers Limited	Mr Rafikul Alam Sarkar	0.0037612	25
L39	Devaloke Developers Limited	Mrs Hosne Ara Bibi	0.0037612	25
	Devaloke Developers Limited	Mr Abdur Rauf Sardar	0.0037612	25
	Devaloke Developers Limited	Mr Rafikul Alam Sarkar	0.0037612	25
L40	Devaloke Developers Limited	Mrs Hosne Ara Bibi	0.0037612	25
	Devaloke Developers Limited	Mr Abdur Rauf Sardar	0.0037612	25
	Devaloke Developers Limited	Mr Rafikul Alam Sarkar	0.0037612	25
L41	Devaloke Developers Limited	Mrs Jahannara Bibi	0.0037612	25
	Devaloke Developers Limited	Mr Abdur Rauf Sardar	0.0037612	25
	Devaloke Developers Limited	Mr Rafikul Alam Sarkar	0.0037612	25
L42	Devaloke Developers Limited	Mrs Hosne Ara Bibi	0.0037612	25
	Devaloke Developers Limited	Mrs Jahannara Bibi	0.0037612	25
	Devaloke Developers Limited	Mr Abdur Rauf Sardar	0.0037612	25
L43	Devaloke Developers Limited	Mr Rafikul Alam Sarkar	0.0037612	25
	Devaloke Developers Limited	Mrs Hosne Ara Bibi	0.0037612	25
	Devaloke Developers Limited	Mrs Jahannara Bibi	0.0037612	25
L44	Devaloke Developers Limited	Mr Abdur Rauf Sardar	0.0037612	25
	Devaloke Developers Limited	Mr Rafikul Alam Sarkar	0.0037612	25
	Devaloke Developers Limited	Mrs Hosne Ara Bibi	0.0037612	25
	Devaloke Developers Limited	Mrs Jahannara Bibi	0.0037612	25
	Devaloke Developers Limited	Mrs Hosne Ara Bibi	0.0037612	25
	Devaloke Developers Limited	Mrs Jahannara Bibi	0.0037612	25

Transfer of Property from Donor to Donee				
Sch No.	Name of the Donor	Name of the Donee	Transferred Area	Transferred Area In(%)
L45	Devaloke Developers Limited	Mr Abdur Rauf Sardar	0.003752612	25
	Devaloke Developers Limited	Mr Rafikul Alam Sarkar	0.003752612	25
	Devaloke Developers Limited	Mrs Hosne Ara Bibi	0.003752612	25
L46	Devaloke Developers Limited	Mrs Jahannara Bibi	0.003752612	25
	Devaloke Developers Limited	Mr Abdur Rauf Sardar	0.003752612	25
	Devaloke Developers Limited	Mr Rafikul Alam Sarkar	0.003752612	25
L47	Devaloke Developers Limited	Mrs Hosne Ara Bibi	0.003752612	25
	Devaloke Developers Limited	Mrs Jahannara Bibi	0.003752612	25
	Devaloke Developers Limited	Mr Abdur Rauf Sardar	0.003752612	25
L48	Devaloke Developers Limited	Mr Rafikul Alam Sarkar	0.003752612	25
	Devaloke Developers Limited	Mrs Hosne Ara Bibi	0.003752612	25
	Devaloke Developers Limited	Mrs Jahannara Bibi	0.003752612	25
L49	Devaloke Developers Limited	Mr Abdur Rauf Sardar	0.003752612	25
	Devaloke Developers Limited	Mr Rafikul Alam Sarkar	0.003752612	25
	Devaloke Developers Limited	Mrs Hosne Ara Bibi	0.003752612	25
L50	Devaloke Developers Limited	Mrs Jahannara Bibi	0.003752612	25
	Devaloke Developers Limited	Mr Abdur Rauf Sardar	0.003752612	25
	Devaloke Developers Limited	Mr Rafikul Alam Sarkar	0.003752612	25
L51	Devaloke Developers Limited	Mrs Hosne Ara Bibi	0.003752612	25
	Devaloke Developers Limited	Mrs Jahannara Bibi	0.003752612	25
	Devaloke Developers Limited	Mr Abdur Rauf Sardar	0.003752612	25
L52	Devaloke Developers Limited	Mr Rafikul Alam Sarkar	0.003752612	25
	Devaloke Developers Limited	Mrs Hosne Ara Bibi	0.003752612	25
	Devaloke Developers Limited	Mrs Jahannara Bibi	0.003752612	25

Transfer of Property from Donor to Donee				
Sch No.	Name of the Donor	Name of the Donee	Transferred Area	Transfer Area in %
L53	Devaloke Developers Limited	Mr Abdur Rauf Sardar	0.00375261	25
	Devaloke Developers Limited	Mr Rafikul Alam Sarkar	0.00375261	25
	Devaloke Developers Limited	Mrs Hosne Ara Bibi	0.00375261	25
L54	Devaloke Developers Limited	Mrs Jahannara Bibi	0.00375261	25
	Devaloke Developers Limited	Mr Abdur Rauf Sardar	0.00375261	25
	Devaloke Developers Limited	Mr Rafikul Alam Sarkar	0.00375261	25
L55	Devaloke Developers Limited	Mrs Hosne Ara Bibi	0.00375261	25
	Devaloke Developers Limited	Mr Rafikul Alam Sarkar	0.00375261	25
	Devaloke Developers Limited	Mrs Hosne Ara Bibi	0.00375261	25
	Devaloke Developers Limited	Mrs Jahannara Bibi	0.00375261	25

D. Applicant Details

Transfer of Property from Donor to Donee	
Sch No.	Name of the Donor
S1	Devaloke Developers Limited
	Devaloke Developers Limited
	Devaloke Developers Limited
	Devaloke Developers Limited

Details of the applicant who has submitted the requisition form	
Applicant's Name	Terun Kanti Chakrabarti
Address	Baruipur Civil Court, Thane : Baruipur, District : South 24 Parganas, WEST BENGAL, PIN - 700144
Applicant's Status	Advocate

Office of the A.D.S.R. SONARPUR, District: South 24-Parganas
Endorsement For Deed Number : I - 160805903 / 2015

Query No/Year	16080000817983/2015	Serial no/Year	1608007033 / 2015
Deed No/Year	I - 160805903 / 2015		
Transaction	[2014] Gift, Gift in f/o others except family members, Government, Local Body		
Name of Presentant	Mr Sukanta Kundu	Presented At	Office
Date of Execution	14-10-2015	Date of Presentation	14-10-2015
Remarks			

On 14/10/2015
Presentation(Under Section 52 & Rule 22A(3) 46(1),W.B. Registration Rules,1962)
Presented for registration at 15:24 hrs on : 14/10/2015, at the Office of the A.D.S.R. SONARPUR by Mr Sukanta Kundu ..

Certificate of Market Value(WB PUVI rules of 2001)
Certified that the market value of this property which is the subject matter of the deed has been assessed at Rs 3,26,197/- Other amount Rs 3,26,197/-

Admission of Execution (Under Section 58, W.B. Registration Rules, 1962) [Representative]
Execution is admitted on 14/10/2015 by

Mr Sukanta Kundu , Devaloke Developers Limited, 47 Garla Main Road, P.O.- Garla, P.S.- Sonarpur, Rajpur-sonarpur, District-South 24-Parganas, West Bengal, India, PIN - 700084
Identified by Mr Ashish Bagchi, Son of Late Joydeb Bagchi, 47 Garla Main Road, P.O: Garla, Thana: Sonarpur, City/Town: RAJPUR-SONARPUR, South 24-Parganas, WEST BENGAL, India, PIN - 700084, By caste Hindu, By Profession Service

Executed by Attorney
Execution by

1. Mr Sukanta Kundu, 16 Nazrul Pally, Mahemayatela,, P.O: Garla, Thana: Sonarpur , City/Town: RAJPUR-SONARPUR, South 24-Parganas, WEST BENGAL, India, PIN - 700084 as the constituted attorney of
1. Mr Abdur Rauf Sarder/Alis , Mr Abdur Rauf Sarder, Jagannathpur, P.O: RKPally, Thana: Sonarpur , City/Town: RAJPUR-SONARPUR, South 24-Parganas, WEST BENGAL, India, PIN - 700150
2. Mrs Jahannara Bibi, Polehat, P.O: Jagaddal, Thana: Sonarpur , City/Town: RAJPUR-SONARPUR, South 24-Parganas, WEST BENGAL, India, PIN - 700151
3. Mr Rafikul Alam Sarker, Jagannathpur, P.O: RKPally, Thana: Sonarpur , City/Town: RAJPUR-SONARPUR, South 24-Parganas, WEST BENGAL, India, PIN - 700150
4. Mrs Hosne Ara Bibi/Alis , Mrs Hosnara Bibi, B-8 Brahmepur Place, P.O: Brahmepur Badamtala, Thana: Barachori , South 24-Parganas, WEST BENGAL, India, PIN - 700094
Identified by Mr Ashish Bagchi, Son of Late Joydeb Bagchi, 47 Garla Main Road, P.O: Garla, Thana: Sonarpur, City/Town: RAJPUR-SONARPUR, South 24-Parganas, WEST BENGAL, India, PIN - 700084, By caste Hindu, By Profession Service
is admitted by him

Certified that required Registration Fees payable for this document is Rs 3,504/- (A(1) = Rs 3,506/-, E = Rs 1, M(b) = Rs 4/-) and Registration Fees paid by Cash Rs 0/-, by Draft Rs 3,620/-.

Description of Draft
1. Rs 3,620/- is paid, by the Draft(8554) No: 003195000384, Date: 09/10/2015, Bank: STATE BANK OF INDIA (SBI), MAHAMAYATALA

Payment of Stamp Duty
Certified that required Stamp Duty payable for this document is Rs. 19,592/- and Stamp Duty paid by Draft Rs 14,600/-, by Stamp Rs 5,000/-.

Description of Stamp
1. Rs 10/- is paid on Court Fees.
2. Rs 5,000/- is paid on Impressed type of Stamp, Serial no 770, Purchased on 13/10/2015, Vendor named Sankar Kr Sankar.

Description of Draft
1. Rs 14,600/- is paid, by the Draft(8554) No: 003194000384, Date: 09/10/2015, Bank: STATE BANK OF INDIA (SBI), MAHAMAYATALA.

(Presentia Mukhopadhyay)
ADDITIONAL DISTRICT SUB-REGISTRAR
OFFICE OF THE A.D.S.R. SONARPUR
South 24-Parganas, West Bengal

On 30/10/2015
Certificate of Admissibility(Rule 43,W.B. Registration Rules 1962)
Admissible under rule 21 of West Bengal Registration Rule, 1962 duly stamped under schedule 1A, Article number : 33(j) of Indian Stamp Act 1989.

(Presentia Mukhopadhyay)
ADDITIONAL DISTRICT SUB-REGISTRAR
OFFICE OF THE A.D.S.R. SONARPUR
South 24-Parganas, West Bengal

Certificate of Registration under section 60 and Rule 69.

Registered in Book - I

Volume number 1608-2015, Page from 61500 to 61554

being No 160805903 for the year 2015.



Digitally signed by PRASANTA
MUKHOPADHYAY
Date: 2015.10.30 15:10:03 +05:30
Reason: Digital Signing of Deed.

(Prasanta Mukhopadhyay) 30/10/2015 15:10:01
ADDITIONAL DISTRICT SUB-REGISTRAR
OFFICE OF THE A.D.S.R. SONARPUR
West Bengal.

(This document is digitally signed.)

30/10/2015 Query No--16080000817963 / 2015 Deed No J - 160805903 / 2015, Document is digitally signed.

Dana RR of RR