

GROUND FLOOR PLAN

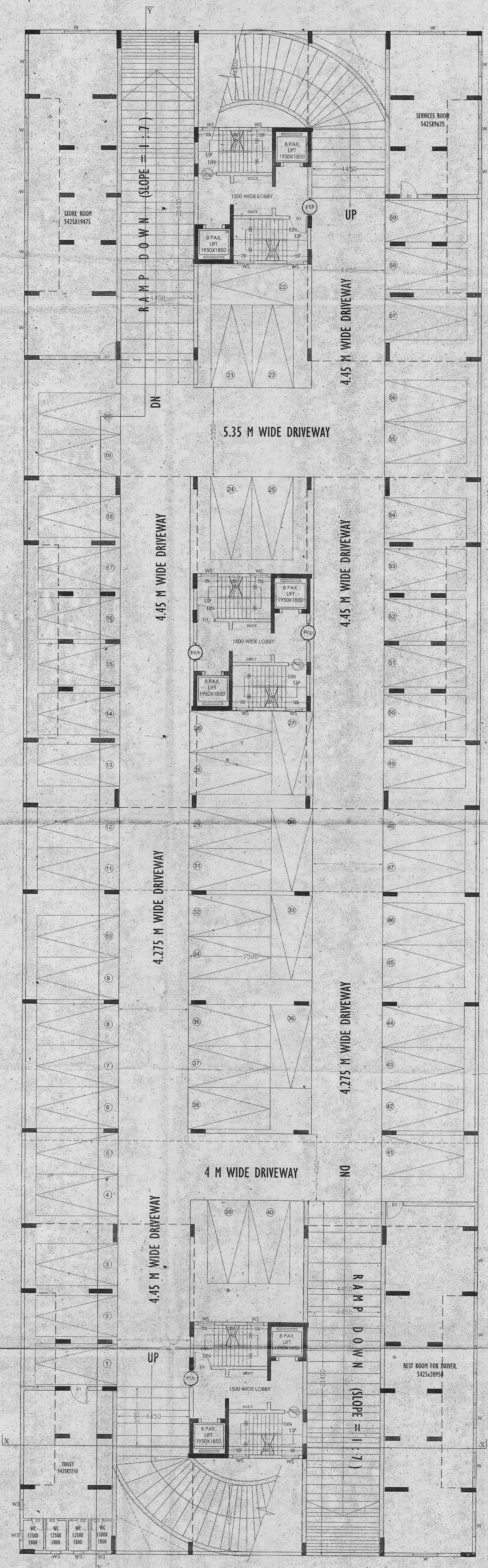

1ST FLOOR PLAN

- SPECIFICATIONS:-**
1. ALL DIMENSIONS ARE IN MILLIMETERS UNLESS OTHERWISE STATED.
  2. ALL EXTERNAL WALLS ARE 250/200 mm & ALL INTERNAL WALLS ARE 125 mm & 75 mm.
  3. THE DEPTH OF U.G.W.A. & SEPTIC TANK SHALL NEVER EXCEED THE DEPTH OF FOUNDATION.
  4. BRICK WORK 250/200 mm WITH MORTAR 1:6 & BRICK WORK 125 mm & 75 mm WITH MORTAR 1:4.
  5. ALL CONCRETE OF R.C.C. WORKS AS SPECIFIED BY STRUCTURAL ENGINEER.
  6. GRADE OF STEEL AS SPECIFIED BY THE STRUCTURAL ENGINEER.
  7. ALL KINDS OF PRECAUTIONARY MEASURES WILL BE TAKEN AT THE TIME OF CONSTRUCTION.
  8. OTHER ITEMS ARE AS PER I.S. SPECIFICATION.
  9. THIS DRAWING SHALL BE READ IN CONJUNCTION WITH ALL OTHER RELEVANT DRAWINGS.

**DOORS AND WINDOW SCHEDULE:**

S/NO	LEGEND	SIZE	SPECIFICATION
01	D1	3100 X 2100	PANNELED DOOR
02	W2	300 X 2100	FLUSH DOOR
03	D3	750 X 2100	FLUSH DOOR
04	DB	2400 X 2400	FLUSH DOOR
05	W3	1100 X 2100	AS PER N.B.C.
06	W	1500 X 1200	FULL GLAZED WINDOW
07	W1	800 X 1200	DO
08	W2	800 X 900	DO
09	W3	800 X 900	DO
10	WS	1000 X 1200	DO

**ALOK ROY**  
 Registered Professional Engineer  
 Rajpur-Sonarpur Municipality  
 No. 608 / G.T. Eng. Class-1

SIGN. OF GEO-TECHNICAL ENGINEER

I HAVE REVIEWED / CHECKED THE STRUCTURAL DRAWING AND DESIGN DETAILS OF THIS PROJECT WHICH HAS BEEN DONE COMPLYING RELEVANT IS. CODE INCLUDING SEISMIC AND THE NATIONAL BUILDING CODE. I CERTIFY THAT THE STRUCTURE WILL BE SAFE & STABLE AGAINST ALL VERTICAL AND LATERAL LOADS AND WILL BE FIT FOR HABITABLE USE.

**SIGN. OF STRUCTURAL REVIEWER**

THE STRUCTURAL DESIGN & DRAWING OF BOTH FOUNDATION & SUPER-STRUCTURE OF THE BUILDING HAS BEEN MADE BY ME CONSIDERING ALL POSSIBLE LOADS INCLUDING THE SEISMIC LOAD AS PER THE NATIONAL BUILDING CODE OF INDIA & CERTIFIED THAT IT IS SAFE & STABLE IN ALL RESPECT.

**SIGN. OF STRUCTURAL ENGINEER**

**OWNER : DEVALOKE DEVELOPERS LTD.**

For DEVALOKE DEVELOPERS LTD.  
 Director

**SIGN. OF OWNER**

**SIGN. OF ARCHITECT**

**PROJECT NAME:**

PROPOSED ALTERATION & ADDITION OF ONE FLOOR OVER G+11 STORED RESIDENTIAL BUILDING TOWERS (EXCEPT TOWER 1 & 2) AT HOLDING NO. 1117 L.R. DAG NO. 477, 479, 482, 488, 493, 496, 491, 492, 494, 495, 487, 488, 480, 489, 461, 450, 460, 494, 501, 497, 498, 505, 499, 482, 483, 484, 485, 483, 459, 480, 454, 476, 475, 481, 473, 500, 431, 434, 446, 445, 435, 436, 447, 1-10 L.R. KSHATIYAN NO.-1257, 895, 1365, 1340, 1005, 345, 671, 659, 2480, 948.

MOUZA - JAGANNATHPUR, NISCHINTAPUR, TEHARJI, J.L. NO. - 51, 53, 52, P.S. - SONARPUR, UNDER RAJPUR - SONARPUR MUNICIPALITY, WARD NO. - 8, DIST. - 24 PARGANAS (S), KOLKATA-700150

BUILDING SANCTION NO. -120/CB/02/48 DATED - 24/04/2015, 194/REV/CB/02/16 DATED - 20/01/2017

**Subir Kumar Basu**  
 CONSULTING ARCHITECTS & ENGINEERS  
 4, BROAD STREET  
 KOLKATA-700019

**SHEET TITLE :** TYPE - 6 (G+12)  
 TOWER - 20.21 & 22  
 GROUND & 1ST FLOOR PLAN (MLCP)

DEALT BY:	SCALE:	SHEET NO.:	DRAWING NO.:	DATE:	SHEET NO.:
SRINIVAS	1:100	A0	SC/PA/2018	05.03.2018	9 OF 12

Checked by  
 Sub-Assistant Engineer  
 Local Office Engineer-in-Charge  
 RAJPUR-SONARPUR MUNICIPALITY

**APPROVED**  
 18/04/2018/2018/50 Dated: 24/11/2018  
 24/11/2018

Malay Kumar Pal  
 Assistant Engineer in Charge, P.W.D.

Dr. Palab Das  
 Chairman  
 RAJPUR-SONARPUR MUNICIPALITY