

R.S. DAG NO-65

BUILDING

HUTMENT

R.S. DAG NO-67

R.S. DAG NO-69

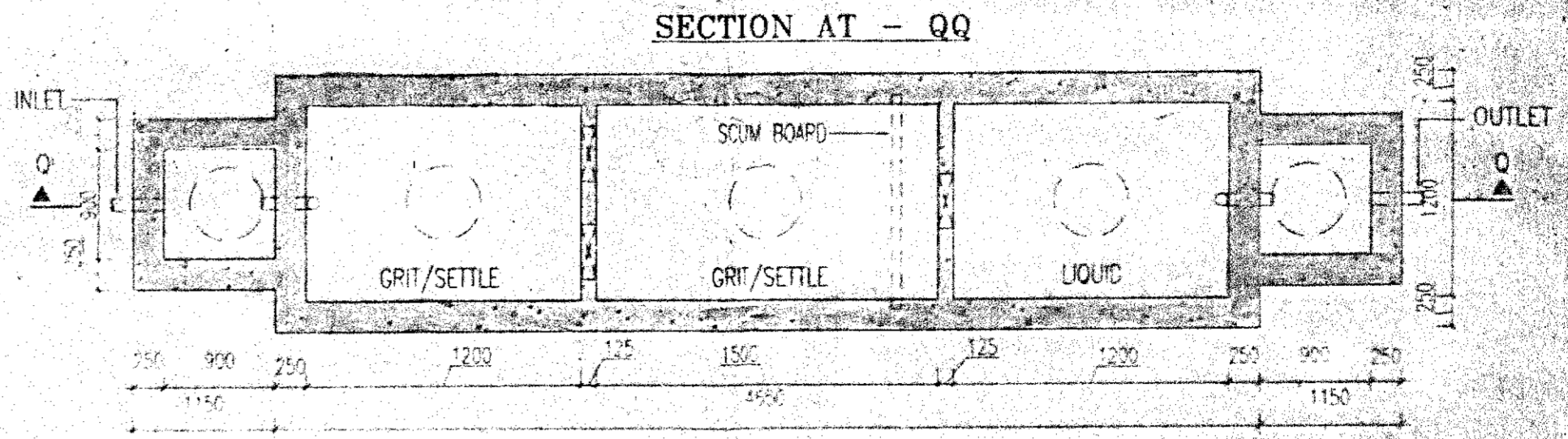
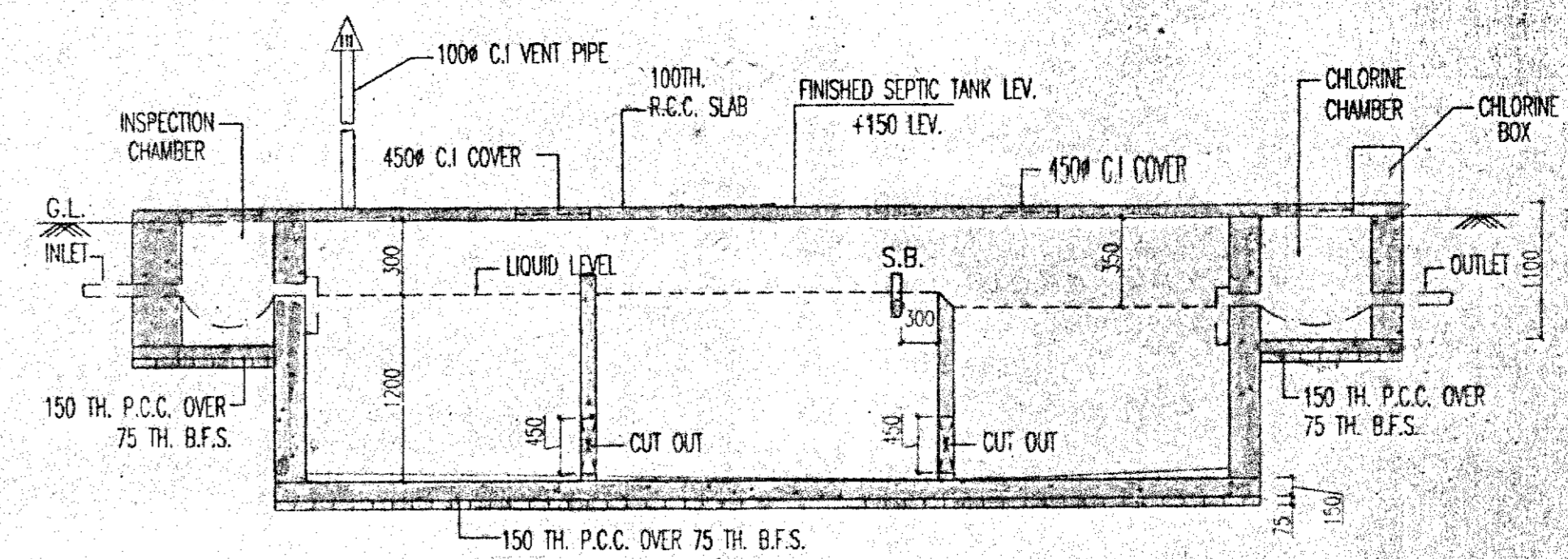

PLAN
DETAIL OF SEPTIC TANK (250 USERS)
SCALE: 1:50

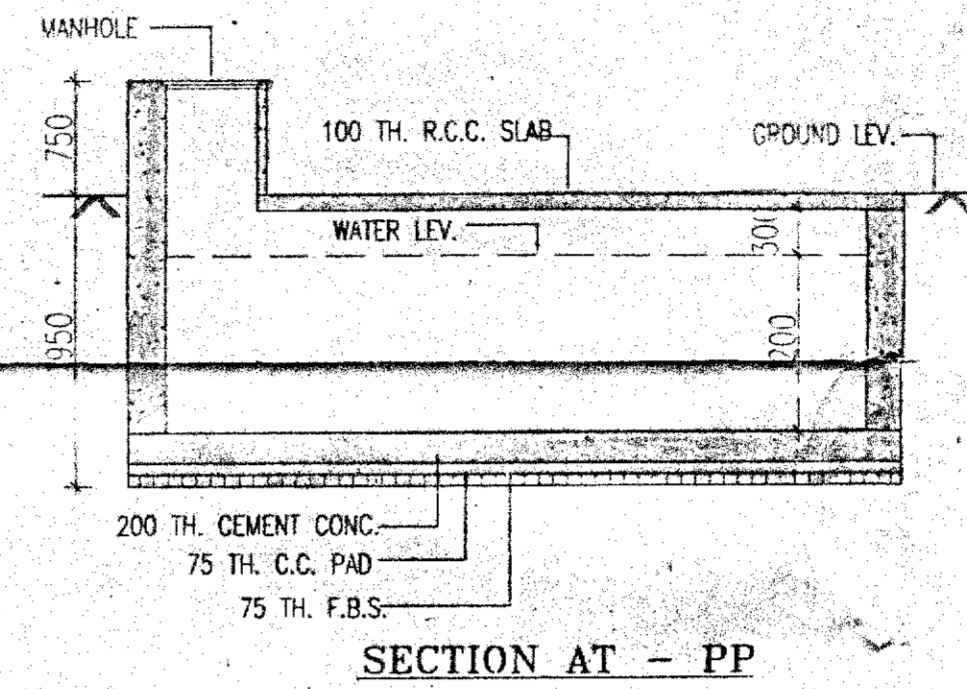

PLAN
DETAIL OF UNDERGROUND WATER TANK
CAPACITY - 1800 GALLONS
SCALE: 1:50

SCHEDULE OF DOORS & WINDOWS					
Sl. No.	Particulars	Qty	Remarks	Sl. No.	Particulars
01	2100 x 1000	10	WOODEN DOOR	06	2100 x 1000
02	2100 x 1000	10	WOODEN DOOR	07	2100 x 1000
03	2100 x 1000	10	WOODEN DOOR	08	2100 x 1000
04	2100 x 1000	10	WOODEN DOOR	09	2100 x 1000
05	2100 x 1000	10	WOODEN DOOR	10	2100 x 1000

- SPECIFICATION OF BUILDING**
- ALL DIMENSIONS ARE IN MM.
 - 1ST CLASS CEMENT BRICK WORK IN SUPER STRUCTURE.
 - 200MM TH. 1ST CLASS BRICK WITH 14MM H.B. WIRE NETTING.
 - LEAN CONC. 1:1.5 WITH 14MM DOWN CROSSED STIRRUPS.
 - R.C.C. WORK FOR ROOF, SLAB, LIFT, BEAM, COLUMN, WALL.
 - CEMENT SAND PLASTER IS MM. TH. ON OUTSIDE & INSIDE WALLS ON 12MM H.B. WIRE IN CEILING & R.C.C. CHALU.
 - 10MM TH. L.F.S. FLOORING WITH BEST GRUNT AT TOP INCL. SYPHIC.
 - A BRICK FLAT SOLING IN FLOORING & FOUNDATION.
 - MILD STEEL 1 BARS FOR COLUMNS, BEAMS, LIFTS & SLABS INCLUDING DISTRIBUTORS & BRICKS.
 - WIRE & LABOUR FOR SHUTTERING OF R.C.C. WORKS INCLUDING STAIR PROPS TO BE PLACED AS PER DIRECTION.
 - SHUTTER & PLUMBING, FITTING & FINISH COMPLETE AS PER SPECIFICATION.
 - ALL GROUND WALLS TO BE MM. TH. & ROOF WALLS TO BE 75MM TH. WIRE AS STATED WITH H.B. WIRE NETTING IN EVERY 3RD LAYER.

SIGNATURE OF OWNER

SIGNATURE OF OWNER

CERTIFICATE OF L.B.A./L.B.S.

THE L.B.A. HAS CERTIFIED ON THE PLAN ITSELF WITH FULL RESPONSIBILITY THAT THE BUILDING PLAN HAS BEEN DRAWN UP AS PER PROVISION OF WEST BENGAL MUNICIPAL BLDG. RULES 2007, AND AMENDMENT 2016 AND THAT THE SITE CONDITION INCLUDING THE WIDTH OF THE ROUTING ROAD CONFORM WITH THE PLAN AND IT IS A BUILDABLE SITE AND NOT A TANK OR A FILLED UP TANK.

SIGNATURE OF L.B.A./L.B.S.

CERTIFICATE OF STRUCTURAL ENGINEER

CERTIFIED THAT THE STRUCTURAL DESIGN & DRAWINGS OF BOTH FOUNDATION & SUPER STRUCTURE OF THE BUILDING HAS BEEN MADE BY ME CONSIDERING ALL POSSIBLE LOADS INCLUDING THE SEISMIC LOAD AS PER THE NATIONAL BUILDING CODE OF INDIA & CORRECT. THAT IT IS SAFE & STABLE IN ALL RESPECTS.

SIGNATURE OF STRUCTURAL ENGINEER

TITLE

GROUND FLOOR PLAN, SITE PLAN, LOCATION PLAN, DETAIL OF SEPTIC TANK & DETAIL OF UNDERGROUND WATER RESERVOIR.

PROJECT

PROPOSED 4-11 STORED IT'S 11-11-11 RESIDENTIAL BUILDING AT J.I. NO. - 29, DAG NOS. - 223, 224 KHATIAN NOS. - 6847, 6843, 6844, MOUZA - PASCHIM CHAPUR, UNDER BARASAT MUNICIPALITY, DIST - NORTH 24 PARGANAS.

DATE

24.08.17

ARCH/6/3/2017

SMRIT

02 OF 07

SCALE: 1:3000

ARCHITECT

RAJ AGARWAL & ASSOCIATES

69, ROYD STREET, VOLUKATA-18

APPROVED BY:-

SIGNATURE OF ARCHITECT

SIGNATURE OF OWNER

FOR OFFICE USE ONLY

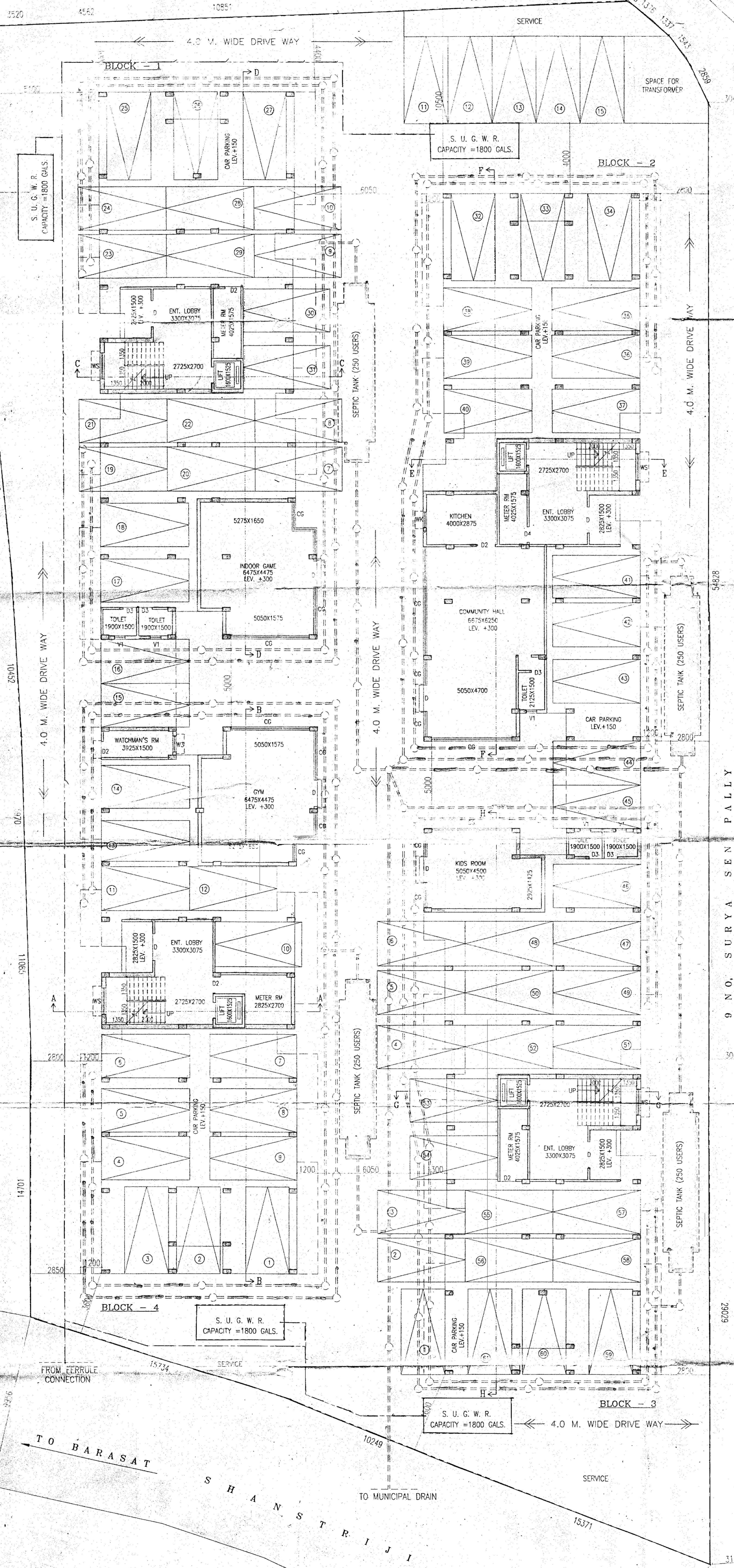

GROUND FLOOR PLAN
SCALE: 1:100

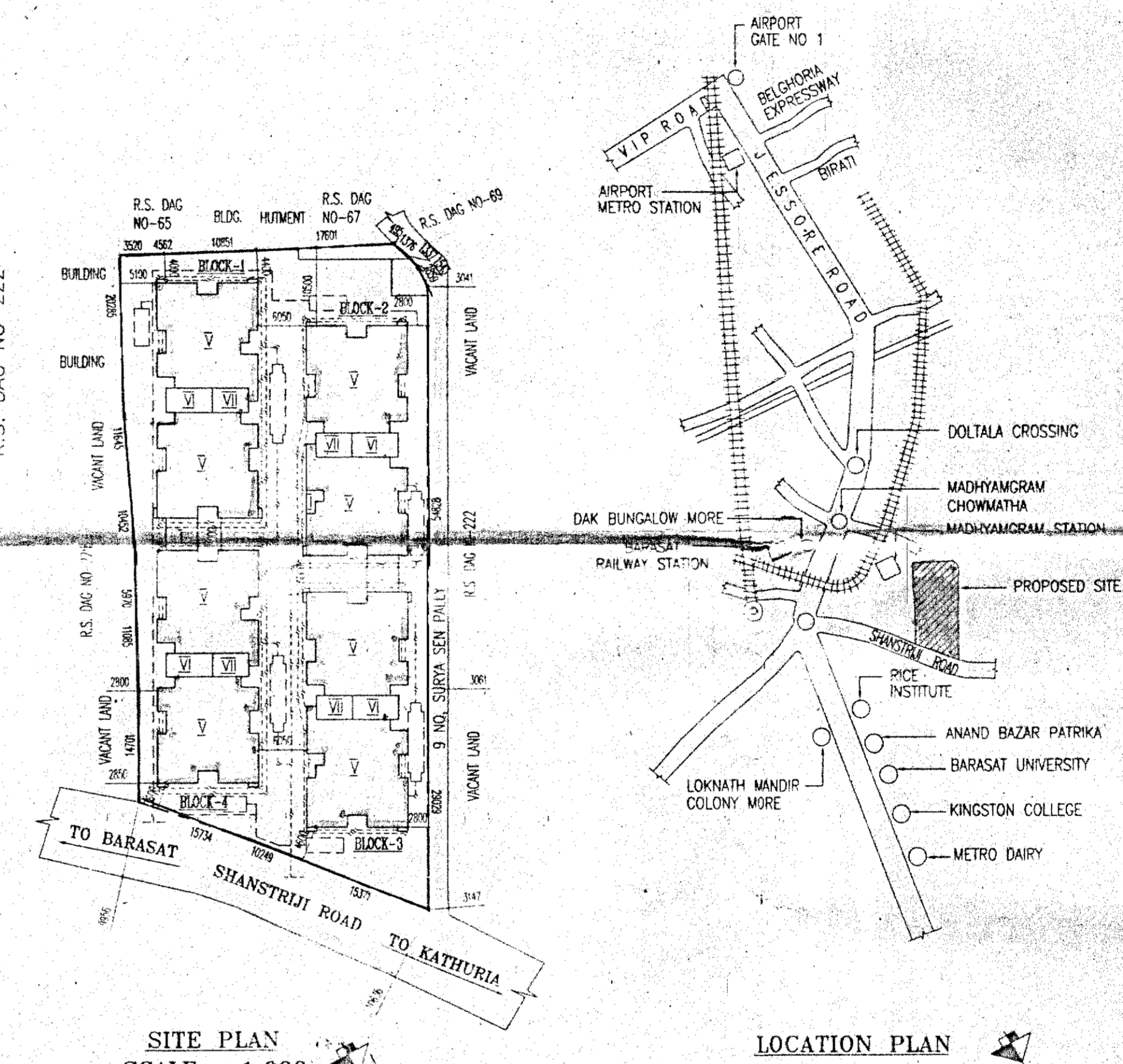

SITE PLAN
SCALE: 1:600

LOCATION PLAN
SCALE: 1:4000

AREA CALCULATION

PROPOSED BUILDING HEIGHT (0.450+2.900x5 FLS.)	=14.950 MTR.
LAND AREA (AS PER DEED) (86 DEC.)	=3480.26 SQM.
AVAILABLE ROAD WIDTH	=9.956 M.
PERMISSIBLE FAR	=2.25
PERMISSIBLE BUILT UP AREA (3480.26x2.25)	=7830.585 SQM.
PERMISSIBLE GROUND COVERAGE (50%)	=1740.13 SQM.
PROPOSED GROUND COVERAGE (45.6%)	=1587.125 SQM.
PROPOSED FLOOR AREA	=1381.65 SQM.
PROPOSED TYPICAL FLOOR AREA (1ST-4TH)	=1526.04 SQM.
PROPOSED TOTAL FLOOR AREA (1381.65+1526.04x4 FLS.)	=7485.81 SQM.
PROPOSED WAREHOUSE AREA	=44.8 SQM.
EXEMPTION	752.0169
TOTAL STAIR AREA (12.69x4 BLK x5 FLS.)	=253.80 SQM.
TOTAL LEFT LOBBY AREA (6.04x4 BLK x5 FLS.)	=120.80 SQM.
CAR PARKING AREA	=843.78 SQM.
TOTAL EXEMPTION AREA (253.80+120.80+943.78)	=1318.38 SQM.
PROPOSED TOTAL BUILT-UP AREA FOR F.A.R. (7485.81-1317.58)	=6168.23 SQM.
PROPOSED F.A.R. (8x68.23/3480.26)	=1.772
NO. OF FLAT CALCULATION	
1 BED ROOM FLAT (3x4BLK x4 FLS.)	=48 NOS.
2 BED ROOM FLAT (5x4BLK x4 FLS.)	=80 NOS.
NO. OF USERS	
128 NOS. FLAT X 4 PERSON	=512 NOS.
CAR PARKING CALCULATION	
RESIDENTIAL	
FLAT AREA BELOW 50 SQM.	=48 NOS.
REQUIRED NOS. OF CAR	=08 NOS.
FLAT AREA 50 SQM. TO 75 SQM.	=80 NOS.
REQUIRED NOS. OF CAR	=20 NOS.
TOTAL NOS OF CAR REQUIRED (08+20)	=28 NOS.
TOTAL NOS OF CAR PROVIDED	=76 NOS. (COVERED=61, OPEN=15)

Sanction Serial No. 1152

Building Plan Sanctioned Meeting Date: 28/10/17

Sanctioned / Approved Chairman Barasat Municipality

CHECKED & VERIFIED Assistant Engineer Barasat Municipality

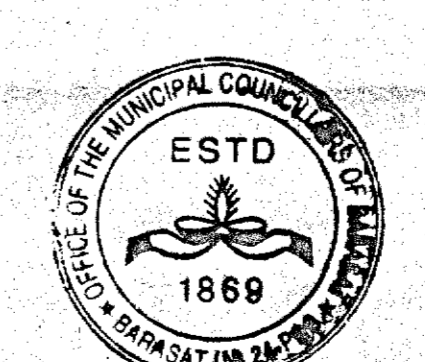

TYPICAL AREA CHART OF EACH FLOOR

BLOCK NO.	FLAT NO.	FLAT TYPE	BUILT-UP AREA (SQM.)
1 & 4	A	2 BHK	48.41
	B	2 BHK	48.41
	C	2 BHK	45.66
	D	1 BHK	32.67
	E	2 BHK	48.41
2 & 3	F	2 BHK	48.41
	G	1 BHK	32.67
	H	1 BHK	32.67
	A	2 BHK	48.41
	B	2 BHK	48.41
	C	1 BHK	32.67
	D	1 BHK	32.67
	E	2 BHK	48.41
F	2 BHK	48.41	
G	2 BHK	45.66	
H	1 BHK	32.67	