

### SCHEDULE OF BEAMS

BEAM MKD.	SIZE		REINFORCEMENT						'X' DIST.	STIRRUPS	FACE BAR
	WIDTH	DEPTH	END SUPPORT		SPAN		CONT. SUPPT.				
			TOP	BOT.	TOP	BOT.	TOP	BOT.			
B1	250	450	3-16 + 2-12	2-16	2-16	3-16	3-16 + 2-12	2-16	900	2L- 8 @ 150 C/C (S1) 2L- 8 @ 200 C/C (S2)	
B2	250	450	3-16	2-16	2-16	3-16	—	—	800	2L- 8 @ 150 C/C (S1) 2L- 8 @ 200 C/C (S2)	
B3	250	400	3-16	3-16	3-16	3-16	—	—	700	2L- 8 @ 150 C/C (S1) 2L- 8 @ 200 C/C (S2)	
B4	250	400	2-16	2-16	2-16	2-16	4-16	2-16	800	2L- 8 @ 150 C/C (S1) 2L- 8 @ 200 C/C (S2)	
B5	250	450	4-16	3-12 + 2-12	4-16	3-12 + 2-12	4-16	3-12 + 2-12	—	2L- 8 @ 150 C/C (S1) 2L- 8 @ 150 C/C (S2)	
B6	250	400	3-16	3-16	3-16	3-16	3-16	3-16	—	2L- 8 @ 150 C/C (S1) 2L- 8 @ 150 C/C (S2)	
B7	250	400	4-16	2-16	2-16	4-16	—	—	700	2L- 8 @ 150 C/C (S1) 2L- 8 @ 200 C/C (S2)	
B8	250	300	2-12	2-12	2-12	2-12	—	—	—	2L- 8 @ 150 C/C (S1) 2L- 8 @ 150 C/C (S2)	
LB1	250	300	2-16 + 2-12	2-16	2-16	2-16 + 2-12	—	—	800	2L- 8 @ 125 C/C (S1) 2L- 8 @ 150 C/C (S2)	

### SCHEDULE OF SLAB

PANEL MKD.	SLAB THK.	REINFORCEMENT						REMARKS
		ALONG SHORTER DIRECTION			ALONG LONGER DIRECTION			
		END SUPPORT (TOP)	SPAN BOTTOM	CONTINUOUS SUPPT. (TOP)	END SUPPORT (TOP)	SPAN BOTTOM	CONTINUOUS SUPPT. (TOP)	
S1	110	8 @ 175 C/C	8 @ 175 C/C	8 @ 175 C/C	8 @ 175 C/C	8 @ 175 C/C	8 @ 175 C/C	
S2	110	8 @ 200 C/C	8 @ 200 C/C	8 @ 200 C/C	8 @ 200 C/C	8 @ 200 C/C	8 @ 200 C/C	
S3	110	8 @ 150 C/C	8 @ 200 C/C	8 @ 150 C/C	8 @ 150 C/C	8 @ 200 C/C	8 @ 150 C/C	CANTILEVER SLAB

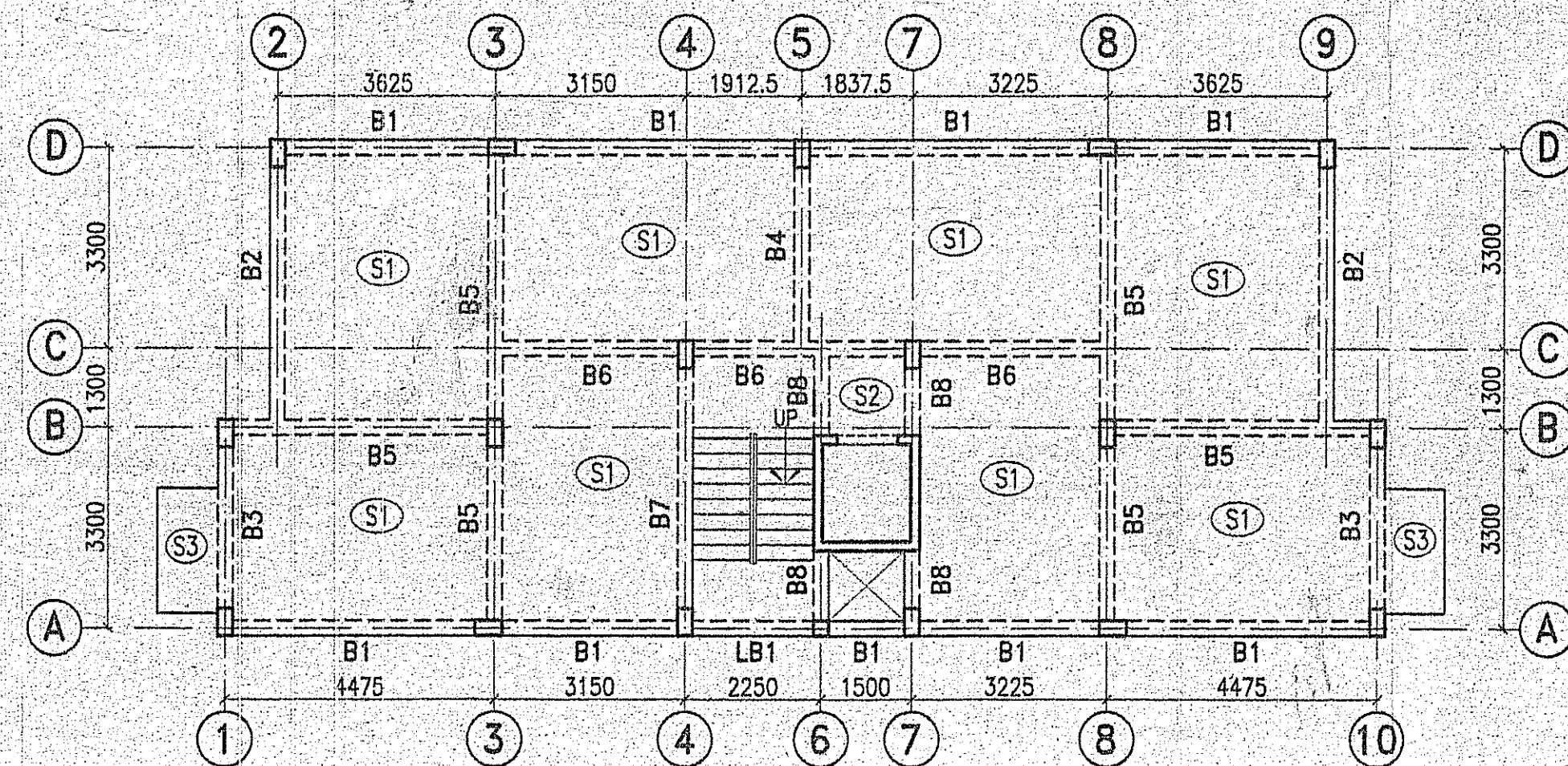

TYPICAL FLOOR PLAN

### CERTIFICATE OF ARCHITECT :

CERTIFIED THAT THE PLAN HAS BEEN DRAWN UP AS PER PROVISION OF LOCAL PANCHAYET BUILDING RULES & REGULATIONS AND THAT THE SITE CONDITION INCLUDING THE WIDTH OF THE ABUTTING ROAD CONFIRM WITH THE PLAN AND THAT IT IS A BUILDABLE SITE AND NOT A FILLED UP TANK.

*Kalyan Kumar Basu*  
KALYAN KUMAR BASU  
Registered Architect of Council  
of Architecture  
CA/84/12

SIGN. OF ARCHITECT/L.B.S

### CERTIFICATE OF STRUCTURAL ENGINEER :

CERTIFIED THAT THE DESIGN AND DRAWINGS OF BOTH FOUNDATION AND SUPER STRUCTURE OF THE BUILDING HAS BEEN MADE BY ME CONSIDERING ALL POSSIBLE LOADS INCLUDING THE SEISMIC LOAD AS PER THE LATEST NATIONAL BUILDING CODE OF INDIA AND CERTIFIED THAT IT IS SAFE AND STABLE IN ALL RESPECT.

*Arindam Mukherjee*  
ARINDAM MUKHERJEE  
ESE-II/68  
Kolkata Municipal Corporation  
SIGN. OF ENGINEER

Revalidated upto 31-12-2023  
Approved

*Sudip Pradhan*  
Sudip Pradhan  
Pradhan  
Sihar Gram Panchayat

For The Peerless General Finance & Investment Co. Ltd.  
*Pratik Kumar Ray*  
Pratik Kumar Ray  
Vice-President (Compliances & Legal)

SIGN. OF OWNER

PROJECT :  
PROPOSED G+IV STORIED HOUSING COMPLEX AT  
DAG NO.- 536, 641 & 642, OF MOUZA - HALDI,  
J.L. NO. 165, P.S. - KOTOLPUR, JAIRAMBATI,  
DIST. - BANKURA.

TITLE :  
TYPICAL FLOOR PPLAN, SCHEDULE OF BEAM&SLAB  
(FOR BLDG.NO. 1,10)

TYPE OF DRAWING : PANCHAYET DRAWING

CLIENT : PEERLESS GENERAL FINANCE & INVESTMENT CO. LTD.

DRAWN : S. GHOSH. CHECKED : SCALE : 1:100, 1:25, 1:20  
APPVD : JOB NO. : K1109 DATE : 07.12.2012

 MUKHERJEE & ALLIANCES ENGINEERS PVT. LTD.  
JABAKUSUM HOUSE, 34, CHITTARANJAN AVENUE  
KOLKATA - 700 012

DRAWING NO. K1109/002/PN-ST-02 REV. 0