

PROPOSED B+G+XI (BLOCK 1) & G+XI (BLOCK 2)
 STORIED HOUSING COMPLEX AT, 328 HO-CHI-MINH SARANI.
 KOLKATA- 700061. BOROUGH NO.- XIV; WARD NO.- 127.

LATITUDE 22 29 05.2 N
 LONGITUDE 88 17 40.2 E

TOTAL LAND AREA = 4490 SQM.

NET AVAILABLE AND
 USABLE AREA
 PHYSICALLY = 4214 SQM.

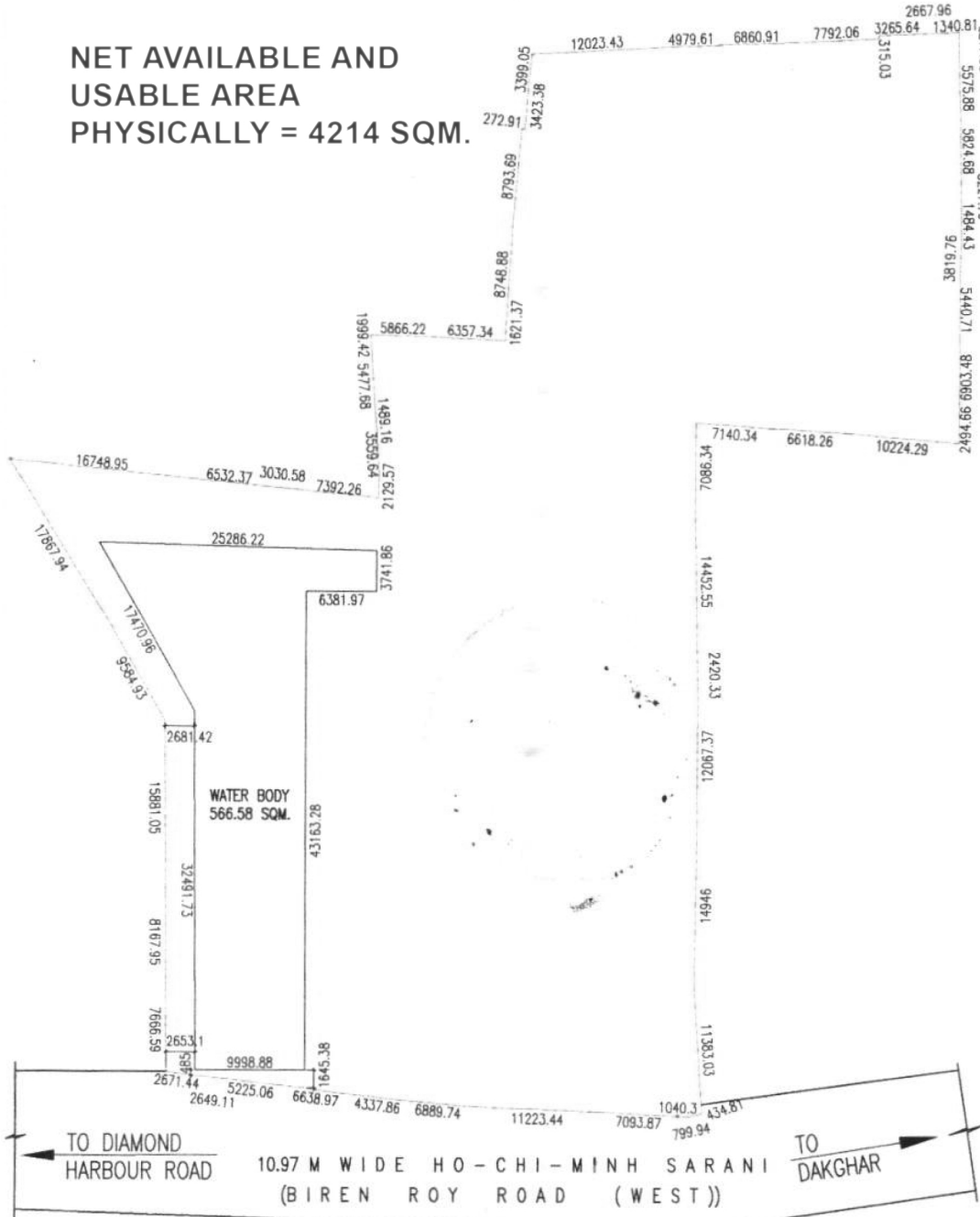

SIGNATURE OF ARCHITECT.
 SANJAY MONDAL
 C.O.A. REG. NO. CA/98/23621

SITE PLAN
 SCALE 1:600



BOUNDARY LINE BOUNDED BY RED COLOUR



Chandrakant P. Shah
 Constituted Attorney of
 Chandrakant P. Shah, Arvind P. Shah
 Ashwin P. Shah, Mahendra P. Shah,
 Indira H. Jasani, Damyanti V. Hemani,
 Kusum P. Matalia, Anita A. Mehta

SIGNATURE OF OWNER