



APPROVED

PLAN No. CB/403/19
RB/CB/18/20/100
APN 20 21
Date 30.06.2020

Commissioner
Durgapur Municipal Corporation

Mohali Lal Majee, 16/10/2020
Planner in-Charge, Building Plan,
Durgapur Municipal Corporation

Structural Safety should be
Covered by the Party.

BUILDING PLAN APPROVED
ON THE BASIS OF THE INDEMNITY
BOND, LAND MUTATION
& CONVERSION IS THE RESPONSIBILITY
OF THE OWNER.

REVISION ACCORDING TO
THE ACT AND BUILDING
REGULATIONS 1987 & 1988.

DOOR - WINDOW SCHEDULE							
DOORS				WINDOWS			
DOOR	WIDTH	HEIGHT	MKD	WIDTH	HEIGHT	SILL	LINTEL
D0	1200	2150	W0	1500	1500	650	2150
D1	1100	2150	W1	1100	1700	450	2150
D2	900	2150	W2	600	1700	450	2150
D3	750	2150	W3	900	1050	1100	2150
D4	1000	2150	W4	600	900	1250	2150
SD1	2100	2150	SW	1200	1700	450	2150
FCD	1200	2150	FG	VARIABLE	2000	150	2150
RS	VARIABLE	2150	WF	WALL TO WALL	WINDOW		2150

NOTES :-

1. ALL DIMENSIONS ARE IN MM. UNLESS OTHERWISE MENTIONED.
2. ALL EXTERNAL WALLS ARE 200 THK & INTERNAL WALLS ARE 125 THK. IF NOT STATED IN 1:4 CEMENT SAND MORTAR.
3. ALL HORIZONTAL PROJECTIONS ARE 125 THK & 500 MM. PROJECTED.
4. DEPTH OF SEPTIC TANK & UNDERGROUND WATER RESERVOIR SHOULD NOT EXCEED THE DEPTH OF FOUNDATION.
5. GRADE OF CONCRETE & GRADE OF STEEL USED ARE M30 & M50 & F650 RESPECTIVELY.
6. R.C.C. FRAMED STRUCTURE.
7. ANY DISCREPANCY IN SCALE. THE WRITTEN DIMENSION SHALL GOVERN.
8. FOR SPECIFICATION OF MATERIALS & WORKMANSHIP N.B.C. 2016 TO BE FOLLOWED.
9. OPEN TERRACE WITH LIME TERRACING OF RATIO 2:2:7.
10. DAMP PROOF COURSE TO BE PROVIDED WITH P.C.C. (1:2:4).

PROJECT :

PROPOSED ARCHITECTURAL PLAN FOR COMMERCIAL CUM RESIDENTIAL (APARTMENT) COMPLEX CONSISTING OF SINGLE TOWER HAVING 2 NOS. WING (A&B) OF G+10 STORIED BUILDING (BY THE OF " SHRI KRISHNA KUNJ RESIDENCY) OF SRI DILIP KUMAR BARNWAL & OTHER'S OVER R.S. PLOT NO. - 217, 225, L.R. PLOT NO. - 597,768 L.R. KHATIAN NO. - 5984,5985, 5986,5990, 5991,5992,5993,6006,6008,6009,6010,6105,6106, AT MOUZA- FULJHORE, J.L. NO.-107 (OLD 82), , P.S. - N.T.P.S, A.D.S.R. DURGAPUR, DIST - PASCHIM BARDHAMAN, PIN. NO-713206

SIGNATURE OF OWNER

Certified that I have gone through the building rules of Durgapur municipal/building Corporation 2006 and its amendment & also undertake to abide by those rules during & after the construction of the building.

- | | | | |
|---|---------------------|----|---------------------|
| 1 | Dilip Kumar Barmwal | 17 | Bhakti Bhuan Mondal |
| 2 | Poonam K. B. | 9 | Rita Devi Gupta |
| 3 | Pradyumn Bhowmik | 10 | Kaazi Anwar Hossain |
| 4 | Pradyumn Bhowmik | 11 | Sanjay Kumar Das |
| 5 | Ritika Rani Gupta | 12 | Samghamitra Roy |
| 6 | Dhiraj Mondal | 13 | Dilip Choudhary |
| 7 | Anshu Parrot | | |

SIGNATURE OF ARCHITECT

I/We do hereby certify that plans, elevations and sections and other structural details of the above said building have been prepared in conformity with all relevant provisions under Durgapur municipal (building) Corporation 2006. This also to certify that relevant "No Objection" certificates from the respective Authorities such as Fire and Emergency Services Department, Airport Authority, Pollution Control Board, Telecommunication Department etc as applicable in this regard are also enclosed with the application for seeking approval of the plan to construction/reconstruct/addition to alteration of the building on the said Plot.

Kamal Kumar Perival

KAMAL KUMAR PERIVAL
CA-95-18679

SIGNATURE OF GEOTECHNICAL ENGINEER

Dr. Sujit Kumar Bose
DR. SUJIT KUMAR BOSE
Ph.D., M.C.E. (Soil), B.C.E. (Hons.),
MIGS, MRF
Engineer and Geotechnical
Engineer (I) under KM
License No: GT-12

SIGNATURE OF ARCHITECT / ENGINEER

Sanjib Guha
SANJIB GUHA
STRUCTURAL CONSULTANT
BSC, BCE, FIE, Chartered Engineer
Structural Reviewer (K.M.C.)
Empanelled No. - ESR (I) 88/16
Structural Reviewer (MND)
Empanelled No. - STER/INDIA/15/00003

Chandi Prasad Khanra
CHANDI PRASAD KHANRA
BE (Civil), ME (Struct), MIE (India)
ESE-I/2

TITLE :

FIRST FLOOR PLAN TYPICAL FLOOR PLAN

DRG. NO.	MAHESHWARI/COMMISSION/ARCH-05	REV. NO.	
REV. DATE		DRWG. BY	ADRIKA
SCALE	1:100	CHECKED	BIBEK
DATE	06.07.2020		

ARCHITECT :

MAHESHWARI & ASSOCIATES
37A, BAKER ROAD, 2ND. FLOOR,
Tel : 65334966,
www.architectmaheshwari.com KOLKATA - 74

5

16/10/2020

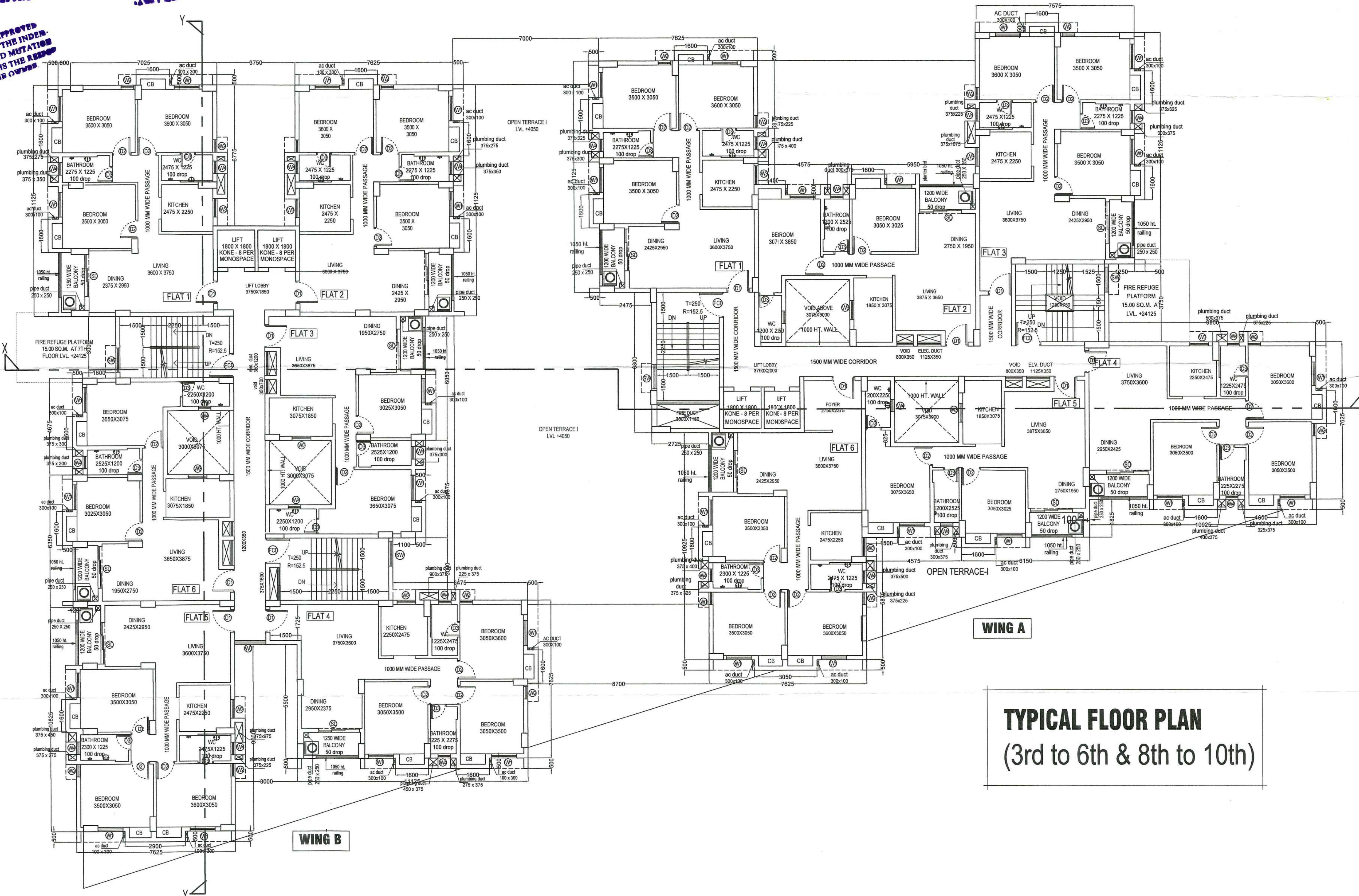

TYPICAL FLOOR PLAN
(3rd to 6th & 8th to 10th)