

LAND OF EAST INDIA PHARMACEUTICAL WORKS LTD.

56418

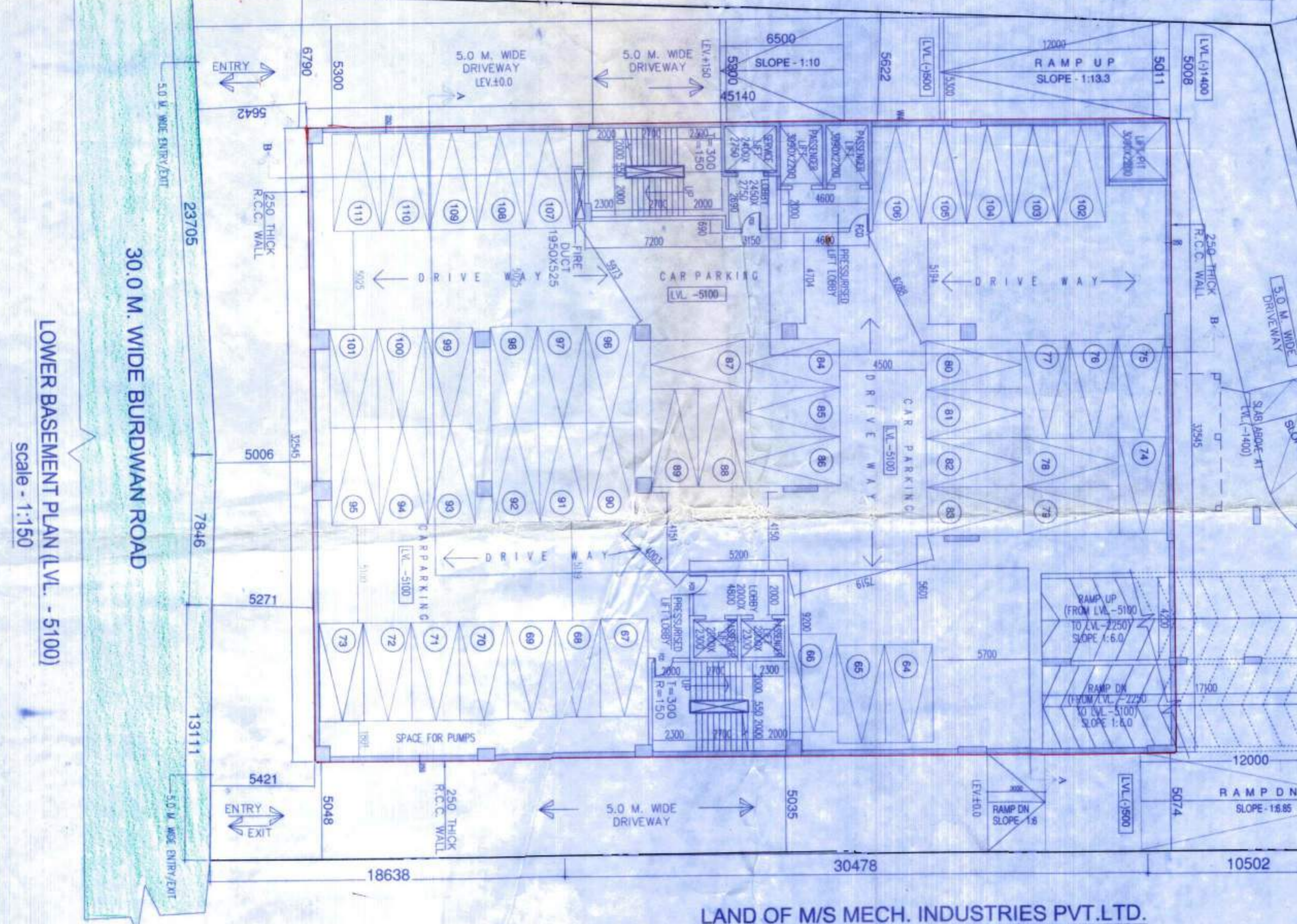

LOWER BASEMENT PLAN (LVL -5/100)
Scale - 1:150

LAND OF M/S MECH. INDUSTRIES PVT.LTD.

LAND OF EAST INDIA PHARMACEUTICAL WORKS LTD.

56418

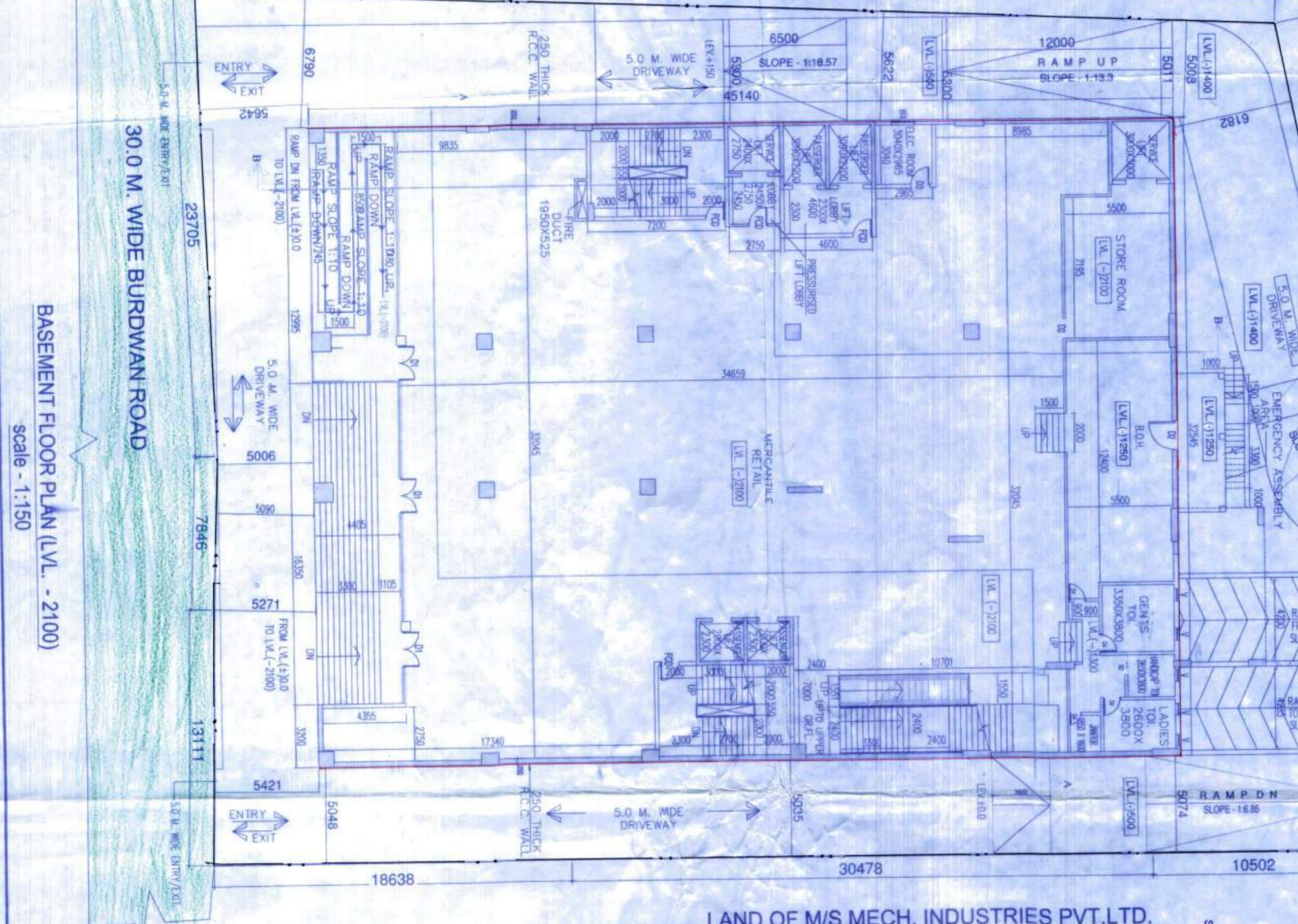

BASEMENT FLOOR PLAN (LVL -2/100)
Scale - 1:150

LAND OF M/S MECH. INDUSTRIES PVT.LTD.

LAND OF EAST INDIA PHARMACEUTICAL WORKS LTD.

56418

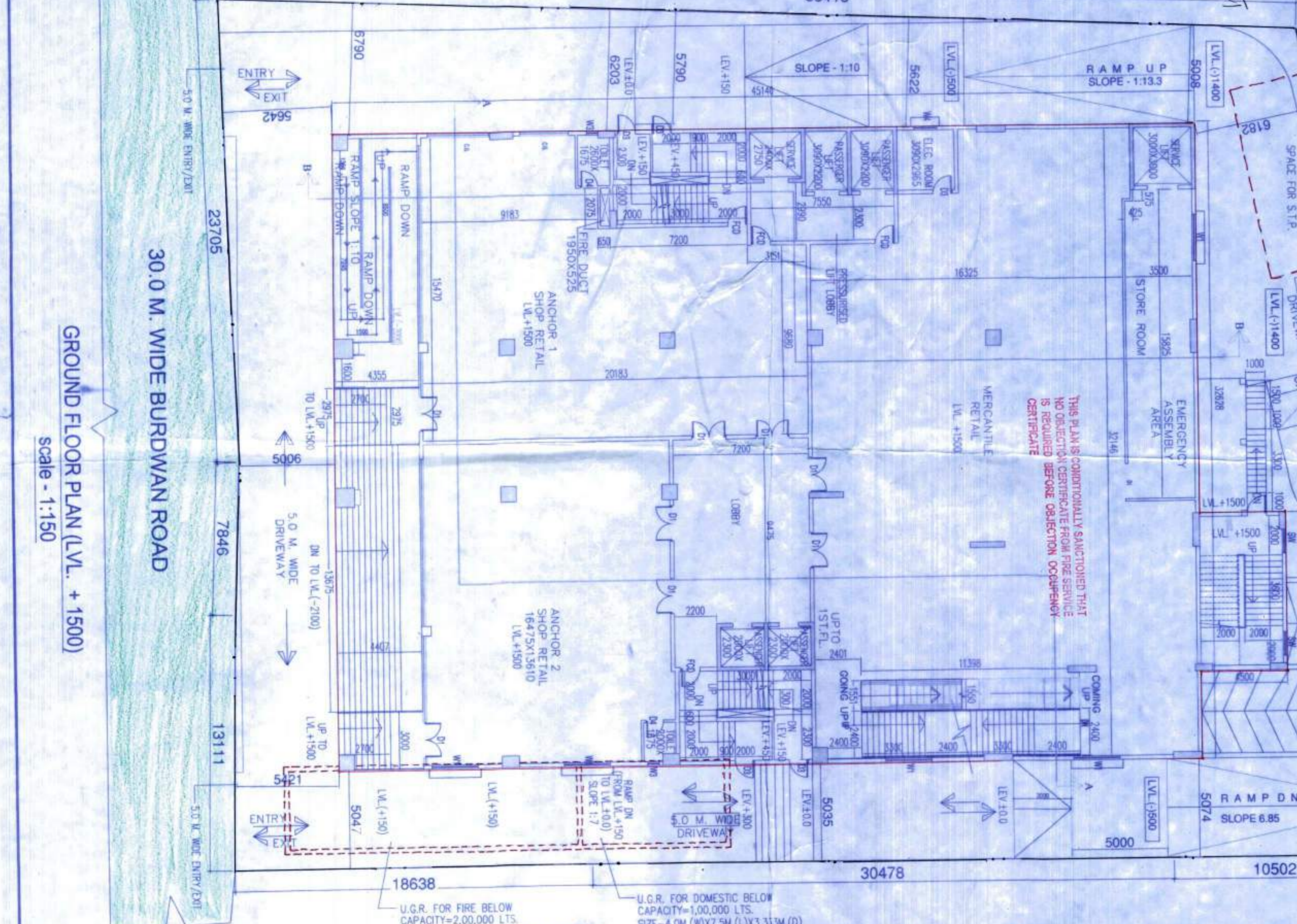

GROUND FLOOR PLAN (LVL +1500)
Scale - 1:150

LAND OF M/S MECH. INDUSTRIES PVT.LTD.

LAND OF PLOT NO.2143

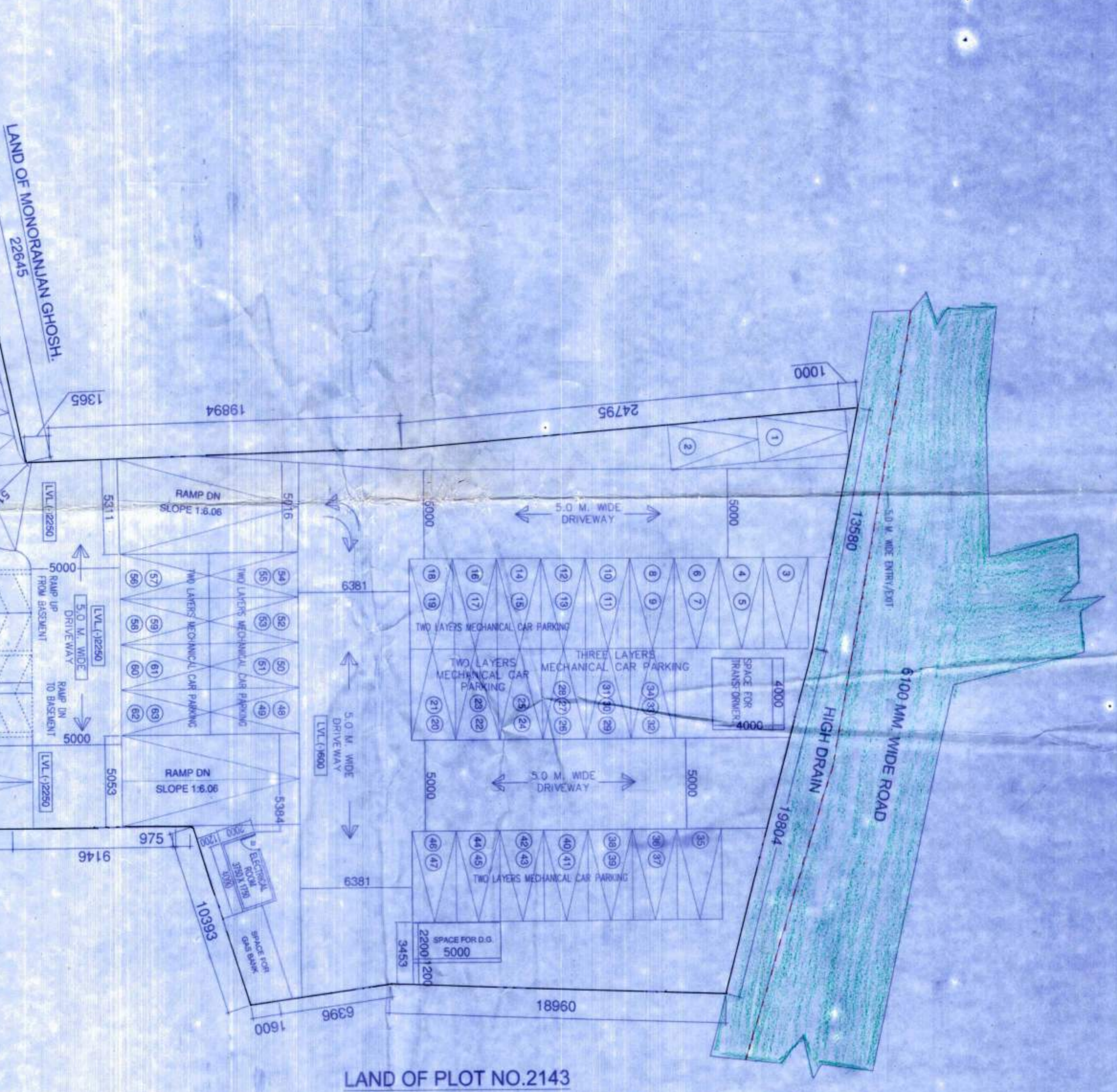

LAND OF PLOT NO.2143



LAND OF PLOT NO.2143



CONTRACTOR TO PREPARE THE PLAN AND WORKING DRAWINGS FOR THE BUILDING CONSTRUCTION WORKS. THE CONTRACTOR SHALL BE RESPONSIBLE FOR THE DESIGN OF FOUNDATION & ROOF SLABING TO BE PROVIDED.

Placed in the Board Meeting held on 21.01.2021

Placed in the Board Meeting held on 21.01.2021

Note: Structural Details shall be followed as per 'Approved' Revised Copy

Valid for Three Years from the date of 21.01.2021 Sanctioned

Not to be sanctioned without the approval of the competent authority.

Structural Engineer's Signature

Stamp of Structural Engineer



PROJECT: LOWER BASEMENT, 1ST FLOOR & 2ND FLOOR COMMERCIAL, C/M ASSEMBLY BUILDING
NAME OF OWNERS: 1. SRI ASHOK AGARWAL, S/O. LATE K.M. ASH CHAND AGARWAL, 2. SRI ANSHU AGARWAL, W/O. SRI NARESH AGARWAL, 3. SRI ANAND AGARWAL, W/O. SRI PRADEEP AGARWAL, 4. SRI VIKAS AGARWAL, S/O. LATE CHANDRANATH SHAI, 5. SRI VIKAS AGARWAL, S/O. LATE CHANDRANATH SHAI
LOCATION: BURDWAN ROAD, SILIGURI

GENERAL NOTES:
1. ALL DIMENSIONS ARE IN MILLIMETERS
2. ALL WALL THICKNESSES ARE TO BE FOLLOWED
3. ALL EXTERNAL WALL ARE 200MM THICK AND INTERNAL WALL ARE 125MM THICK UNLESS OTHERWISE NOTED
4. THE ENTIRE BUILDING IS ARTISANAL & MECHANICALLY VENTILATED
5. THE BUILDING IS TO BE USED FOR FLOORING
6. THE BUILDING IS TO BE USED FOR FLOORING

AREA STATEMENT
1. AREA OF LAND (AS PER SITE) :- 2774.888 sq.m
2. AREA OF LAND (AS PER SITE) :- 2774.888 sq.m
3. PROPOSED GROUND COVERAGE :- 146.81%
4. LOWER BASEMENT FLOOR AREA (TOTAL) :- 146.81%
5. 1ST FLOOR AREA (MERCANTILE RETAIL) :- 146.81%
6. 2ND FLOOR AREA (MERCANTILE RETAIL) :- 146.81%
7. TOTAL FLOOR AREA :- 146.81%
8. TOTAL FLOOR AREA (ASSEMBLY) :- 146.81%
9. TOTAL FLOOR AREA :- 146.81%
10. PROPOSED P.A.L. :- 146.81%
11. PROPOSED P.A.L. :- 146.81%
12. PROPOSED P.A.L. :- 146.81%
13. PROPOSED P.A.L. :- 146.81%
14. PROPOSED P.A.L. :- 146.81%
15. PROPOSED P.A.L. :- 146.81%
16. PROPOSED P.A.L. :- 146.81%
17. PROPOSED P.A.L. :- 146.81%
18. PROPOSED P.A.L. :- 146.81%
19. PROPOSED P.A.L. :- 146.81%
20. PROPOSED P.A.L. :- 146.81%

DECLARATION OF OWNER
I, the undersigned, do hereby declare that the building proposed for construction shall be supervised by the S.A. / S.O. of the Government of West Bengal, Siliguri. I, the undersigned, do hereby declare that the building proposed for construction shall be supervised by the S.A. / S.O. of the Government of West Bengal, Siliguri. I, the undersigned, do hereby declare that the building proposed for construction shall be supervised by the S.A. / S.O. of the Government of West Bengal, Siliguri.

CERTIFICATE OF BUILDING PLAN
I do hereby certify that the plans, sections and other structural details of the proposed building are in conformity with the provisions of the Building Regulation, 2007. I do hereby certify that the building proposed for construction shall be supervised by the S.A. / S.O. of the Government of West Bengal, Siliguri. I, the undersigned, do hereby declare that the building proposed for construction shall be supervised by the S.A. / S.O. of the Government of West Bengal, Siliguri.

CERTIFICATE OF STRUCTURE STABILITY
I do hereby certify that the foundation and superstructure of the proposed building are in conformity with the provisions of the Building Regulation, 2007. I do hereby certify that the building proposed for construction shall be supervised by the S.A. / S.O. of the Government of West Bengal, Siliguri. I, the undersigned, do hereby declare that the building proposed for construction shall be supervised by the S.A. / S.O. of the Government of West Bengal, Siliguri.

ARCHITECT: MASS & VOID ARCHITECTS/INTERIORS
RESIDENT ARCHITECT: GREEN ARCHITECTURE CONSULTING ENGINEERS PVT. LTD.
1ST FLOOR, B.R. AGARWAL COMPLEX, SILLIGURI - 734003
SCALE VARIES: DRAWN BY: RAJAN, CHECKED BY: MITUL SHUKLA, DATE: 29.05.2019