

PROJECT: PROPOSED GROUND + 5 STORIED RESIDENTIAL CUM COMMERCIAL BUILDING.

NAME OF OWNERS: 1) SRI SURESH KUMAR AGARWAL
2) M/S SHREE SHYAM CONSTRUCTIONS
REPRESENTED BY SRI SANJAY KUMAR SINGHANIA

LOCATION: SHYAM MANDIR ROAD, SILIGURI.

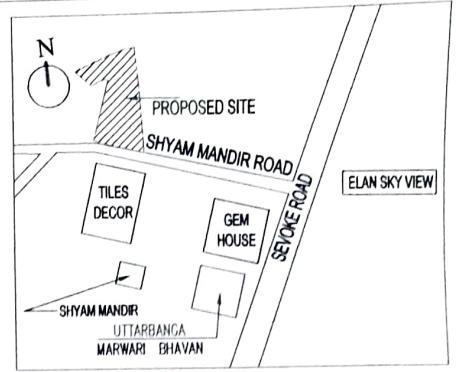

KEY PLAN
NOT TO SCALE

LAND SCHEDULE

MOUZA:- DABGRAM
J.L. NO. :- 02
SHEET NO. :- 8(R.S), 22(L.R),
R.S. PLOT NO.- 305,306,307, 308/1103
L.R. PLOT NO.- 95
R.S. KHATIAN NO.- 576, 578, 559
HOLDING NO. - 44 / 32 / 1 / 2 , 44 / 32 / 1 / 3
WARD NO. :- 43 UNDER S.M.C.
P.S. :- BHAKTINAGAR.
PARGANA:- BAIKUNTHAPUR,
DIST. :- JALPAIGURI.

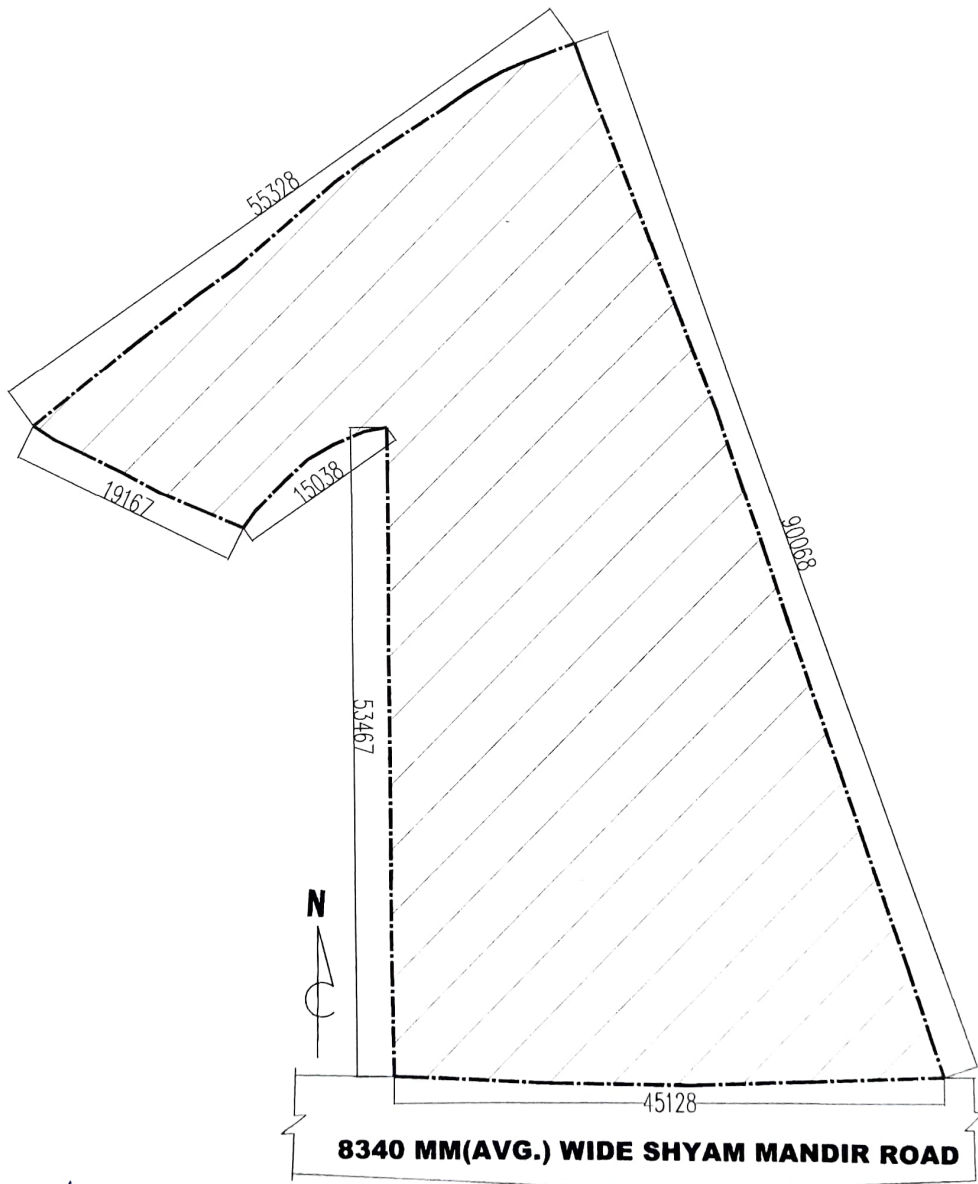

SITE PLAN

SCALE - 1:400

LONGITUDE - 88°26'05.90" E

LATITUDE - 26°44'34.25" N

MITUL SHUKLA (B. Arch.)
CA/2004/33251