

CONDITIONALLY APPROVE THE PLAN AND NOTICE
 REGARDING RESERVATION OF RIGHTS IN A
 CATEGORY OF TRANSPORT & WORK INFRASTRUCTURE
 BUILDING CONSTRUCTION

PLANES OF SERVICE LINE WITH
 MILE IN 300/500/1000

06-01-21

NOTE: Structural Service shall be
 provided as per approved
 structure plan



Valid for Three Years
 From the Date of
 Sanctioned 06-01-21

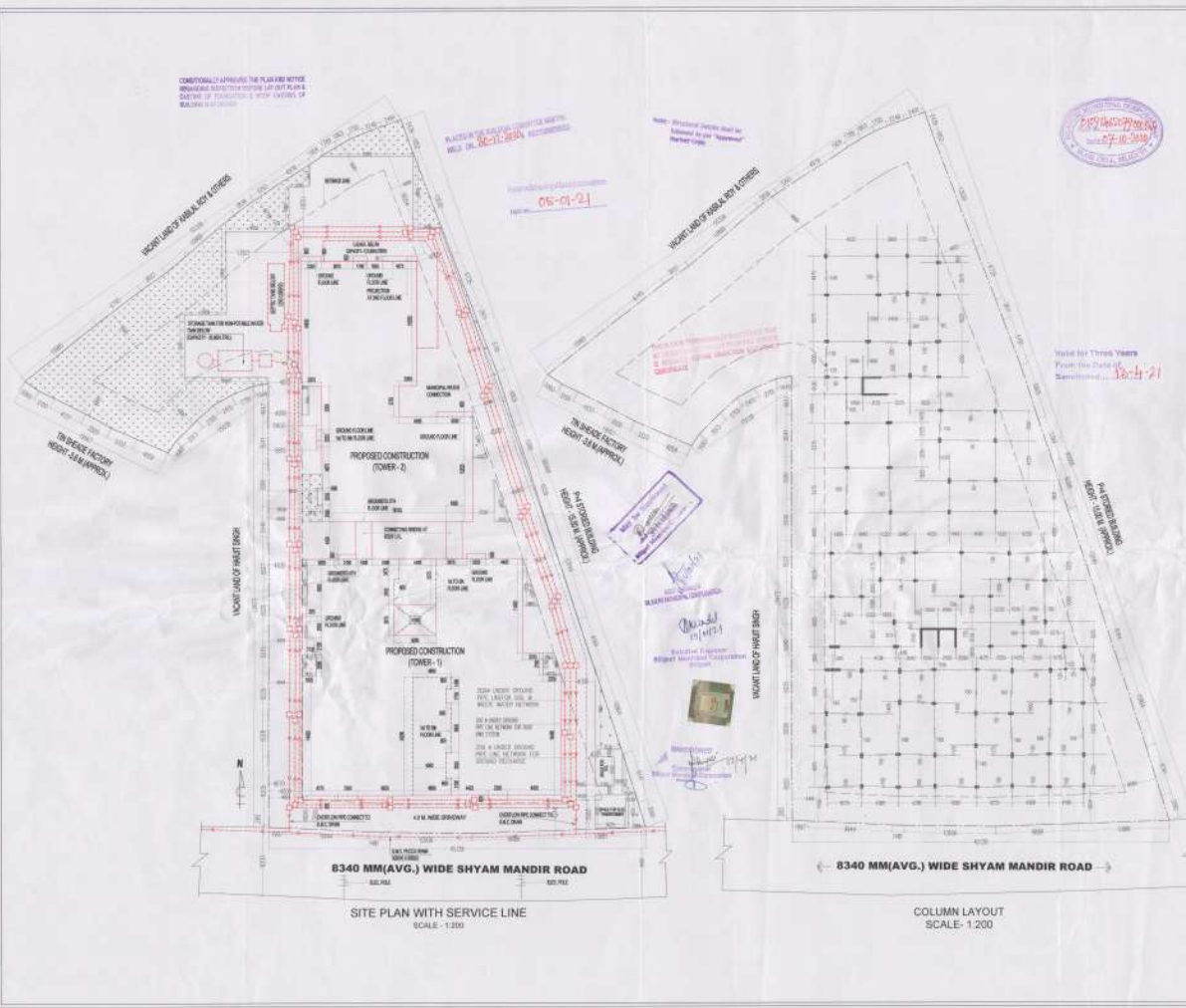

SITE PLAN WITH SERVICE LINE
 SCALE - 1:200

COLUMN LAYOUT
 SCALE - 1:200

PROJECT:
**PROPOSED GROUND + 5 STORED
 RESIDENTIAL CUM COMMERCIAL BUILDING.**

OWNER'S DETAIL:
 1. SRI SURESH KUMAR ADAPPA
 2. SRI SHREE SHYAM CONSTRUCTIONS
 REPRESENTED BY SRI SANJAY KUMAR SINGHARIA

LOCATION:
 SHYAM MANDIR ROAD, BHUBANESWAR

SCHEDULE OF LAND:
 MCD No. 108
 BLOCK - 108/1/2/3/4
 P.L. NO. 108/1/2/3/4
 A.S. NO. 108/1/2/3/4
 MCD - 108/1/2/3/4
 P.L. - 108/1/2/3/4
 P.S. - 108/1/2/3/4
 P.O. - 108/1/2/3/4

GENERAL NOTES:

1. TO BE BUILT ON 8.00 M² AREA
2. TO BE BUILT ON 8.00 M² AREA
3. TO BE BUILT ON 8.00 M² AREA
4. TO BE BUILT ON 8.00 M² AREA
5. TO BE BUILT ON 8.00 M² AREA
6. TO BE BUILT ON 8.00 M² AREA
7. TO BE BUILT ON 8.00 M² AREA
8. TO BE BUILT ON 8.00 M² AREA
9. TO BE BUILT ON 8.00 M² AREA
10. TO BE BUILT ON 8.00 M² AREA

COORDINATE OF BUILDING PLAN

APPROVALS:

SIGNATURE OF ARCHITECT:
 PETA SHEKHA
 ARCHITECT

SIGNATURE OF STRUCTURAL ENGRG.:
 PETA SHEKHA
 STRUCTURAL ENGINEER

SIGNATURE OF GEO TECH.:
 PETA SHEKHA
 GEO TECHNICAL ENGINEER

DELEGATION OF DUTIES:

SHEET NO. 06/06

SCALE 1:100 DRAWN BY: BAHAN

CHECKED BY: PETA SHEKHA

DATE: 01.01.2020

ARCHITECT: MASS & VOID ARCHITECTS/INTERIORS
 48, 4th Floor, Bhubaneswar, Odisha
 751 002, India
 P: +91 674 258 1184
 E: massvoid@gmail.com
 www.massvoid.com